

F&P FILE	SECTION	COUNTY	TOTAL SHEETS	SHEET NO
	94-F3000-06-ET	COOK	105	94
STA.	TO STA.			
FED. ROAD DIST. NO.	ILLINOIS	83709	STPE-D001(479)	

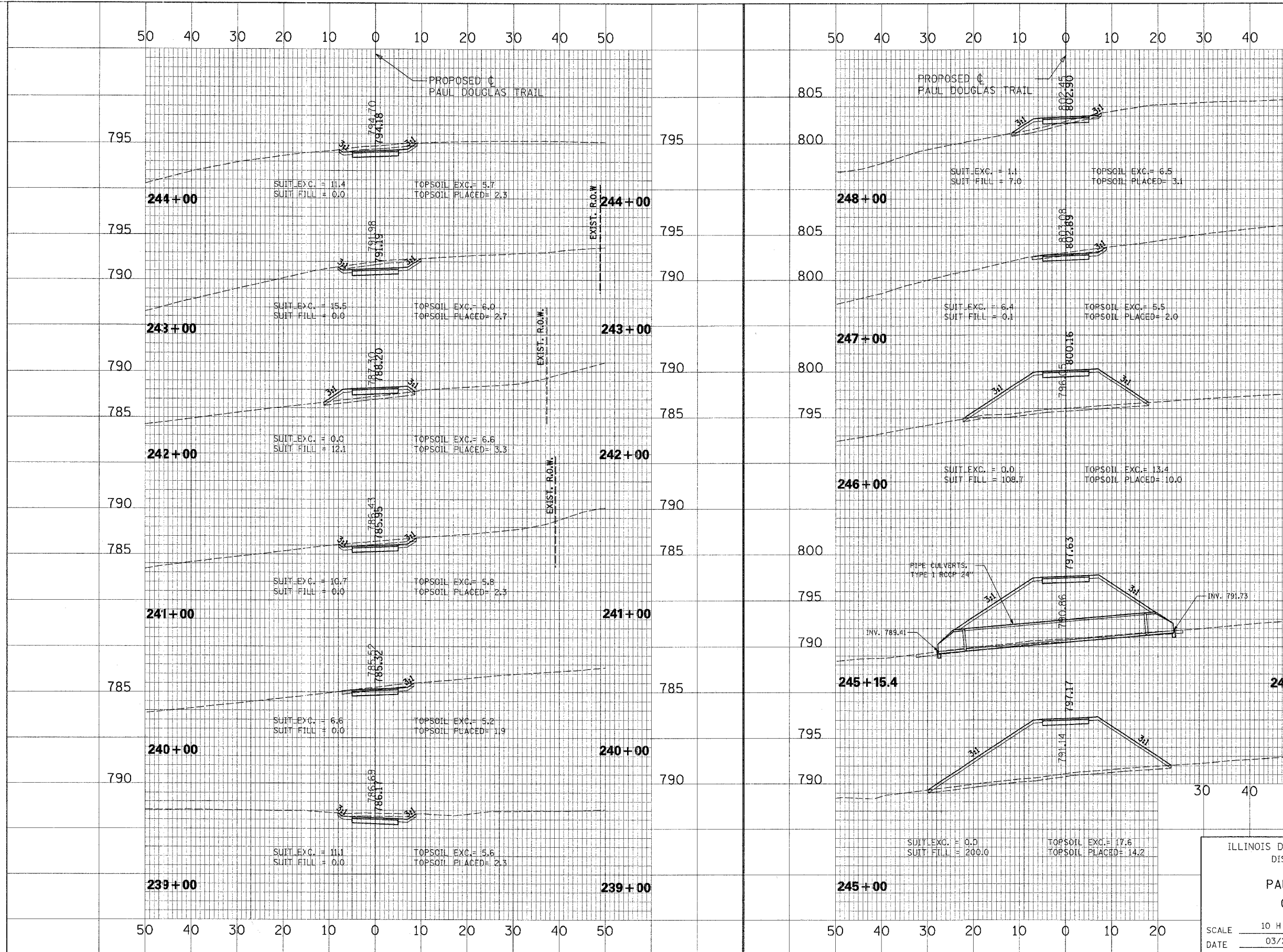

CROSS SECTION NO. _____
 DATE _____
 BY _____
 CHECKED _____
 ALL DIMENSIONS IN FEET AND INCHES
 UNLESS OTHERWISE SPECIFIED

CROSS SECTION NO. _____
 DATE _____
 BY _____
 CHECKED _____
 ALL DIMENSIONS IN FEET AND INCHES
 UNLESS OTHERWISE SPECIFIED

ILLINOIS DEPARTMENT OF TRANSPORTATION
 DISTRICT NO. 1 SCHAUMBURG

**PAUL DOUGLAS TRAIL
 CROSS SECTIONS**

SCALE 10 H : 5 V
 DATE 03/29/06

DRAWN BY RTA
 CHECKED BY SMH