

PLAN	SECTION	COUNTY	TOTAL SHEETS
1389	99-00062-00-PV	DUPAGE	199
CONTRACT NO. 83873			21
FED. ROAD DIST. NO. ILLINOIS FED. AID PROJECT			

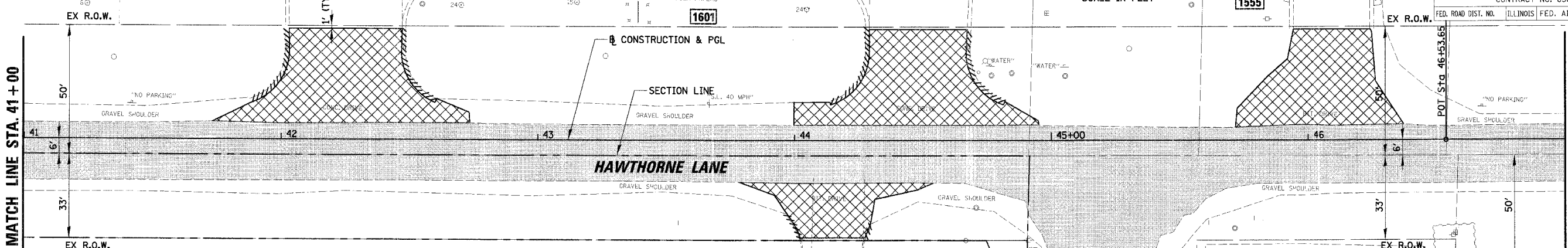

- EXISTING LEGEND**
- PAVEMENT REMOVAL (HOT-MIX ASPHALT)
 - HOT-MIX ASPHALT SURFACE REMOVAL, 2 3/4"
 - CURB AND GUTTER OR CURB REMOVAL
 - FENCE REMOVAL
 - DRIVEWAY REMOVAL
 - SIDEWALK REMOVAL
 - TREE REMOVAL (OF SIZE SHOWN)
 - TEMPORARY FENCE

EXISTING CONDITIONS

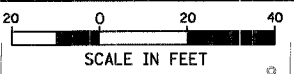
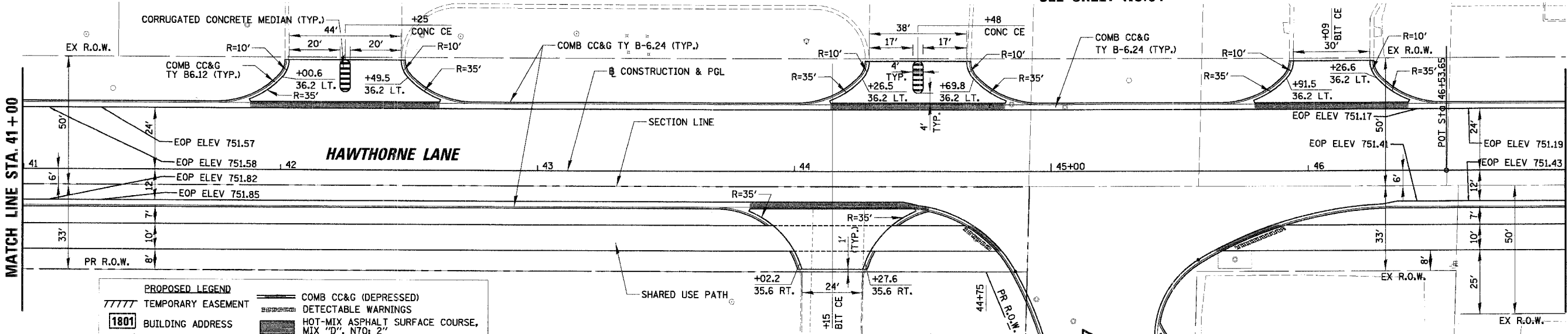

- PROPOSED LEGEND**
- TEMPORARY EASEMENT
 - BUILDING ADDRESS
 - TYPE A RAMP
 - COMB CC&G (DEPRESSED)
 - DETECTABLE WARNINGS
 - HOT-MIX ASPHALT SURFACE COURSE, MIX "D", NTO, 2" LEVELING BINDER (MACHINE METHOD), N50, 3/4"

PROPOSED CONDITIONS

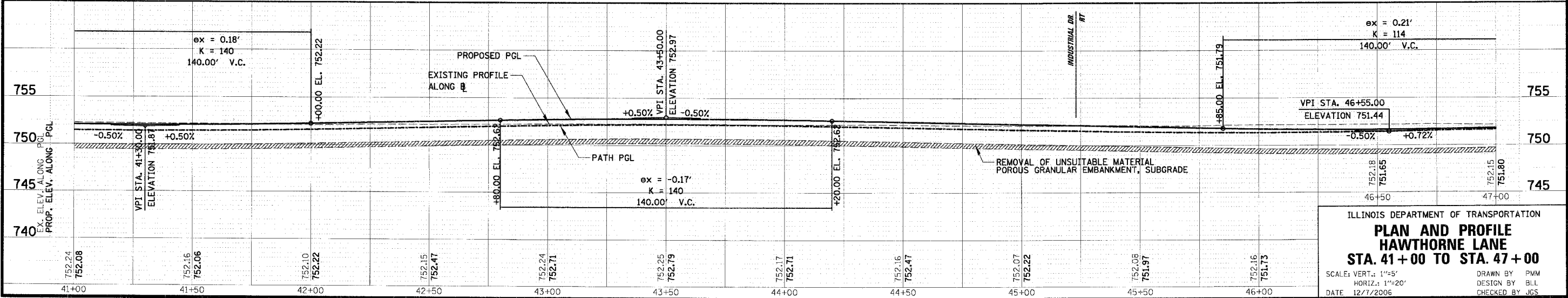

ILLINOIS DEPARTMENT OF TRANSPORTATION

**PLAN AND PROFILE
HAWTHORNE LANE
STA. 41+00 TO STA. 47+00**

SCALE: VERT.: 1"=5'
HORIZ.: 1"=20'

DATE: 12/7/2006

DRAWN BY: PMM
DESIGN BY: BLL
CHECKED BY: JGS

DATE	BY

DATE	BY

N:\WestCh\N04479\Civil\04479_04.rpp