

P.A.U. RTE.	SECTION	COUNTY	TOTAL SHEETS	SHEET NO.
1389	99-00062-00-PV	DUPAGE	199	35
CONTRACT NO. 63873				
FED. ROAD DIST. NO. ILLINOIS FED. AID PROJECT				

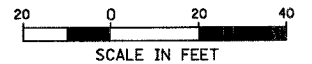

**EXISTING LEGEND**

	PAVEMENT REMOVAL (HOT-MIX ASPHALT)		DRIVEWAY REMOVAL
	HOT-MIX ASPHALT SURFACE REMOVAL, 2 3/4"		SIDEWALK REMOVAL
	CURB AND GUTTER OR CURB REMOVAL		TREE REMOVAL (OF SIZE SHOWN)
	FENCE REMOVAL		TEMPORARY FENCE

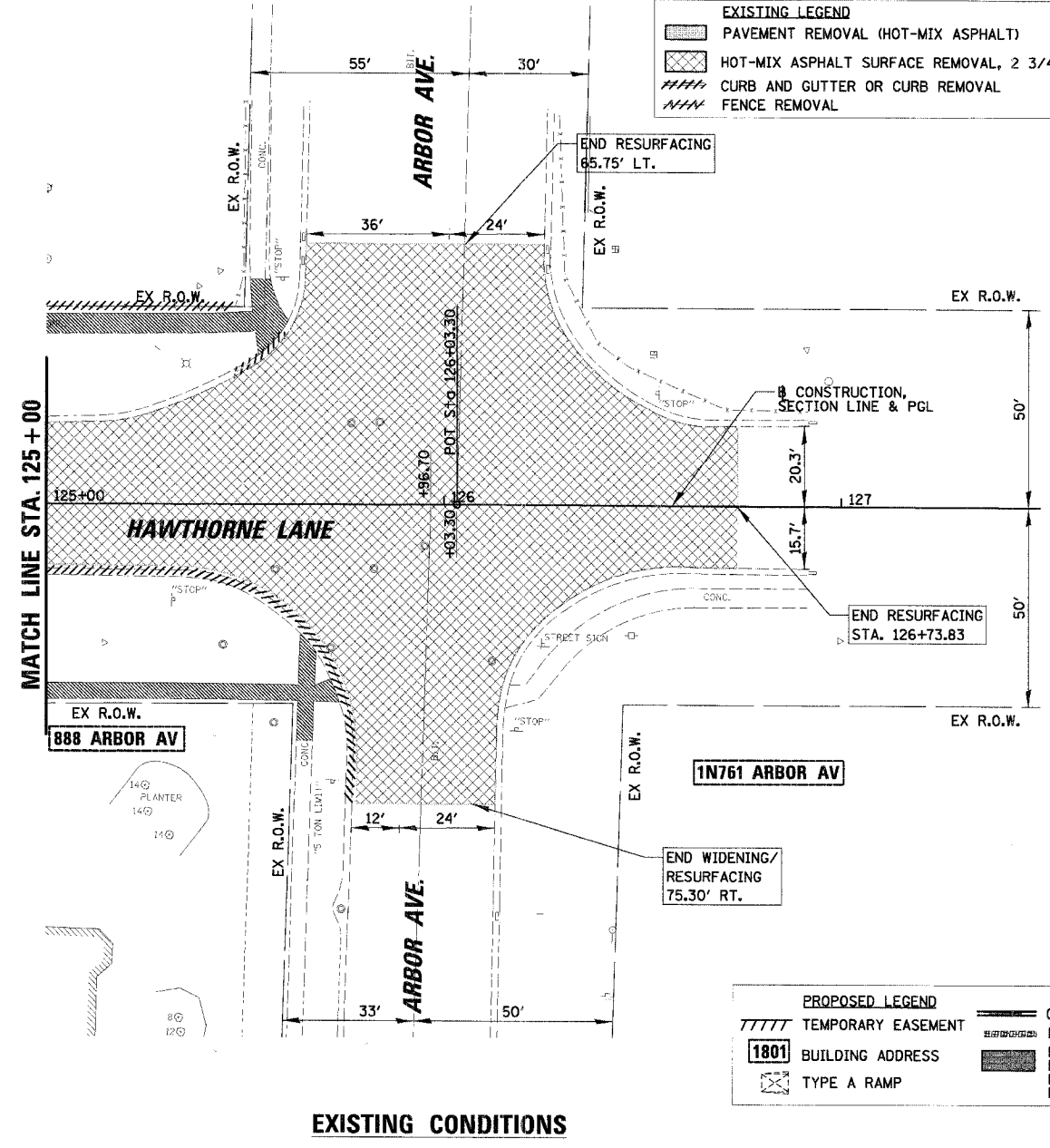

**EXISTING CONDITIONS**

**PROPOSED LEGEND**

	TEMPORARY EASEMENT		COMB CC&G (DEPRESSED) DETECTABLE WARNINGS
	BUILDING ADDRESS		HOT-MIX ASPHALT SURFACE COURSE, MIX "D", N70; 2" LEVELING BINDER (MACHINE METHOD), N50; 3/4"
	TYPE A RAMP		

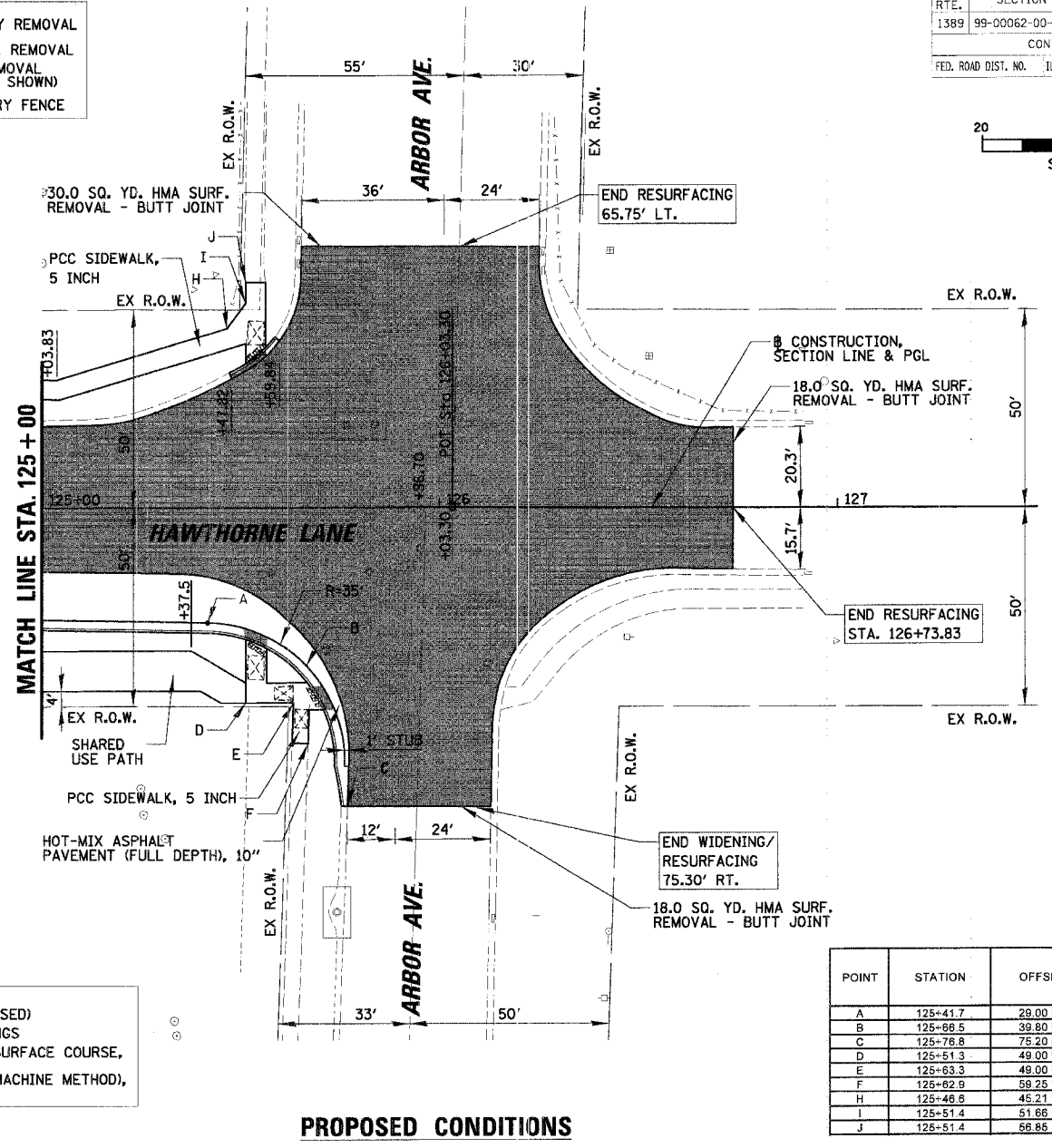

**PROPOSED CONDITIONS**

POINT	STATION	OFFSET	PROP. ELEV.	DESC
A	125+41.7	29.00 FT	767.13	P.C.
B	125+66.5	39.60 FT	766.49	P.O.C.
C	125+76.8	75.20 FT	766.30	P.T.E.P.
D	125+51.3	49.00 FT		SW
E	125+63.3	49.00 FT		SW
F	125+62.9	58.25 FT		SW
H	125+46.6	45.21 FT		SW
I	125+51.4	51.66 FT		SW
J	125+51.4	56.86 FT	766.84	SW

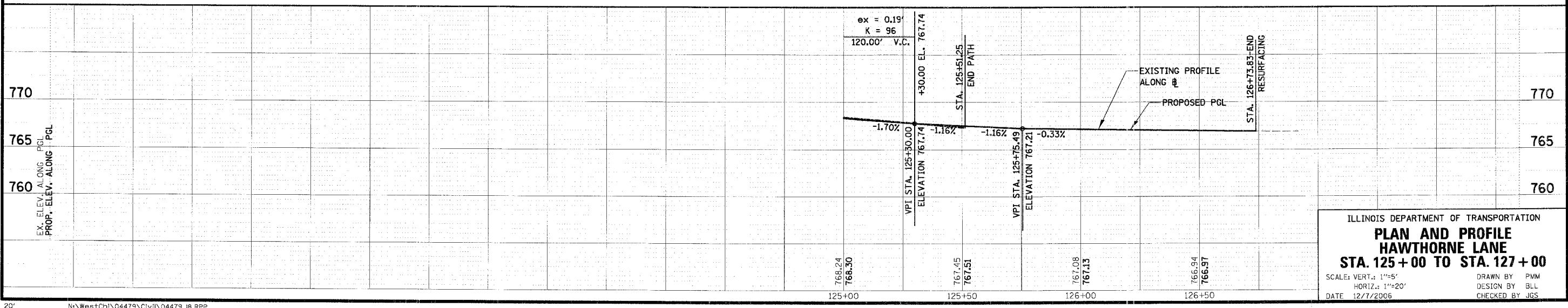

ILLINOIS DEPARTMENT OF TRANSPORTATION  
**PLAN AND PROFILE**  
**STATION 125+00 TO STA. 127+00**  
 SCALE: VERT.: 1"=5'  
 HORIZ.: 1"=20'  
 DATE 12/7/2006  
 DRAWN BY PVM  
 DESIGN BY BLL  
 CHECKED BY JGS

PLAN SURVEYED BY: [blank]  
 NOTE BOOK NO.: [blank]  
 DATE: [blank]

PROF. ILL. SURVEYED BY: [blank]  
 NOTE BOOK NO.: [blank]  
 DATE: [blank]