

F.A.D. NO.	SECTION	COUNTY	TOTAL SHEETS	SHEET NO.
1389	99-00062-00-PV	DUPAGE	199	52
CONTRACT NO. 83873				
FED. ROAD DIST. NO. ILLINOIS FED. AID PROJECT				

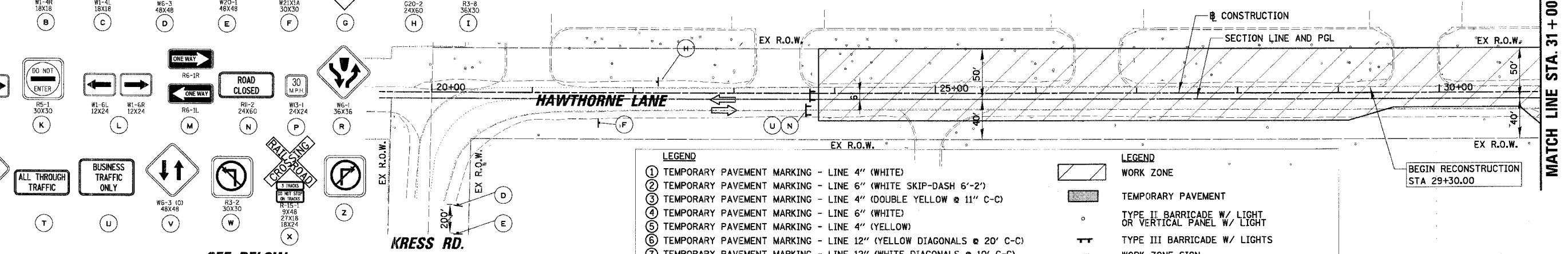

- LEGEND**
- TEMPORARY PAVEMENT MARKING - LINE 4" (WHITE)
 - TEMPORARY PAVEMENT MARKING - LINE 6" (WHITE SKIP-DASH 6'-2')
 - TEMPORARY PAVEMENT MARKING - LINE 4" (DOUBLE YELLOW @ 11" C-C)
 - TEMPORARY PAVEMENT MARKING - LINE 6" (WHITE)
 - TEMPORARY PAVEMENT MARKING - LINE 4" (YELLOW)
 - TEMPORARY PAVEMENT MARKING - LINE 12" (YELLOW DIAGONALS @ 20' C-C)
 - TEMPORARY PAVEMENT MARKING - LINE 12" (WHITE DIAGONALS @ 10' C-C)
 - TEMPORARY PAVEMENT MARKING - LINE 24" (WHITE)
 - TEMPORARY PAVEMENT MARKING - LETTERS AND SYMBOLS (WHITE)
- LEGEND**
- WORK ZONE
 - TEMPORARY PAVEMENT
 - TYPE II BARRICADE W/ LIGHT OR VERTICAL PANEL W/ LIGHT
 - TYPE III BARRICADE W/ LIGHTS
 - WORK ZONE SIGN
 - TRAFFIC FLOW

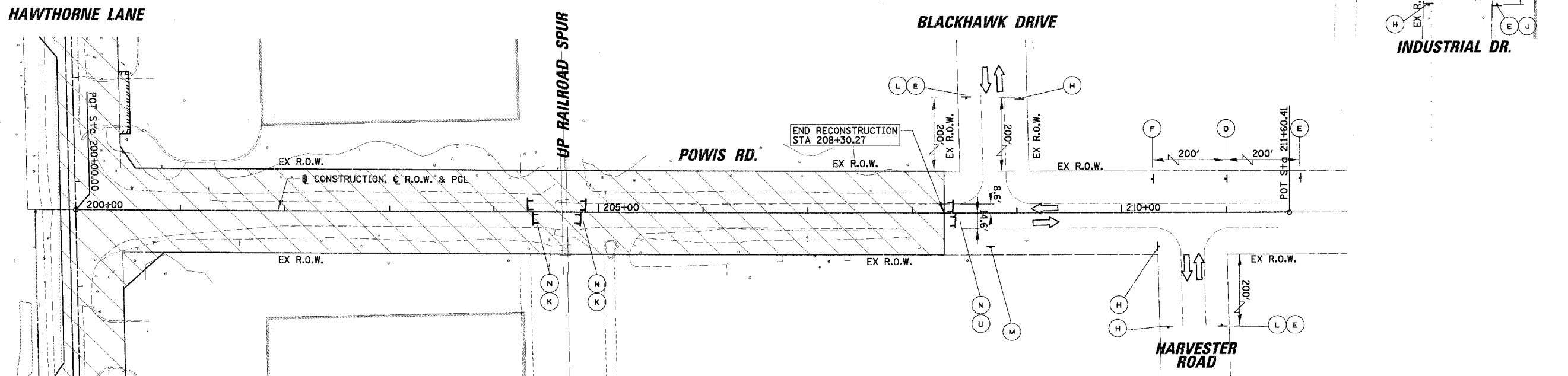
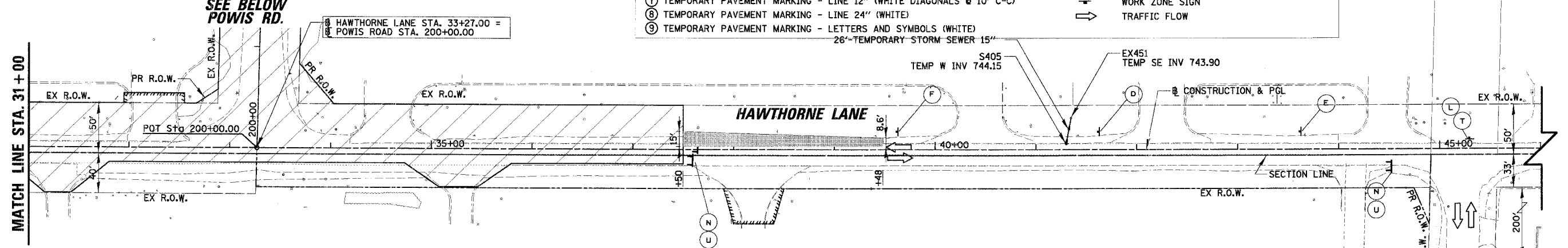

REVISIONS	NAME	DATE

ILLINOIS DEPARTMENT OF TRANSPORTATION
MAINTENANCE OF TRAFFIC - STAGE 1
HAWTHORNE LANE STA. 19+40 TO STA. 46+00
POWIS ROAD

SCALE: 50'
 DATE: 12/7/2006

DRAWN BY: PMM
 DESIGN BY: BLL
 CHECKED BY: JGS

M:\westchl\04479\04479.tbl