

| | | | | |
|-----------------------------------------------|----------------|--------|--------------|-----------|
| F.A.U. RTE. | SECTION | COUNTY | TOTAL SHEETS | SHEET NO. |
| 1389 | 99-00062-00-PV | DUPAGE | 199 | 58 |
| CONTRACT NO. 83873 | | | | |
| FED. ROAD DIST. NO. ILLINOIS FED. AID PROJECT | | | | |

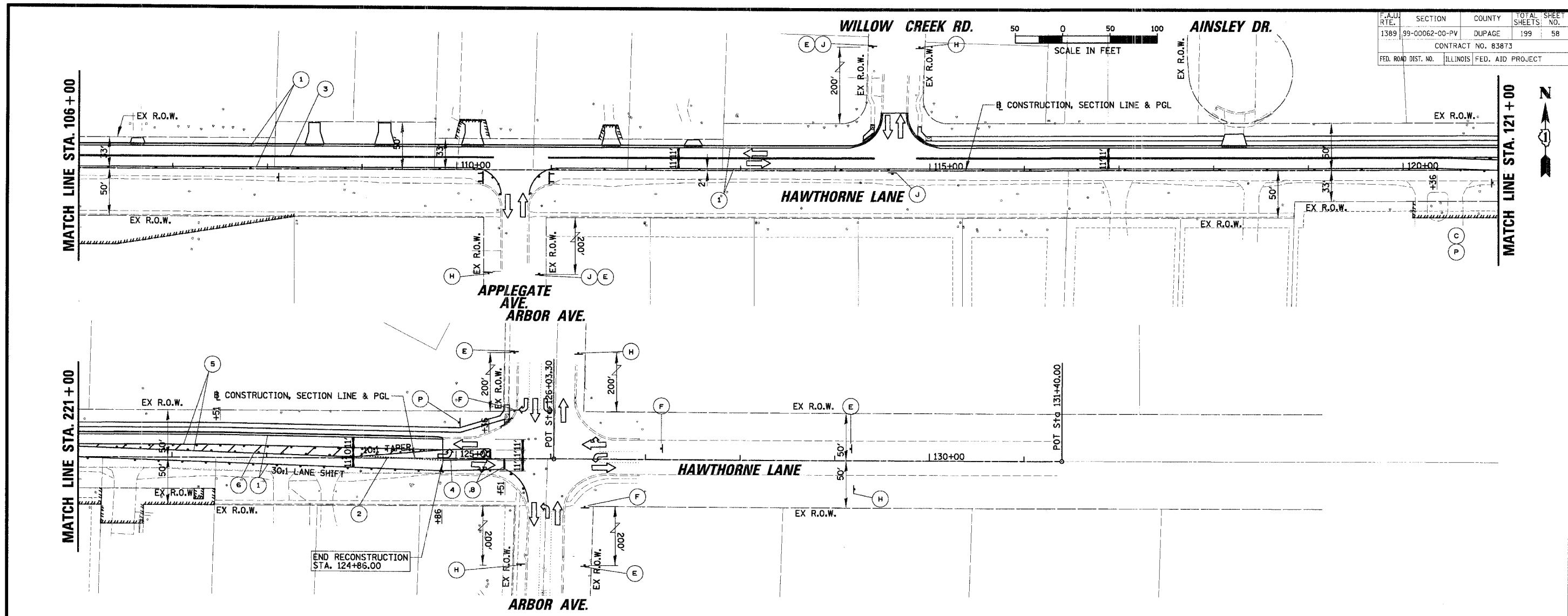

SIGN LEGEND

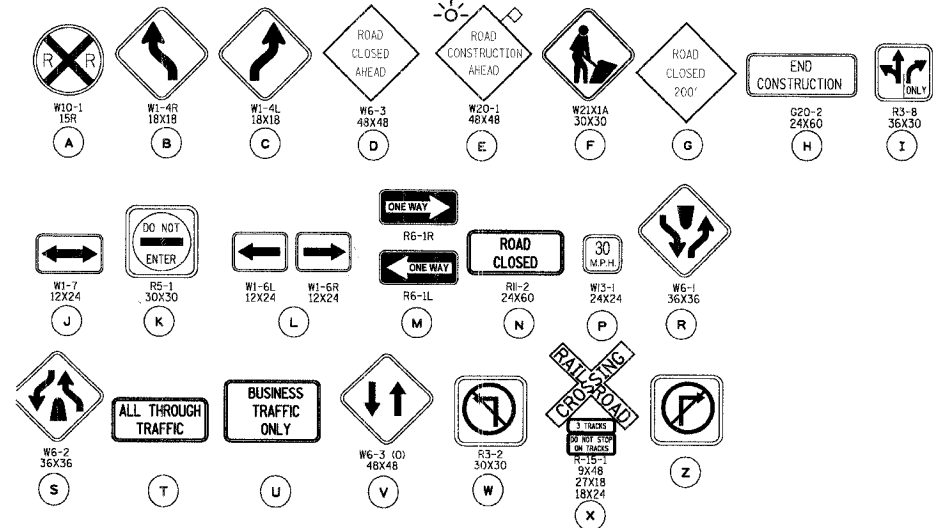

LEGEND

- ① TEMPORARY PAVEMENT MARKING - LINE 4" (WHITE)
- ② TEMPORARY PAVEMENT MARKING - LINE 6" (WHITE SKIP-DASH 6'-2')
- ③ TEMPORARY PAVEMENT MARKING - LINE 4" (DOUBLE YELLOW @ 11" C-C)
- ④ TEMPORARY PAVEMENT MARKING - LINE 6" (WHITE)
- ⑤ TEMPORARY PAVEMENT MARKING - LINE 4" (YELLOW)
- ⑥ TEMPORARY PAVEMENT MARKING - LINE 12" (YELLOW DIAGONALS @ 20' C-C)
- ⑦ TEMPORARY PAVEMENT MARKING - LINE 12" (WHITE DIAGONALS @ 10' C-C)
- ⑧ TEMPORARY PAVEMENT MARKING - LINE 24" (WHITE)
- ⑨ TEMPORARY PAVEMENT MARKING - LETTERS AND SYMBOLS (WHITE)

LEGEND

- WORK ZONE
- TEMPORARY PAVEMENT
- TYPE II BARRICADE W/ LIGHT OR VERTICAL PANEL W/ LIGHT
- TYPE III BARRICADE W/ LIGHTS
- WORK ZONE SIGN
- TRAFFIC FLOW

| REVISIONS | |
|-----------|------|
| NAME | DATE |
| | |
| | |
| | |

ILLINOIS DEPARTMENT OF TRANSPORTATION
MAINTENANCE OF TRAFFIC - STAGE 3
HAWTHORNE LANE
STA. 106+00 TO STA. 131+00
 SCALE: 50'
 DATE: 1/5/2007
 DRAWN BY: PMM
 DESIGN BY: BLL
 CHECKED BY: JCS

N:\westchl\04479\04479.tbl