

F.A.U. RTE.	SECTION	COUNTY	TOTAL SHEETS
1389	99-00062-00-PV	DUPAGE	199
CONTRACT NO. 83873			SHEET NO. 65
FED. ROAD DIST. NO. ILLINOIS FED. AID PROJECT			

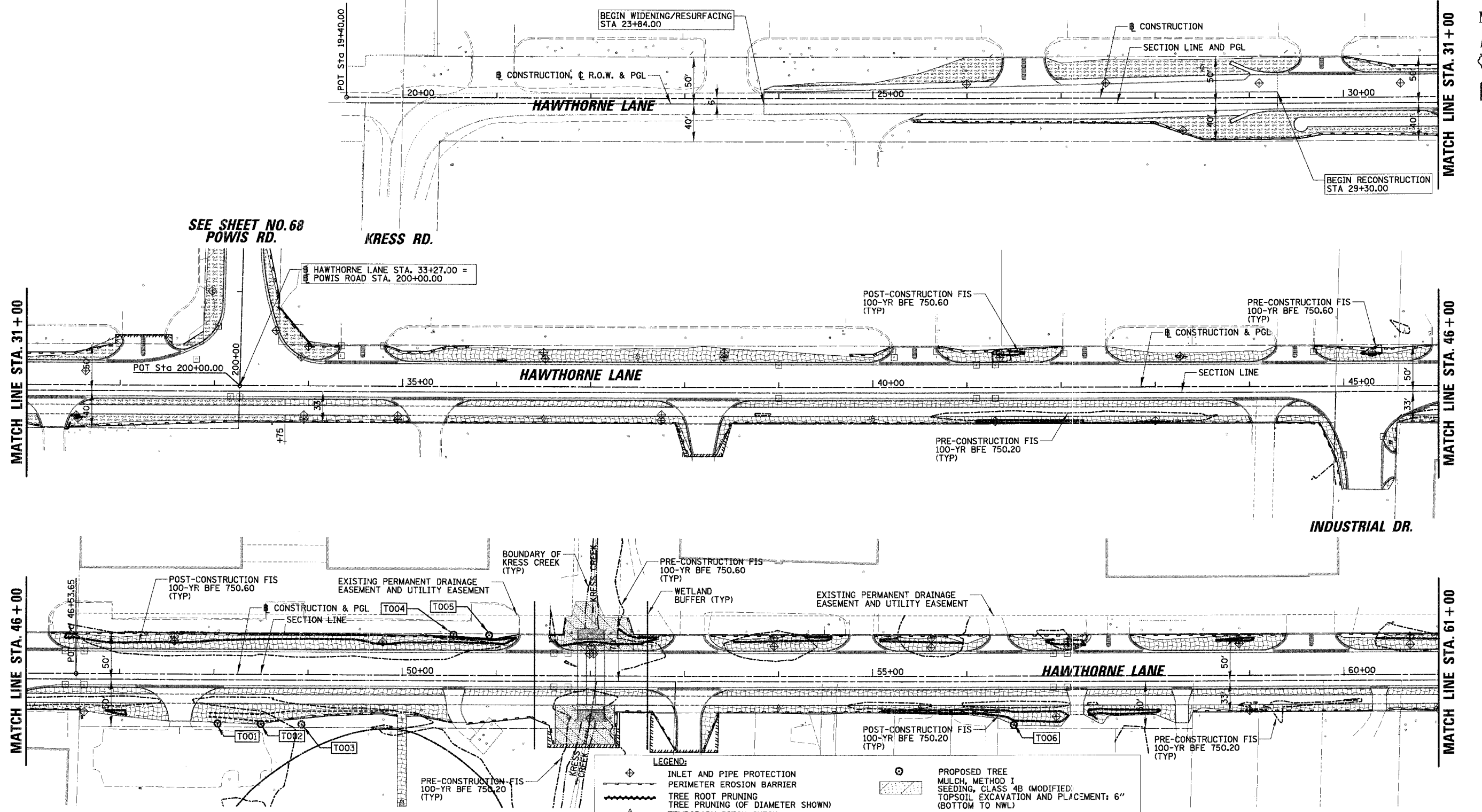

SEE SHEET NO. 68  
POWIS RD.

NOTE: SEE SHEET 67 FOR GENERAL NOTES AND DETAILS  
SEE SHEET 68 FOR TREE SCHEDULE

LEGEND:	
	INLET AND PIPE PROTECTION
	PERIMETER EROSION BARRIER
	TREE ROOT PRUNING
	TREE PRUNING (OF DIAMETER SHOWN)
	TEMPORARY DITCH CHECK
	INLET FILTER
	RIP-RAP
	EROSION CONTROL BLANKET SEEDING, CLASS 1A
	FERTILIZER NUTRIENTS
	MULCH, METHOD 1
	SEEDING, CLASS 4A (MODIFIED)
	FURNISHING AND PLACING TOPSOIL, 4"
	PROPOSED TREE
	MULCH, METHOD 1
	SEEDING, CLASS 4B (MODIFIED)
	TOPSOIL EXCAVATION AND PLACEMENT: 6" (BOTTOM TO NWL)
	EROSION CONTROL BLANKET SEEDING, WET PRAIRIE
	TOPSOIL EXCAVATION AND PLACEMENT: 6" (NWL TO HWL)
	EROSION CONTROL BLANKET SEEDING, MESIC PRAIRIE
	TOPSOIL EXCAVATION AND PLACEMENT: 6" (ABOVE HWL)
	MULCH, METHOD 2
	SEEDING, CLASS 1A
	FERTILIZER NUTRIENTS
	FURNISHING AND PLACING TOPSOIL, 4"

REVISIONS	
NAME	DATE

ILLINOIS DEPARTMENT OF TRANSPORTATION  
**EROSION CONTROL & LANDSCAPING PLAN**  
**HAWTHORNE LANE**  
**STA. 19+40 TO STA. 61+00**  
SCALE: 50'  
DATE: 12/7/2006  
DRAWN BY: PMM  
DESIGN BY: BLL  
CHECKED BY: JGS

N:\West\04479\04479.tbl