

F.A.U. NO.	SECTION	COUNTY	TOTAL SHEETS	SHEET NO.
1389	99-00062-00-PV	DUPAGE	199	66
CONTRACT NO. 83873				
FED. ROAD DIST. NO.	ILLINOIS	FED. AID PROJECT		

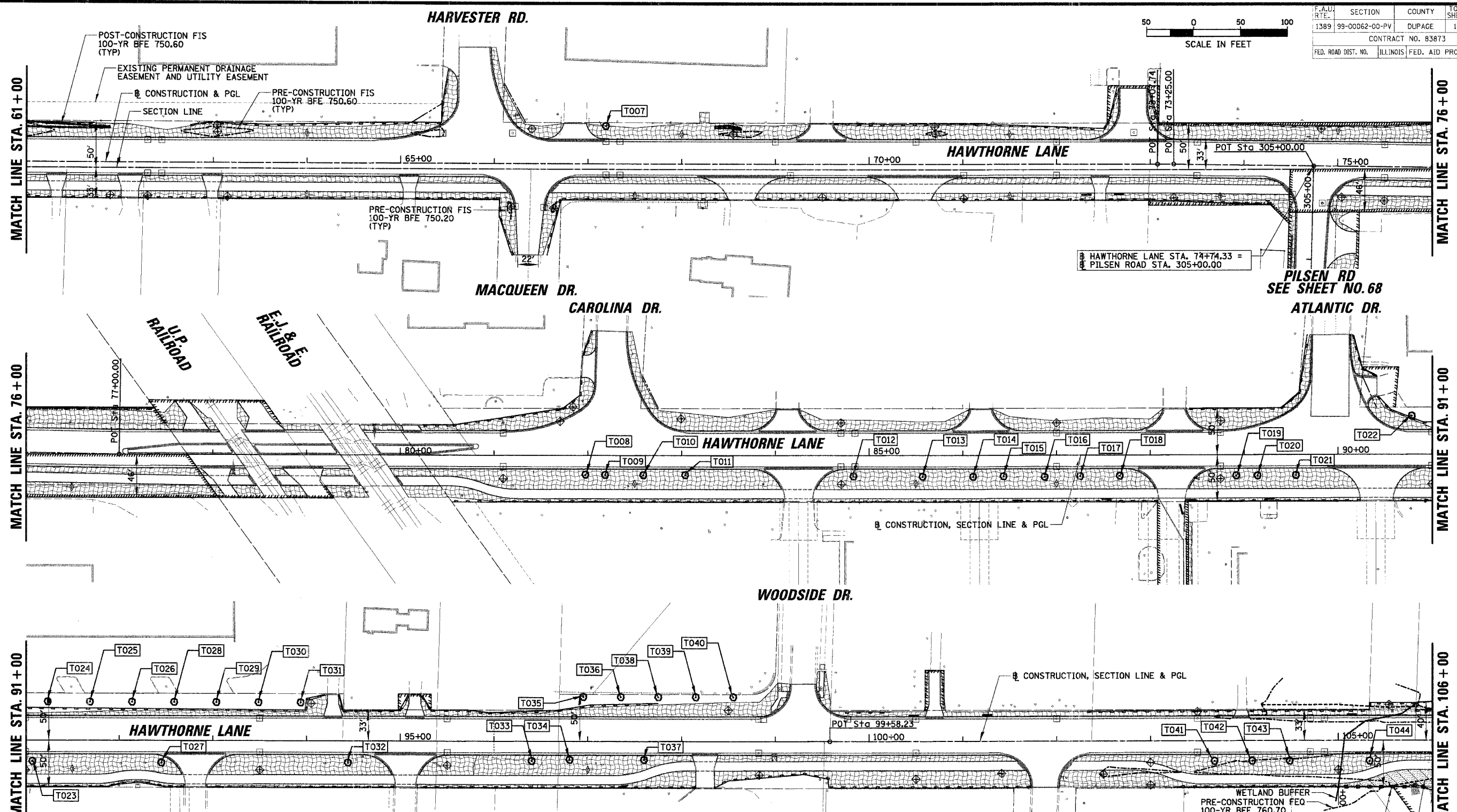
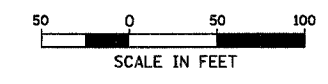

LEGEND:	
	INLET AND PIPE PROTECTION
	PERIMETER EROSION BARRIER
	TREE ROOT PRUNING
	TREE PRUNING (OF DIAMETER SHOWN)
	TEMPORARY DITCH CHECK
	INLET FILTER
	RIP-RAP
	EROSION CONTROL BLANKET SEEDING, CLASS 1A
	FERTILIZER NUTRIENTS FURNISHING AND PLACING TOPSOIL, 6"
	MULCH, METHOD 1 SEEDING, CLASS 4A (MODIFIED) FURNISHING AND PLACING TOPSOIL, 4" (BOTTOM TO NWL)
	PROPOSED TREE
	MULCH, METHOD 1 SEEDING, CLASS 4B (MODIFIED) TOPSOIL EXCAVATION AND PLACEMENT: 6" (BOTTOM TO NWL)
	EROSION CONTROL BLANKET SEEDING, WET PRAIRIE TOPSOIL EXCAVATION AND PLACEMENT: 6" (NWL TO HWL)
	EROSION CONTROL BLANKET SEEDING, MESIC PRAIRIE TOPSOIL EXCAVATION AND PLACEMENT: 6" (ABOVE HWL)
	MULCH, METHOD 2 SEEDING, CLASS 1A FERTILIZER NUTRIENTS FURNISHING AND PLACING TOPSOIL, 4"

REVISIONS	
NAME	DATE

ILLINOIS DEPARTMENT OF TRANSPORTATION
EROSION CONTROL & LANDSCAPING PLAN
HAWTHORNE LANE
STA. 61+00 TO STA. 106+00
 SCALE: 50'
 DATE: 1/5/2007
 DRAWN BY: PMM
 DESIGN BY: BLL
 CHECKED BY: JGS

NOTE: SEE SHEET 67 FOR GENERAL NOTES AND DETAILS
 SEE SHEET 68 FOR TREE SCHEDULE

N:\WestChl\04479\04479.TBL