

HARVESTER RD.

| POINT | STATION | OFFSET (LEFT) | PROP. ELEV. | DESC |
|-------|---------|---------------|-------------|-----------|
| A | 64+72.1 | 24.0 FT | 752.93 | P.C. |
| B | 65+10.9 | 28.6 FT | 752.87 | P.O.C. |
| C | 65+42.1 | 39.3 FT | 752.54 | P.C.C. |
| D | 65+58.7 | 52.3 FT | 752.11 | P.O.C. |
| E | 65+82.2 | 71.0 FT | 751.58 | P.T. |
| F | 65+82.2 | 124.3 FT | 751.00 | E.P. |
| G | 65+95.2 | 124.3 FT | 751.00 | P.T./E.P. |
| H | 66+00.2 | 86.1 FT | 751.43 | P.O.C. |
| I | 66+14.7 | 50.4 FT | 752.07 | P.C.C. |
| J | 66+33. | 31.8 FT | 752.35 | P.O.C. |
| K | 66+58.2 | 24.0 FT | 752.39 | P.C. |

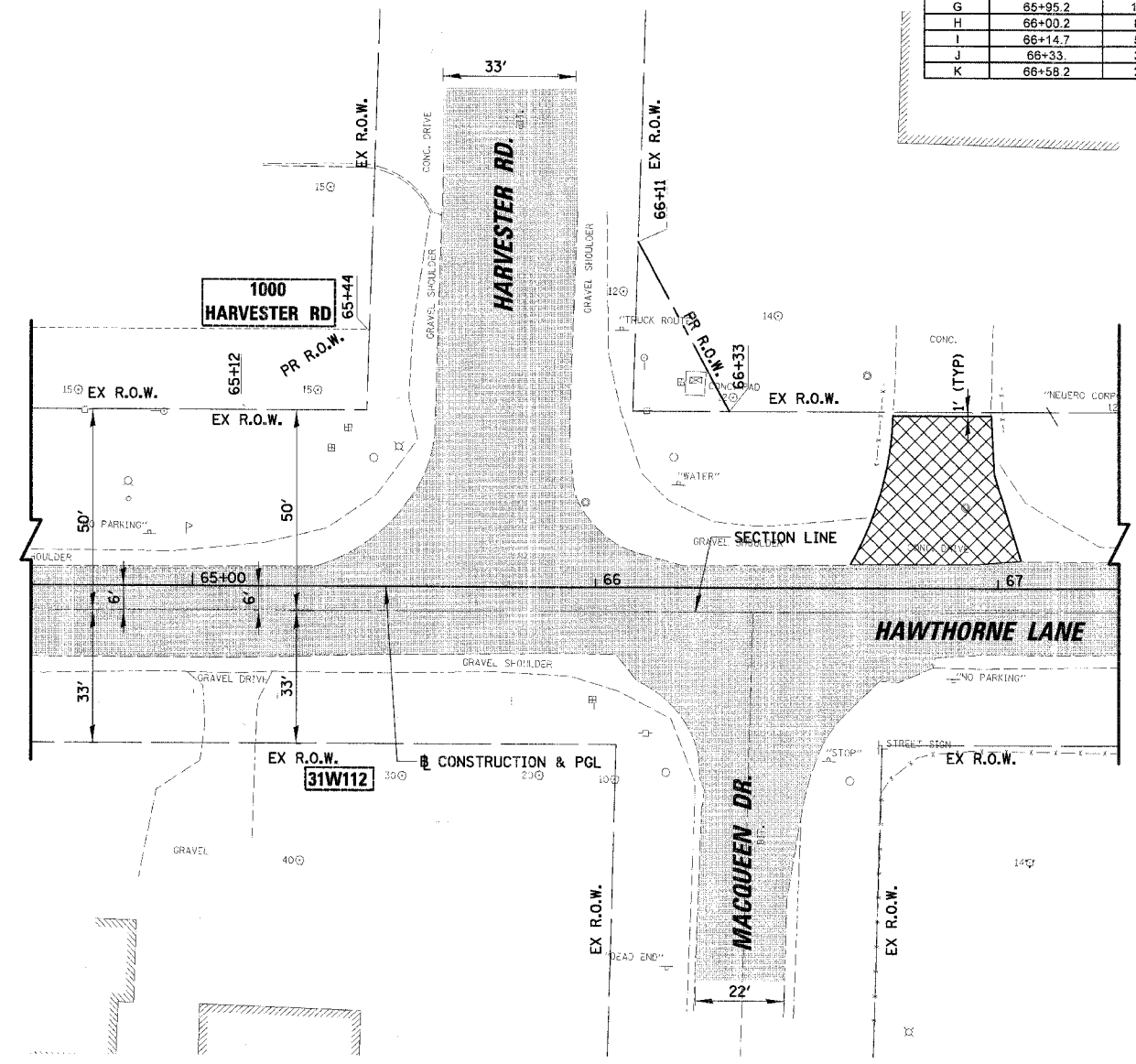

EXISTING CONDITIONS

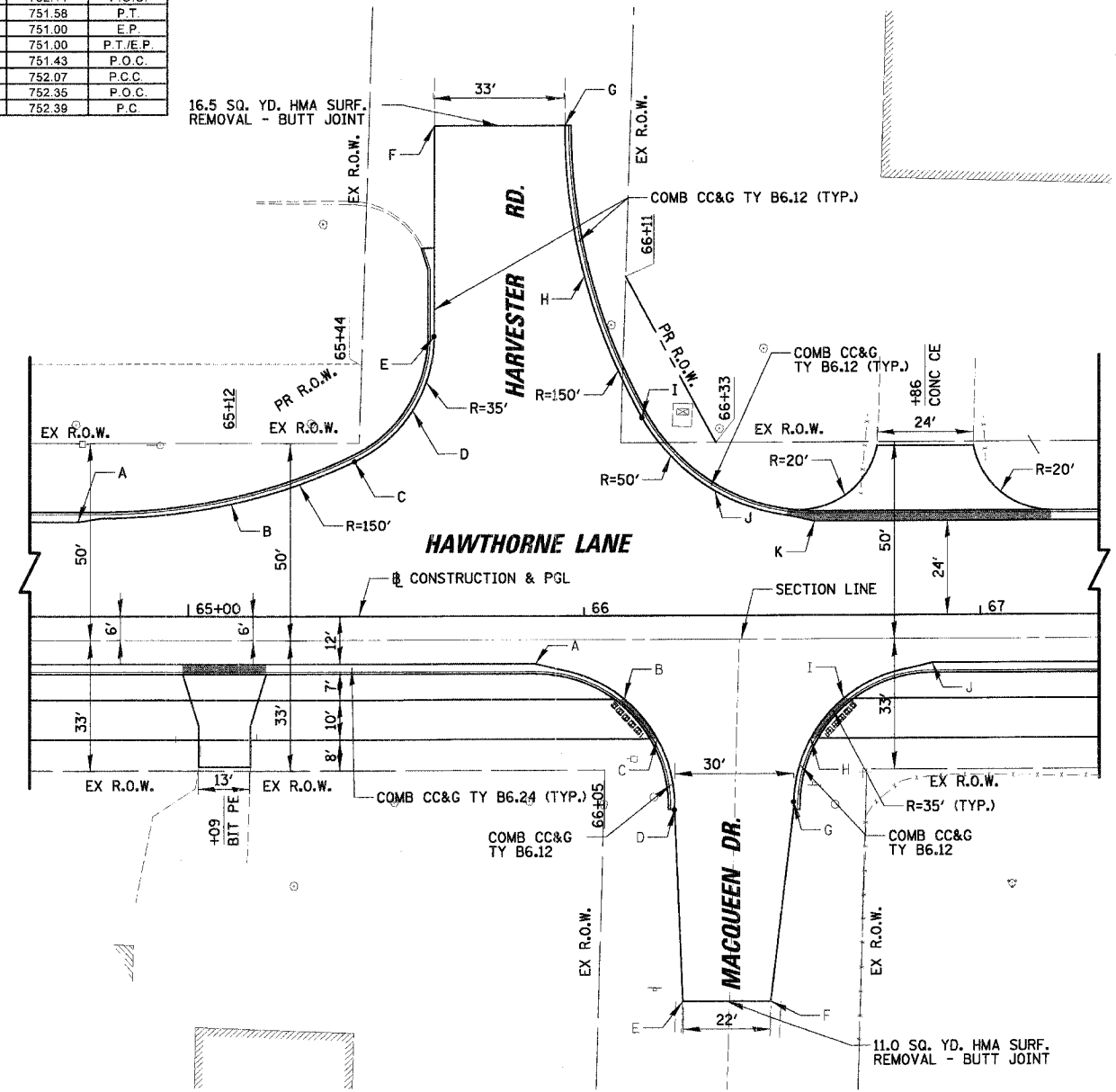

PROPOSED CONDITIONS

MACQUEEN DR.

| POINT | STATION | OFFSET (RIGHT) | PROP. ELEV. | DESC |
|-------|---------|----------------|-------------|------|
| A | 65+87.8 | 12.0 FT | 752.95 | P.C. |
| B | 66+10.2 | 21.1 FT | 752.88 | RAMP |
| C | 66+18.5 | 31.1 FT | 752.44 | RAMP |
| D | 66+22.8 | 49.0 FT | 751.75 | P.T. |
| E | 66+24.8 | 97.4 FT | 752.00 | E.P. |
| F | 66+47. | 97.4 FT | 752.50 | E.P. |
| G | 66+52.9 | 47.1 FT | 751.97 | P.T. |
| H | 66+57.2 | 31.1 FT | 752.27 | RAMP |
| I | 66+65.5 | 21.1 FT | 752.45 | RAMP |
| J | 66+87.9 | 12.0 FT | 752.58 | P.C. |

| REVISIONS | |
|-----------|------|
| NAME | DATE |
| | |
| | |
| | |
| | |
| | |

ILLINOIS DEPARTMENT OF TRANSPORTATION
INTERSECTION DETAILS
HAWTHORNE LANE / HARVESTER RD.
STA. 64 + 60 TO STA. 67 + 30
 SCALE: 20'
 DATE: 12/7/2006
 DRAWN BY: PMM
 DESIGN BY: BLL
 CHECKED BY: JCS