

**CONTROL POINTS**

POINT NO.	NORTHING	EASTING	ELEVATION
A1	1,905,276.42	1,015,685.80	753
A2	1,905,268.03	1,015,674.59	753
A3	1,905,284.27	1,015,662.44	753
A4	1,905,292.65	1,015,673.65	753
A5	1,905,616.65	1,015,778.88	753
A6	1,905,588.79	1,015,790.01	753
A7	1,905,587.42	1,015,773.32	753
A8	1,905,610.71	1,015,820.74	753
B1	1,905,417.00	1,015,764.02	755.5
B2	1,905,391.64	1,015,809.63	755.5
B3	1,905,255.44	1,015,690.43	755.5
B4	1,905,256.64	1,015,670.62	755.5
B5	1,905,388.90	1,015,571.66	755.5
B6	1,905,412.88	1,015,583.40	755.5
C1	1,905,411.65	1,015,842.56	756
C2	1,905,445.04	1,015,864.40	756
C3	1,905,468.23	1,015,851.56	756
C4	1,905,467.60	1,015,817.04	756
C5	1,905,482.06	1,015,801.78	756
C6	1,905,549.44	1,015,799.43	756
C7	1,905,586.42	1,015,805.35	756
C8	1,905,596.01	1,015,803.71	756
C9	1,905,621.10	1,015,790.02	756
C10	1,905,606.06	1,015,752.96	756
C11	1,905,553.40	1,015,773.99	756
C12	1,905,544.76	1,015,774.74	756
C13	1,905,518.45	1,015,769.22	756
C14	1,905,475.86	1,015,754.80	756
C15	1,905,465.67	1,015,740.79	756
C16	1,905,462.79	1,015,552.74	756
C17	1,905,445.51	1,015,538.19	756
C18	1,905,426.35	1,015,541.14	756
D1	1,905,494.27	1,015,901.27	757
D2	1,905,502.84	1,015,903.69	757
D3	1,905,613.42	1,015,900.91	757
D4	1,905,622.86	1,015,897.25	757
D5	1,905,646.62	1,015,876.68	757
D6	1,905,651.76	1,015,866.31	757
D7	1,905,656.74	1,015,789.42	757
D8	1,905,654.41	1,015,780.37	757
D9	1,905,636.26	1,015,751.99	757
D10	1,905,623.70	1,015,745.07	757
D11	1,905,522.46	1,015,744.53	757
D12	1,905,511.64	1,015,739.84	757
D13	1,905,501.00	1,015,728.58	757
D14	1,905,496.90	1,015,718.58	757
D15	1,905,493.10	1,015,535.60	757
D16	1,905,482.39	1,015,521.54	757
D17	1,905,476.16	1,015,519.69	757
D18	1,905,465.47	1,015,520.50	757
E1	1,905,500.80	1,015,520.84	759
E2	1,905,508.31	1,015,507.53	759
E3	1,905,578.57	1,015,467.06	759
E4	1,905,572.87	1,015,456.50	759
E5	1,905,496.20	1,015,495.31	759
F1	1,905,504.85	1,015,523.15	760
F2	1,905,513.06	1,015,509.46	760
F3	1,905,658.53	1,015,435.75	760
F4	1,905,666.14	1,015,418.14	760
G1	1,905,508.92	1,015,526.69	761
G2	1,905,517.14	1,015,513.00	761
G3	1,905,617.13	1,015,462.34	761
G4	1,905,632.57	1,015,463.47	761
G5	1,905,688.26	1,015,502.83	761
H1	1,905,614.56	1,015,683.41	762
H2	1,905,612.72	1,015,679.57	762
H3	1,905,610.11	1,015,582.85	762
H4	1,905,619.26	1,015,579.96	762
H5	1,905,678.95	1,015,669.10	762

POINT NO.	RADIUS (FT)
A1-A4	7
A5-A8	8
A6-A7	8
B1-B2	15
B3-B4	13
B5-B6	15
C2-C3	15
C4-C5	15
C7-C8	15
C9-C10	20
C11-C12	15
C14-C15	15
C16-C17	15
D1-D2	15
D3-D4	15
D5-D6	15
D7-D8	15
D9-D10	15
D11-D12	15
D13-D14	15
D15-D16	15
D17-D18	15
E1-E2	15
E3-E4	6
F1-F2	15
F3-F4	15
G1-G2	15
G3-G4	15
H1-H2	15
H3-H4	15

**DETENTION BASIN PROPOSED EARTHWORK**

ELEVATION	CUT (CU YD)	FILL (CU YD)
753 TO 753.5	24	0
753.5 TO 754	32	0
754 TO 754.5	41	0
754.5 TO 755	51	0
755 TO 755.5	141	0
755.5 TO 756	663	0
756 TO 756.5	1014	1
756.5 TO 757	1067	5
757 TO 757.5	967	7
757.5 TO 758	712	12
758 TO 758.5	578	41
758.5 TO 759	452	148
759 TO 759.5	402	310
759.5 TO 760	350	413
760 TO 760.5	300	483
760.5 TO 761	238	557
761 TO 761.5	178	491
761.5 TO 762	114	289
762 TO 762.5	66	21
762.5 TO 763	29	1
763 TO 763.5	4	0
<b>TOTAL (CU YD)</b>	<b>7421</b>	<b>2739</b>

**Total Cut = 7421 Cubic Yards**  
**Total Fill = 2739 Cubic Yards**  
**Balance = 4682 Cubic Yards**

**NORMAL WATER LEVEL (NWL) = 756**  
**HIGH WATER LEVEL (HWL) = 759.5**  
**MINIMUM BERM EL = 759.5**

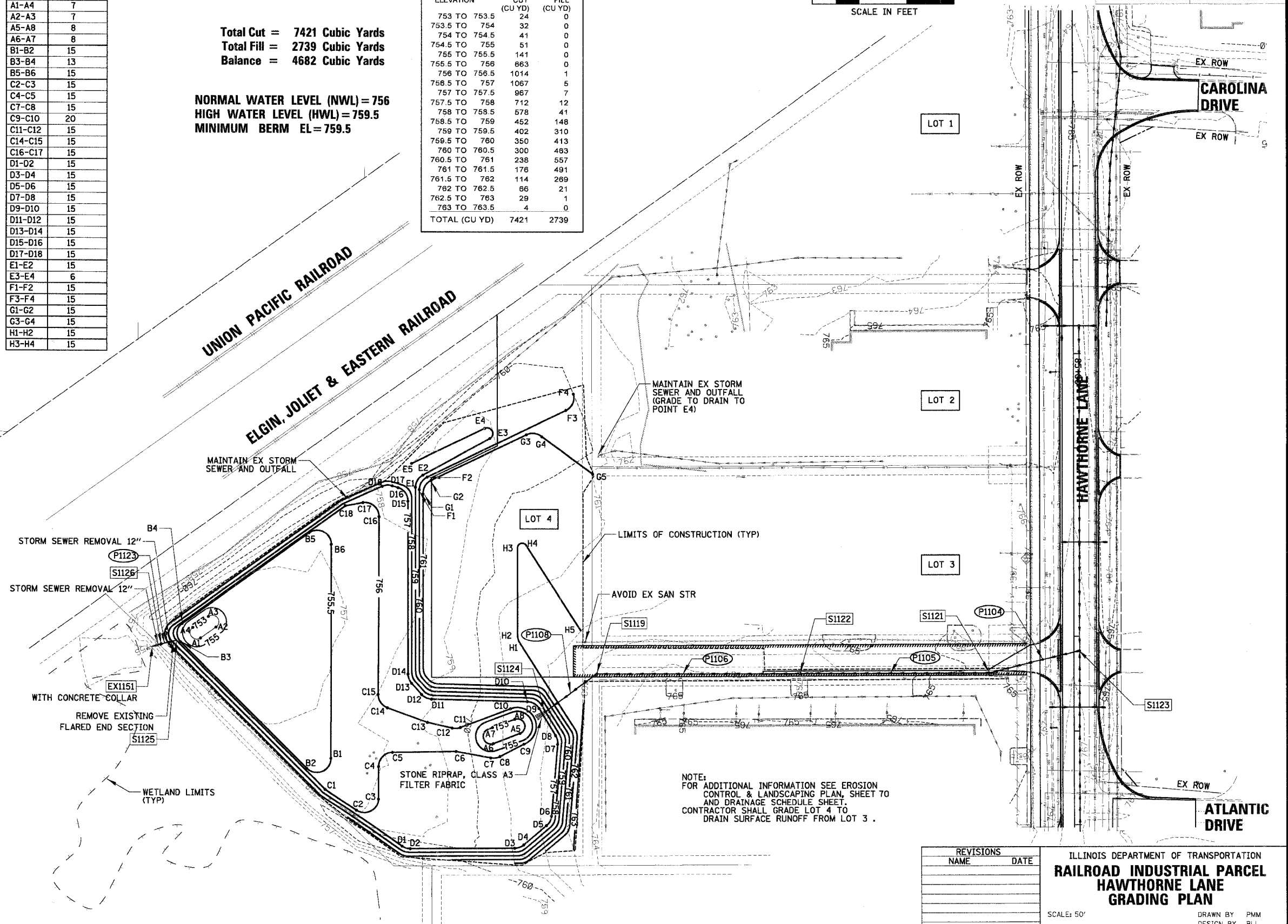
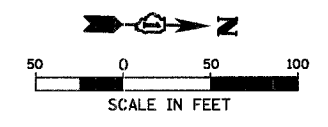

NOTE:  
 FOR ADDITIONAL INFORMATION SEE EROSION CONTROL & LANDSCAPING PLAN, SHEET 70 AND DRAINAGE SCHEDULE SHEET. CONTRACTOR SHALL GRADE LOT 4 TO DRAIN SURFACE RUNOFF FROM LOT 3.

REVISIONS	NAME	DATE

ILLINOIS DEPARTMENT OF TRANSPORTATION  
**RAILROAD INDUSTRIAL PARCEL**  
**HAWTHORNE LANE**  
**GRADING PLAN**  
 SCALE: 50'  
 DATE: 1/5/2007  
 DRAWN BY: PMM  
 DESIGN BY: BLL  
 CHECKED BY: JCS