

ORIGINAL SURVEY NOTE BOOK NO.	DATE

**CB**  
**CHRISTOPHER B. BURKE ENGINEERING LTD.**  
 9575 West Higgins Road, Suite 600  
 Rosemont, Illinois 60018  
 (847) 823-0500

FINAL SURVEY NOTE BOOK NO.	DATE

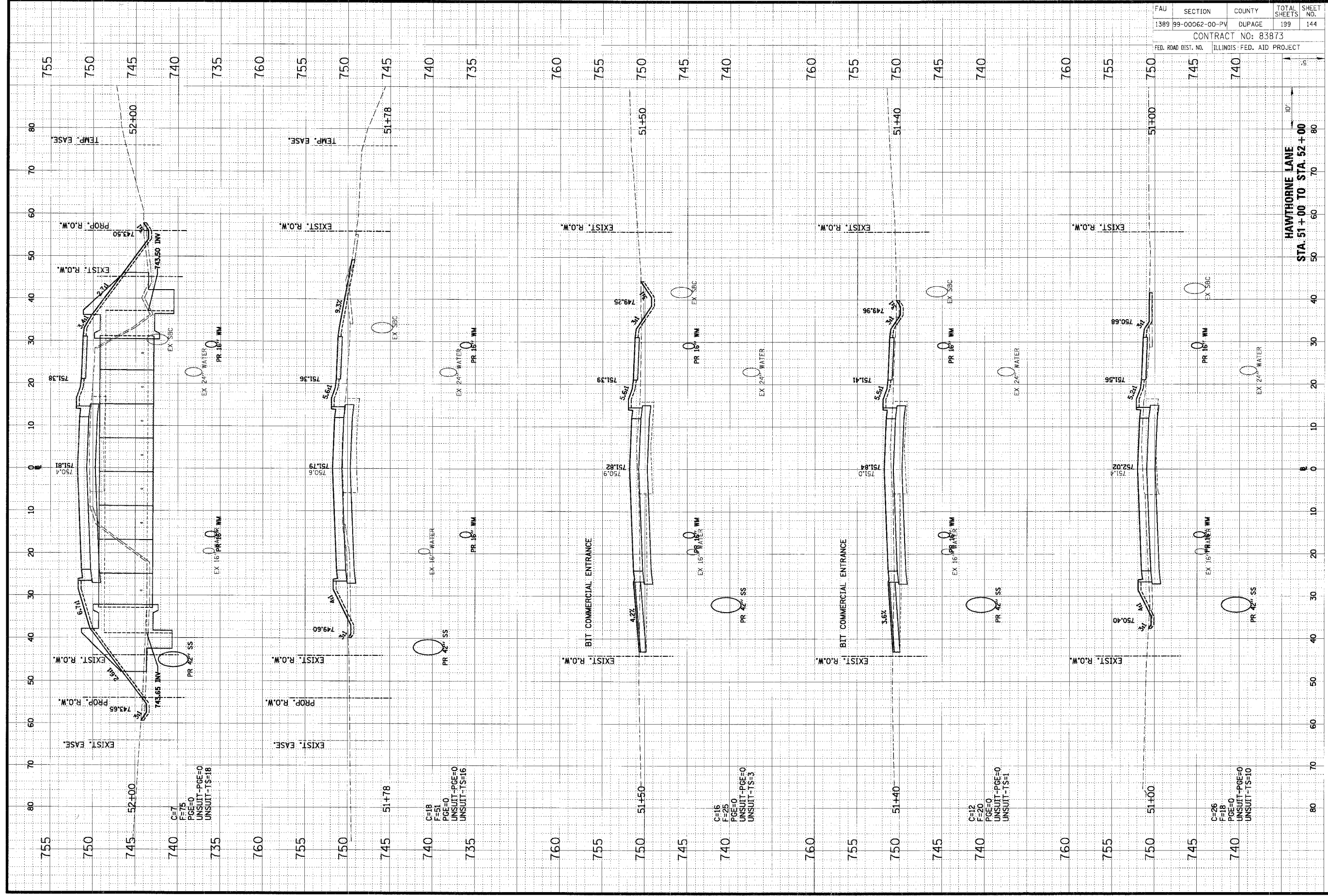

FAU	SECTION	COUNTY	TOTAL SHEETS	SHEET NO.
1389	99-00062-00-PV	DUPAGE	199	144
CONTRACT NO: 83873				
FED. ROAD DIST. NO. ILLINOIS FED. AID PROJECT				

**HAWTHORNE LANE**  
**STA. 51+00 TO STA. 52+00**