

ORIGINAL SURVEY	SURVEYED	DATE
NOTED BOOK	FLOTTED	
NO.	TEMP. DATE	
	AREAS CHECKED	

**CHRISTOPHER B. BURKE ENGINEERING LTD.**  
 9575 West Higgins Road, Suite 600  
 Rosemont, Illinois 60018  
 (847) 823-0500

FINAL SURVEY	SURVEYED	DATE
NOTED BOOK	FLOTTED	
NO.	TEMP. DATE	
	AREAS CHECKED	

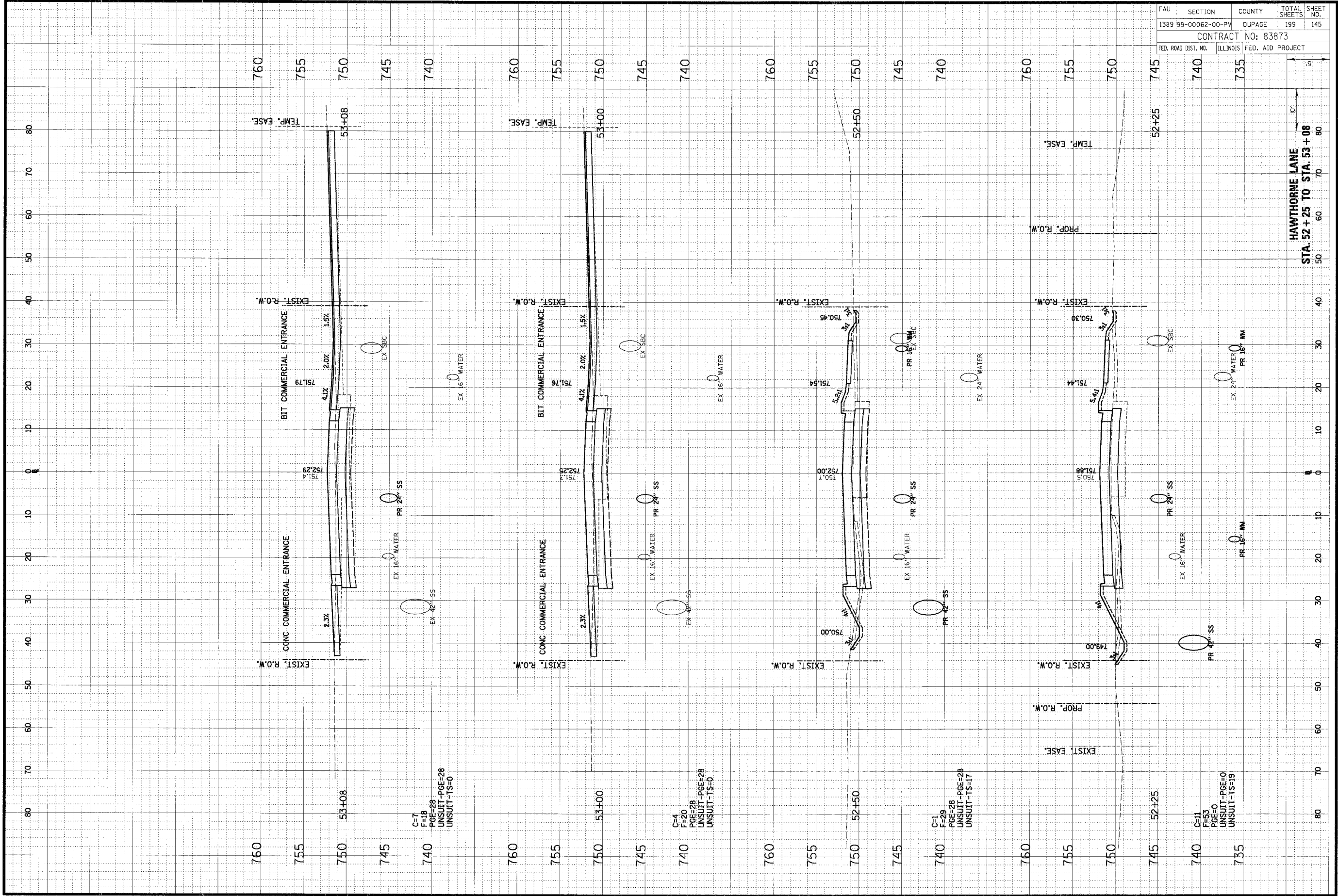

FAU	SECTION	COUNTY	TOTAL SHEETS	SHEET NO.
1389 99-00062-00-PV		DUPAGE	199	145
CONTRACT NO: 83873				
FED. ROAD DIST. NO.	ILLINOIS	FED. AID PROJECT		
			10'	

HAWTHORNE LANE  
 STA. 52+25 TO STA. 53+08