

ORIGINAL SURVEY	DATE
BY	
NOTE BOOK	
AREAS	
AREAS	

**CB**  
**CHRISTOPHER B. BURKE ENGINEERING LTD.**  
 9575 West Higgins Road, Suite 600  
 Rosemont, Illinois 60018  
 (847) 823-0500

FINAL SURVEY	DATE
BY	
NOTE BOOK	
AREAS	
AREAS	

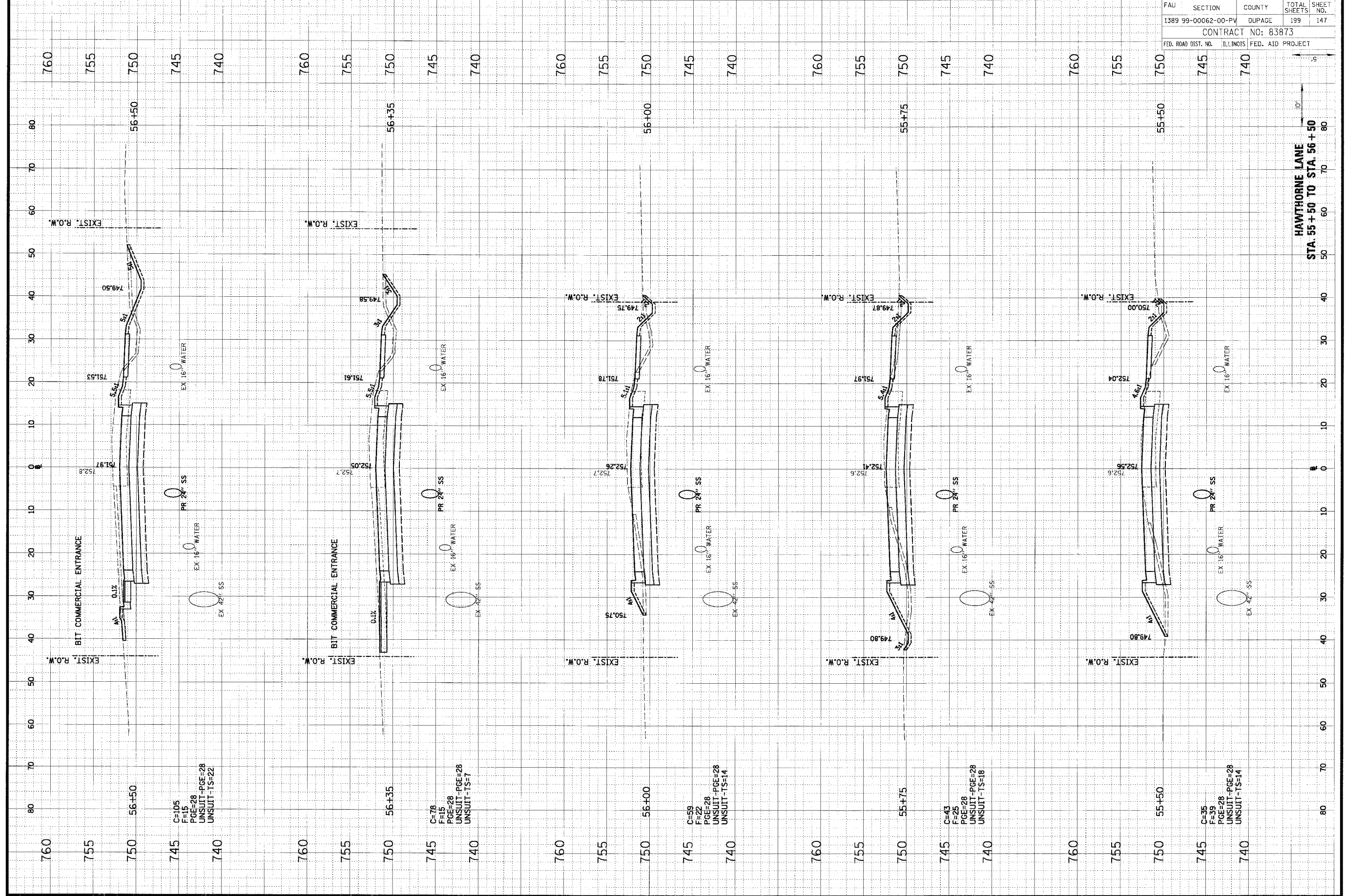

FAU	SECTION	COUNTY	TOTAL SHEETS	SHEET NO.
1389 99-00062-00-PV		DUPAGE	199	147
CONTRACT NO: 83873				
FED. ROAD DIST. NO.	ILLINOIS	FED. AID PROJECT		

HAWTHORNE LANE  
 STA. 55+50 TO STA. 56+50