

ORIGINAL	DATE
SURVILY	BY
NOTE BOOK	NO.
AREAS	OPENED

**CHRISTOPHER B. BURKE ENGINEERING LTD.**  
 9575 West Higgins Road, Suite 600  
 Rosemont, Illinois 60018  
 (847) 823-0500

FINAL	DATE
SURVILY	BY
NOTE BOOK	NO.
AREAS	OPENED

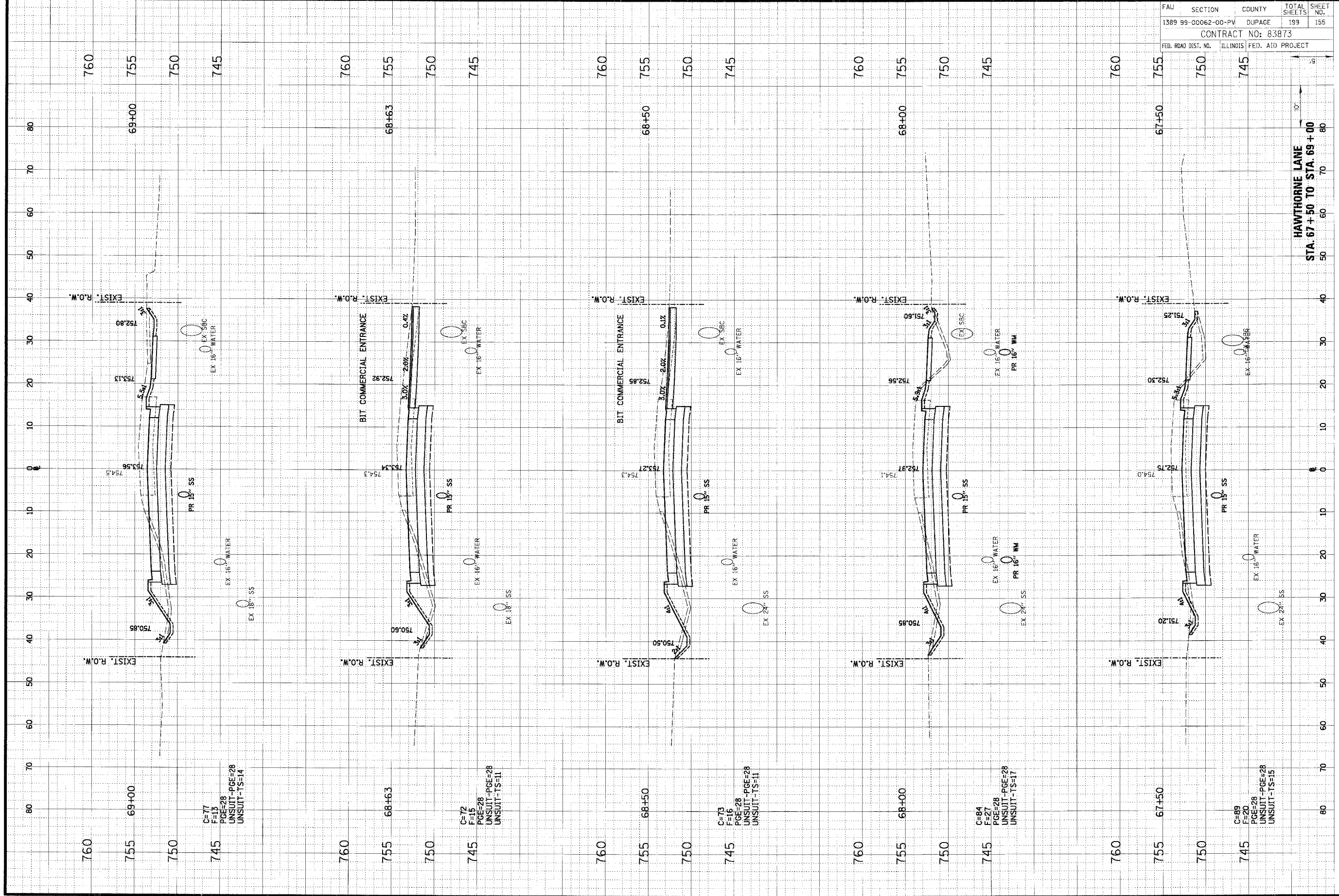

FAU	SECTION	COUNTY	TOTAL SHEETS	SHEET NO.
1389 99-00662-00-PV	DUPAGE	ILLINOIS	199	155
CONTRACT NO: 83873				
FED. ROAD DIST. NO.	ILLINOIS FED. AID PROJECT			