

ORIGINAL SURVEY	SUBMITTED	DATE
NOTE BOOK	PLATTED	BY
NO.	TEMPLATE	
	AREAS DESIGNED	

**CHRISTOPHER B. BURKE ENGINEERING LTD.**  
 9575 West Higgins Road, Suite 600  
 Rosemont, Illinois 60018  
 (847) 823-0500

FINAL SURVEY	SUBMITTED	DATE
NOTE BOOK	PLOTTED	BY
NO.	AREAS DESIGNED	

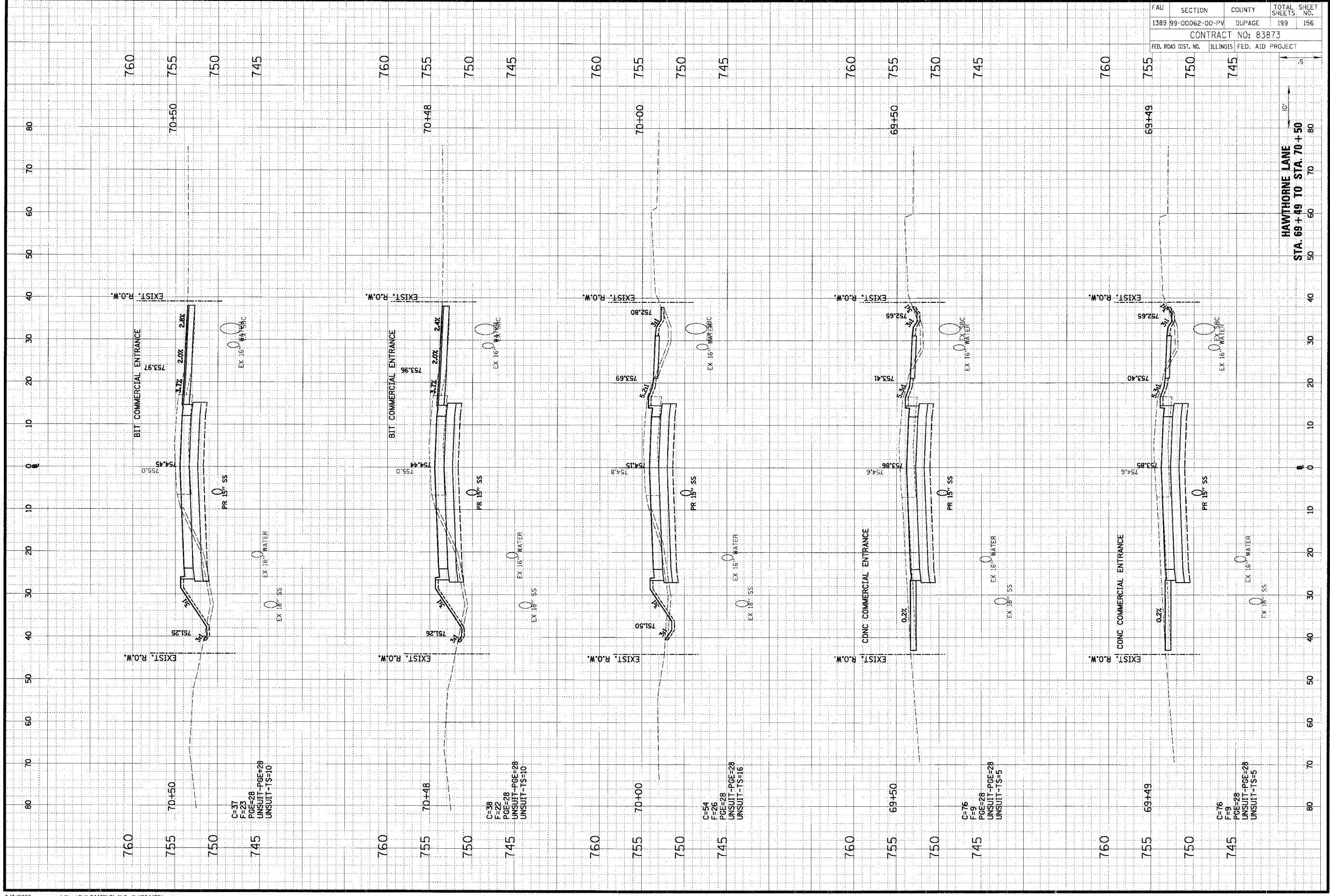

FAU	SECTION	COUNTY	TOTAL SHEETS	SHEET NO.
1389	99-00062-00-PV	DUPAGE	199	156
CONTRACT NO: 83873				
FED. ROAD DIST. NO.	ILLINOIS FED. AID PROJECT			

HAWTHORNE LANE  
 STA. 69+49 TO STA. 70+50