

ORIGINAL SURVEY	SURVEYED	BY	DATE
NOTE BOOK	TEMP. PLATE		
NO.	AREAS CHECKED		

**CHRISTOPHER B. BURKE ENGINEERING LTD.**  
 9575 West Higgins Road, Suite 600  
 Rosemont, Illinois 60018  
 (847) 823-0500

FINAL SURVEY	REVISIONS	BY	DATE
NOTE BOOK	TEMP. PLATE		
NO.	AREAS CHECKED		

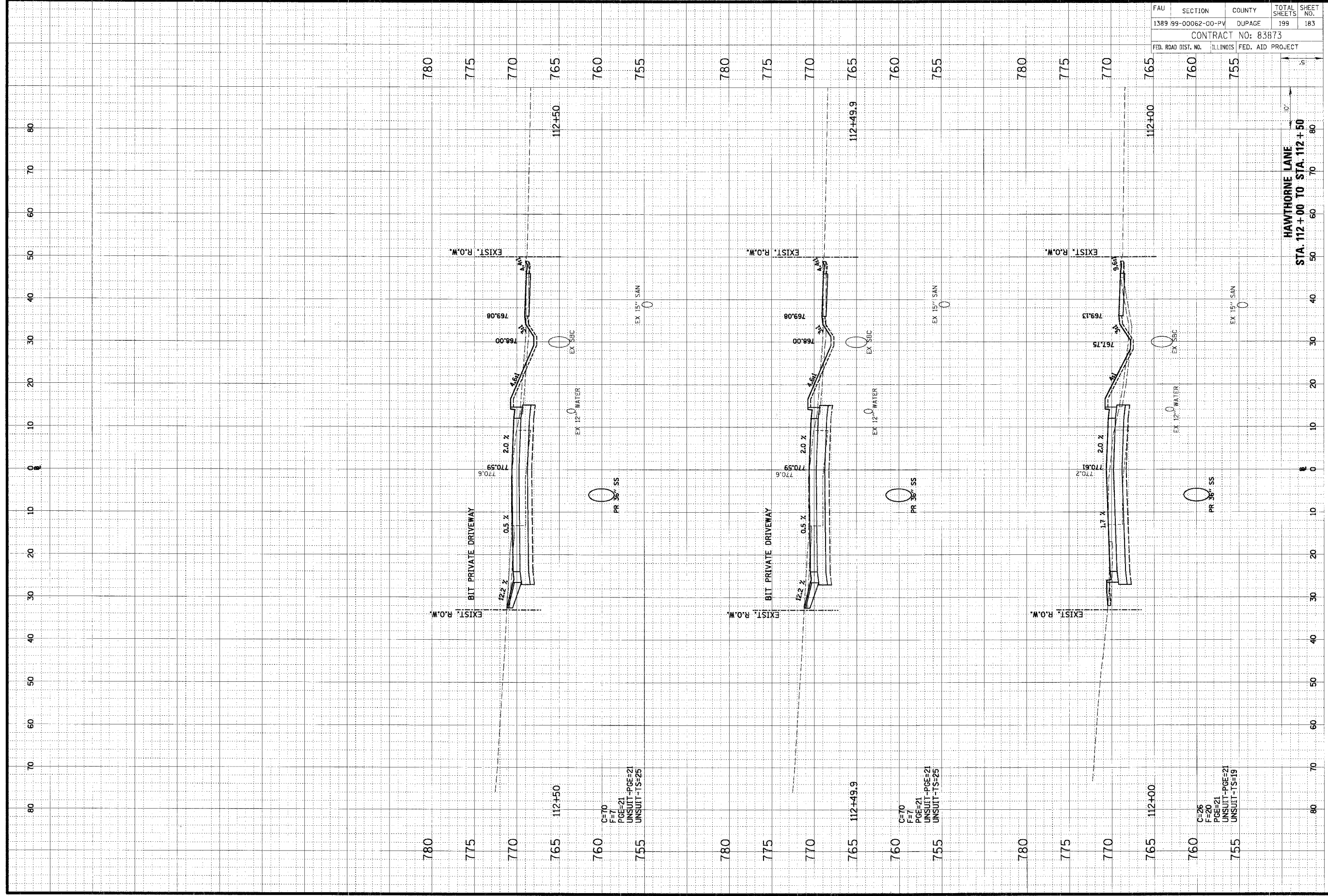

FAU	SECTION	COUNTY	TOTAL SHEETS	SHEET NO.
1389	99-00062-00-PV	DUPAGE	199	183
CONTRACT NO: 83873				
FED. ROAD DIST. NO.	ILLINOIS	FED. AID PROJECT		

HAWTHORNE LANE  
 STA. 112+00 TO STA. 112+50