

**EXISTING TOPOGRAPHY**

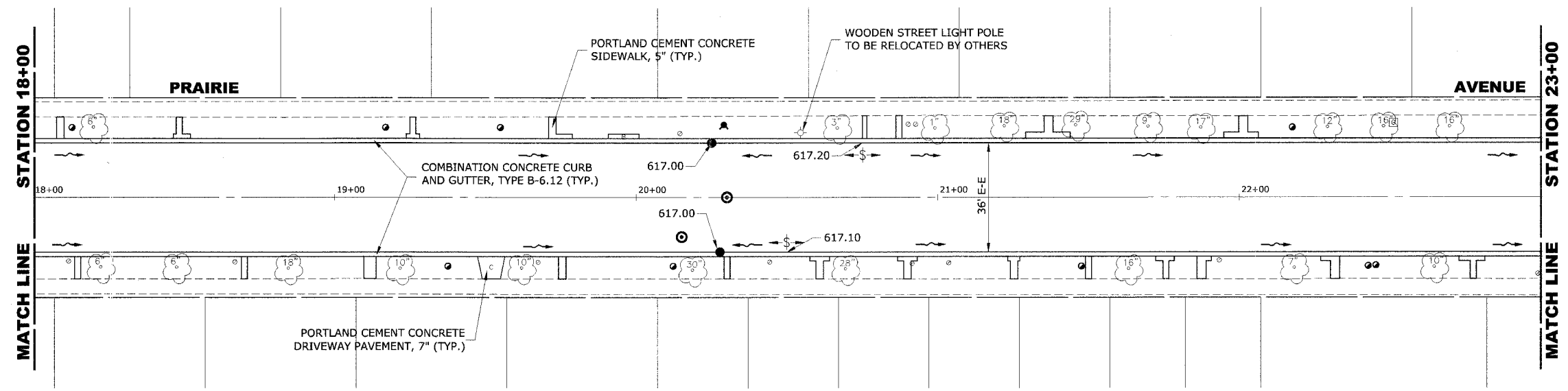

**PROPOSED IMPROVEMENTS**

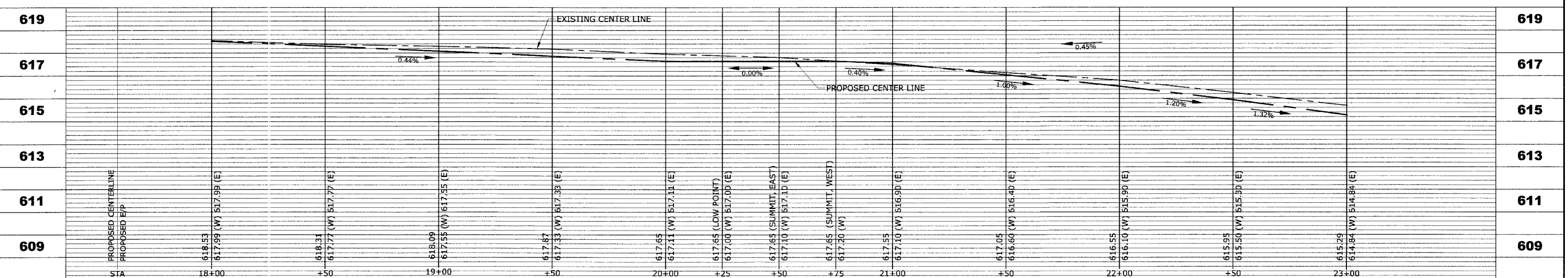

**HANCOCK ENGINEERING**  
 Civil Engineers  
 Municipal Consultants  
 Established 1911

9933 Roosevelt Road  
 Westchester, Illinois 60154-2780  
 Phone: 708/865-0300  
 Fax: 708/865-1212

**PRAIRIE AVENUE IMPROVEMENTS  
 PHASE II  
 VILLAGE OF BROOKFIELD, ILLINOIS**

**EXISTING AND PROPOSED  
 PAVING PLAN AND PROFILE**

SCALE: H: 1"=20', V: 1"=2'  
 DRAWN BY: MK/LEV  
 BOOK NO.: #1475, #1504  
 DATE: 10-6-06  
 E.H.E. NO.: 125-04-26301

REVISION:

SHEET **13** OF **47**

Drawing file: W:\Projects\12504263 - Prairie Ave 2nd Phase\Profile\Profile.dwg Oct 05, 2006 - 3:11 pm