

STRUC. NO.	STA.	OFFSET	TYPE	RIM ELEV.	INV. ELEV.
4	10+22	45' LT	R.D. CATCH BASIN, 4' DIA. TYPE 1 FRAME, OPEN LID	617.85	614.10 N
5	10+44	45' LT	R.D. CATCH BASIN, 4' DIA. TYPE 1 FRAME, OPEN LID	617.85	613.90 S 613.80 E
6	10+44	13' RT	R.D. STORM SEWER MANHOLE, 5' DIA., TYPE 1 FRAME, CLOSED LID	618.55	613.45 W 613.25 E 611.77 N,S
7	10+22	45' RT	R.D. CATCH BASIN, 4' DIA. TYPE 1 FRAME, OPEN LID	617.85	614.10 N
8	10+44	45' RT	R.D. CATCH BASIN, 4' DIA. TYPE 1 FRAME, OPEN LID	617.85	613.90 S 613.80 W
C-2	10+30	0	R.D. COMBINED SEWER MANHOLE, 4' DIA., TYPE 1 FRAME, CLOSED LID	618.99	609.58 SW 609.18 S,N

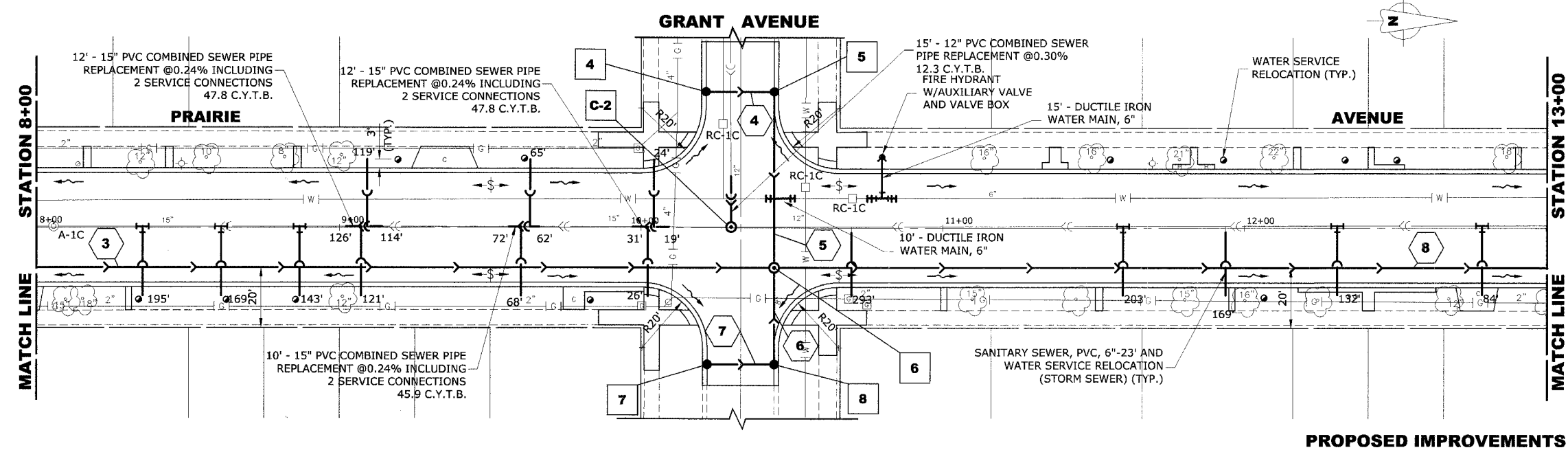

PIPE NO.	LENGTH	DIA.	TYPE	SLOPE	C.Y.T.B.
3	354'	18"	SS, TY-2, RCCP, CL-III	0.26%	205.9
4	20'	10"	SS, PVC, SDR 26	1.00%	0.5
5	55'	12"	SS, PVC, SDR 26	1.00%	4.2
6	35'	12"	SS, PVC, SDR 26	1.00%	3.0
7	20'	10"	SS, PVC, SDR 26	1.00%	0.5
8	316'	24"	SS, TY-2, RCCP, CL-III	0.18%	205.7

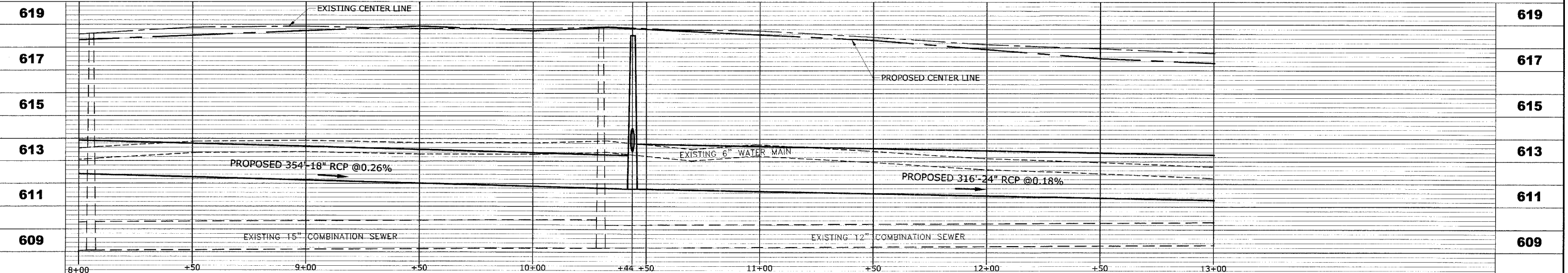

Drawing file: W:\Projects\12504263 - Prairie Ave 2nd Phase\Profile\Front.dwg Oct 05, 2006 - 3:13pm