

TREE REPLACEMENT			
COMMON NAME	SCIENTIFIC NAME	SIZE	QUANTITY*
EMERALD QUEEN NORWAY MAPLE	ACER PLATANOIDES EMERALD QUEEN	3" CALIPER	2
SUGAR MAPLE	ACER SACCHARUM	3" CALIPER	2
KENTUCKY COFFEE TREE	GYMNOCLADUS DIOICUS	3" CALIPER	2
GREENSPIRE LITTLE LEAF LINDEN	TILIA CORDATA	3" CALIPER	2

* TYPE OF TREE TO BE PLACED AT EACH LOCATION TO BE DETERMINED IN THE FIELD BY THE VILLAGE LICENSED FORESTER
 NOTE: ALL TREES BALLED AND BURLAPPED

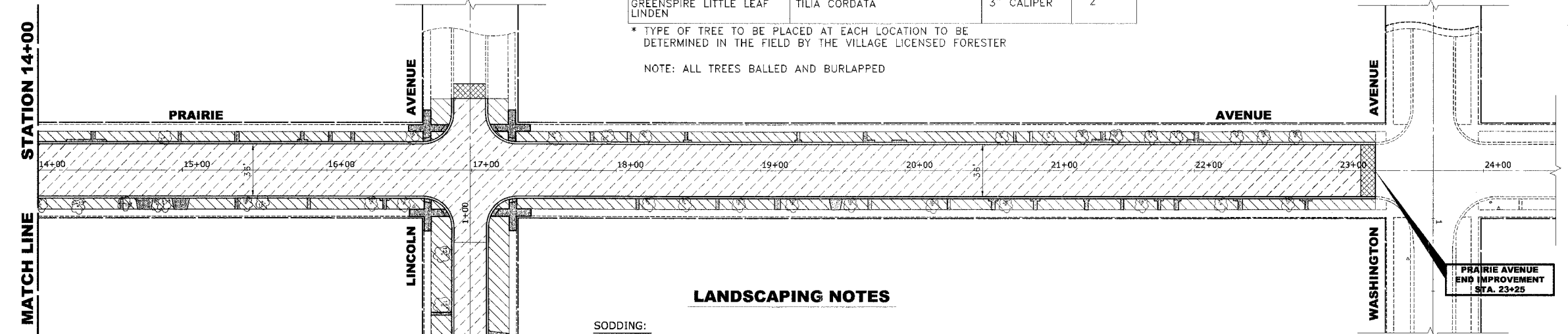

LANDSCAPING NOTES

SODDING:
 ALL DISTURBED AREAS INDICATED ON CROSS SECTION OR LANDSCAPING PLANS TO BE SODDED, INCLUDING FERTILIZER NUTRIENTS*, AND SUPPLEMENTAL WATERING WHICH IS TO BE USED AFTER THE INITIAL WATERING (AS SPECIFIED AND AS DIRECTED BY THE ENGINEER) AT THE RATE OF 10 GALLONS PER SQUARE YARD SODDING. SODDED SLOPES WHICH ARE 2:1 OR STEEPER SHALL BE STAKED. (PROVIDE A 3" STRIP AROUND CATCH BASINS IN SEEDED AREAS).

4" TOP SOIL LAYER:
 SOIL SHALL BE SPREAD AS INDICATED ON THE TYPICAL CROSS SECTIONS.
 A MINIMUM OF GRADING TO BE PERMITTED WITHIN AN APPROXIMATE RADIUS OF 6' FROM ALL TREES TO BE SAVED AS DETERMINED BY THE ENGINEER.

FERTILIZER NUTRIENTS* FOR SODDING:
 USE A FERTILIZER WITH A 1:1:1 RATIO PER ACRE:
 60 LBS. NITROGEN FERTILIZER NUTRIENT
 60 LBS. PHOSPHORUS FERTILIZER NUTRIENT
 60 LBS. POTASSIUM FERTILIZER NUTRIENT
 TOTAL: 180 LBS. PER ACRE

TREE REPLACEMENT:
 TREE TYPE & LOCATION TO BE DETERMINED IN THE FIELD BY THE VILLAGE LICENSED FORESTER

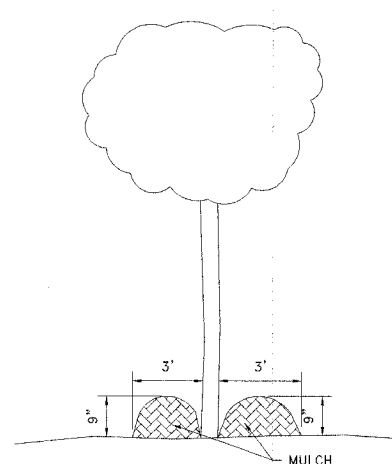

SYMBOL	DESCRIPTION
[Solid black box]	PROPOSED CONCRETE AREA
[Diagonal hatching]	PROPOSED BITUMINOUS CONCRETE AREA
[Cross-hatching]	PROPOSED SODDED PARKWAY
[Dotted pattern]	PROPOSED SEEDED PARKWAY
[Stippled pattern]	PROPOSED BITUMINOUS CONCRETE REMOVAL

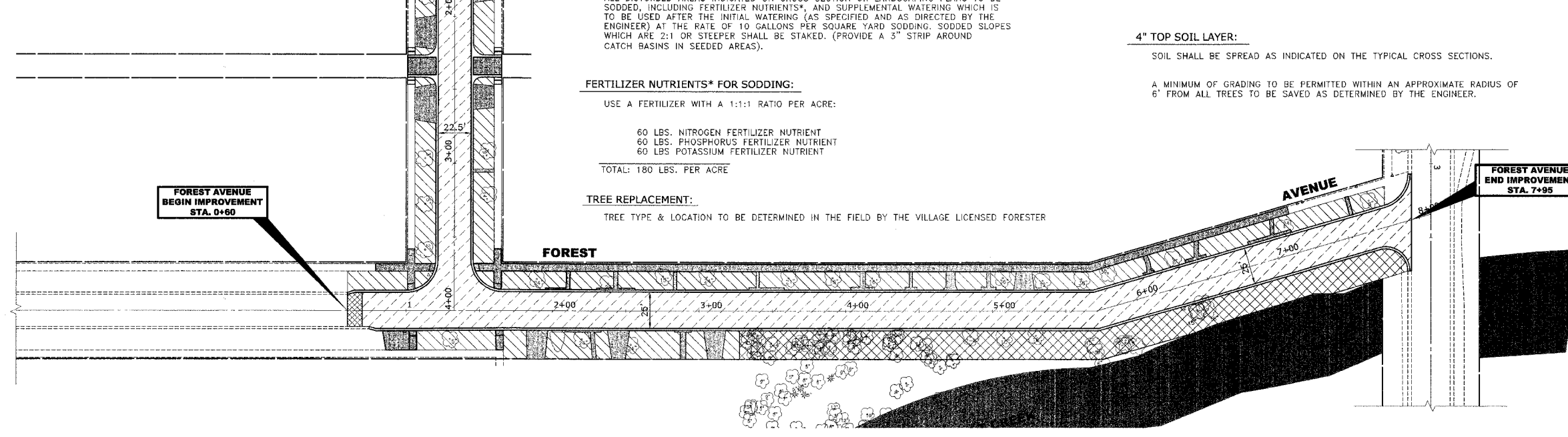

FOREST AVENUE END IMPROVEMENT STA. 7+95

Drawing File: W:\Projects\12504263 - Prairie Ave 2nd Phase\Pravie\Sheet_Landscaping_Plan.dwg Oct 05, 2006 - 2:37pm

HANCOCK ENGINEERING ♦ Civil Engineers ♦ Municipal Consultants ♦ Established 1911
 9933 Roosevelt Road Westchester, Illinois 60154-2780
 Phone: 708/865-0300 Fax: 708/865-1212

PRAIRIE AVENUE IMPROVEMENTS PHASE II VILLAGE OF BROOKFIELD, ILLINOIS

ASPHALT AND LANDSCAPING PLAN

SCALE: 1"=40'	SHEET 36/47
DRAWN BY: MK/LEV	
BOOK NO.: #1475, #1504	
DATE: 10-6-06	
REVISION:	E.H.E. NO.: 125-04-26301 OF