

CONTRACT NO. 83883				
F.A.U. RTE.	SECTION	COUNTY	TOTAL SHEETS	SHEET NO.
1700	05-00045-02-PV	COOK/DUPAGE	103	60
DETAILS				
FED. ROAD DIST. NO. 7 ILLINOIS FED. AID PROJECT M-8003(544)				

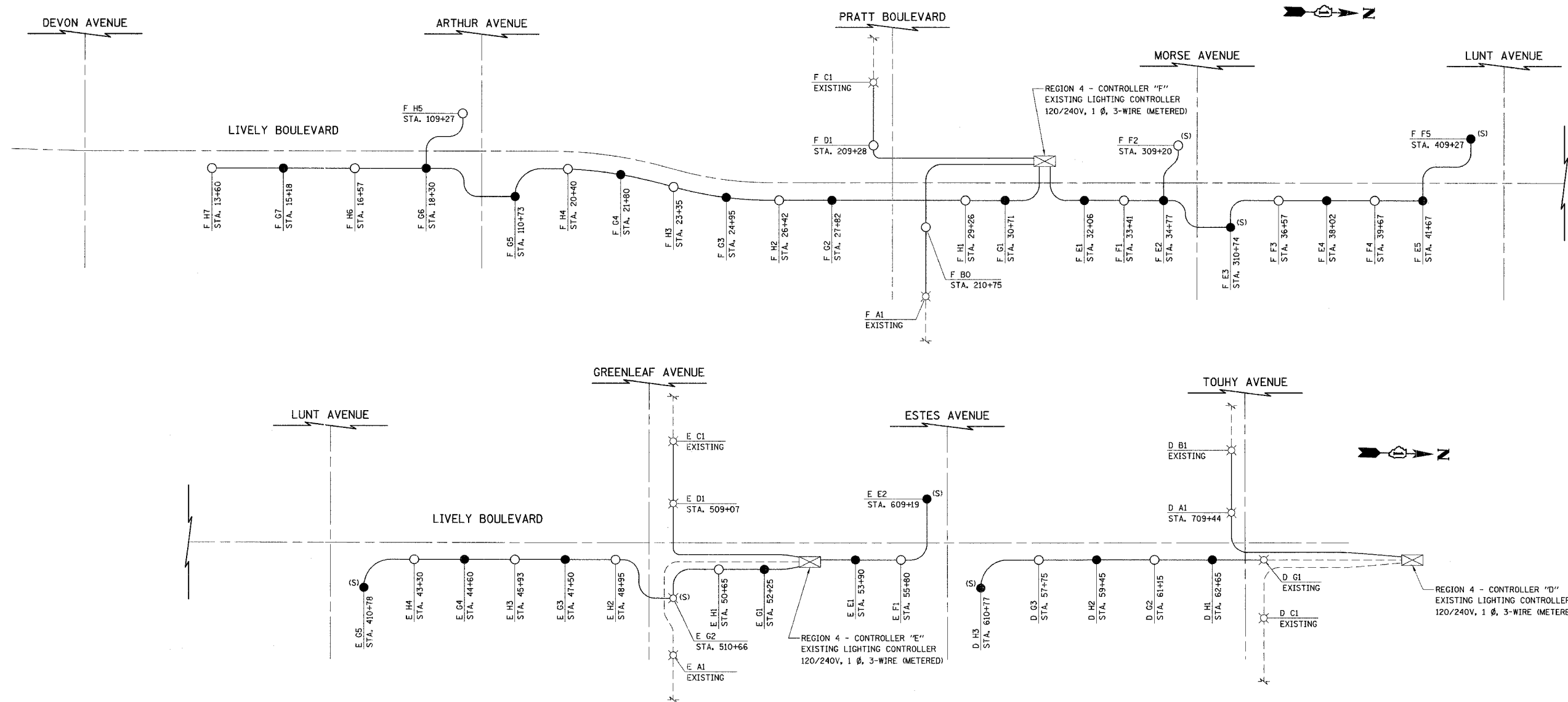

**CIRCUIT DESIGNATION SCHEME**  
(TYPICAL)

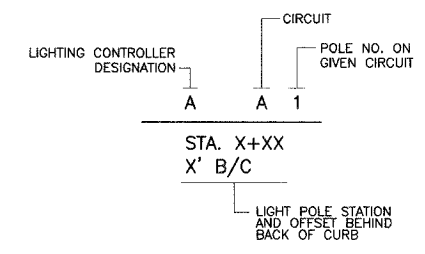

**LEGEND**

- LUMINAIRE, SODIUM VAPOR  
250W, 120V ON RED WIRE
- LUMINAIRE, SODIUM VAPOR  
250W, 120V ON BLACK WIRE
- (S) ○ LUMINAIRE, SODIUM VAPOR  
150W, 120V
- (S) ● LUMINAIRE, SODIUM VAPOR  
150W, 120V
- ⊗ EXISTING LUMINAIRE, SODIUM VAPOR  
150W, 120V
- ⊠ EXISTING LIGHTING CONTROLLER  
120/240V, 1 Ø, 3-WIRE
- UNIT DUCT, WITH 3-1/2" NO. 6  
AND 1-1/2" NO. 8 GROUND, 600V  
(XLP-TYPE USE) 1/4" DIA. POLYETHYLENE  
(UNLESS OTHERWISE NOTED)

ILLINOIS DEPARTMENT OF TRANSPORTATION

**WIRING DIAGRAM**

REGION 4 - CONTROLLER 'D'  
REGION 4 - CONTROLLER 'E'  
REGION 4 - CONTROLLER 'F'

DATE: 10/18/06  
DESIGNED BY: SJC  
CHECKED BY: JRJ

NOT TO SCALE