

F.A. RTE.	SECTION	COUNTY	TOTAL SHEETS	SHEET NO.
532	02-00117-21-BR	WILL	35	7
STA.	TO STA.			
FED. ROAD DIST. NO. 1 ILLINOIS FED. AID PROJECT				

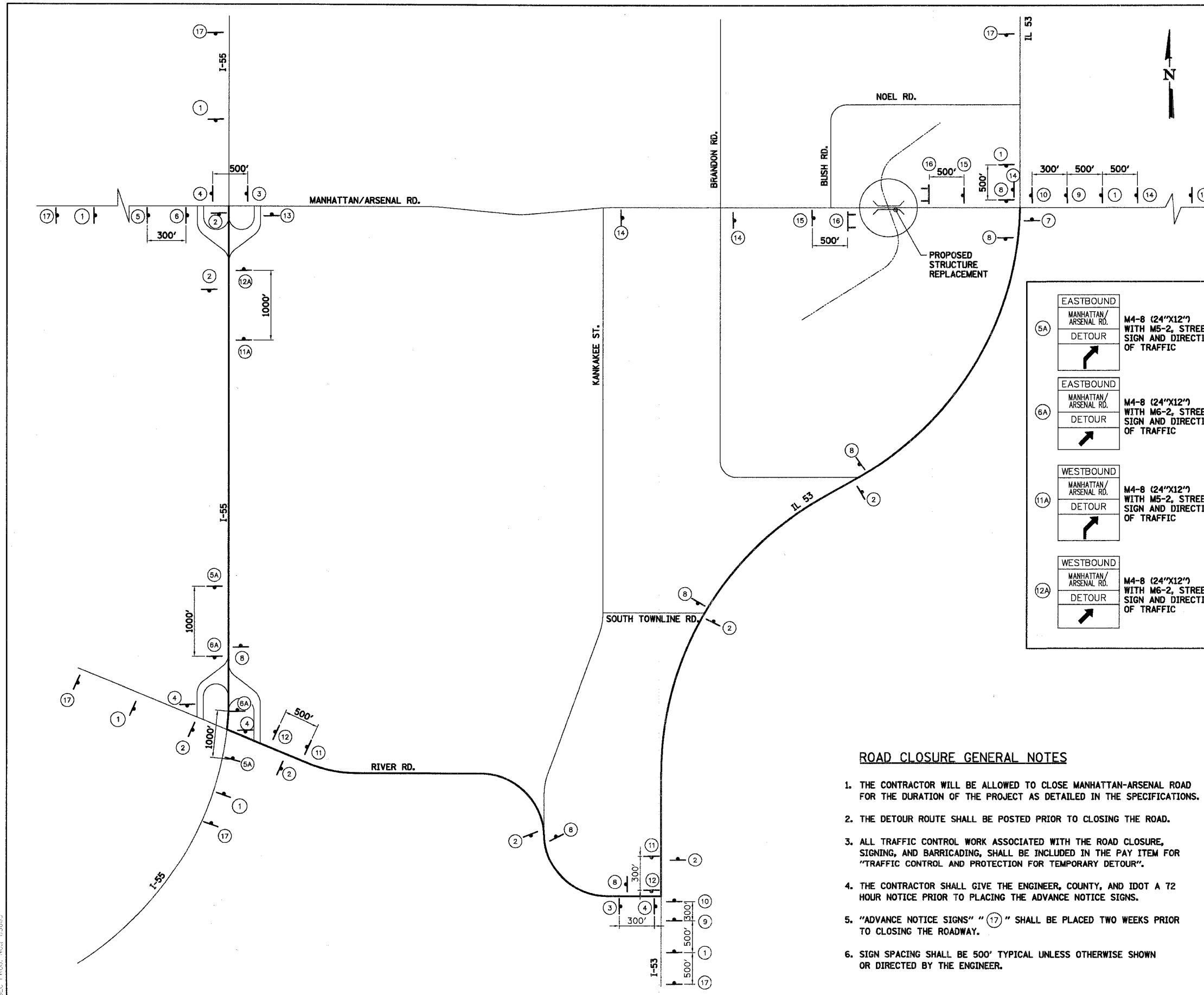

### SIGN LEGEND

1	DETOUR AHEAD	W20-3 (48"x48") WITH STREET SIGN
2	EASTBOUND MANHATTAN/ARSENAL RD. DETOUR	M4-9 (30"x21") WITH STREET SIGN AND DIRECTION OF TRAFFIC
3	EASTBOUND MANHATTAN/ARSENAL RD. DETOUR	M4-9L <sub>a</sub> (30"x21") WITH STREET SIGN AND DIRECTION OF TRAFFIC
4	EASTBOUND MANHATTAN/ARSENAL RD. DETOUR	M4-9L (30"x21") WITH STREET SIGN AND DIRECTION OF TRAFFIC
5	EASTBOUND MANHATTAN/ARSENAL RD. DETOUR	M4-9R <sub>a</sub> (30"x21") WITH STREET SIGN AND DIRECTION OF TRAFFIC
6	EASTBOUND MANHATTAN/ARSENAL RD. DETOUR	M4-9R (30"x21") WITH STREET SIGN AND DIRECTION OF TRAFFIC
7	EASTBOUND MANHATTAN/ARSENAL RD. END DETOUR	M4-8 <sub>a</sub> (24"x18") WITH STREET SIGN AND INFORMATION SIGN
8	WESTBOUND MANHATTAN/ARSENAL RD. DETOUR	M4-9 (30"x21") WITH STREET SIGN AND DIRECTION OF TRAFFIC
9	WESTBOUND MANHATTAN/ARSENAL RD. DETOUR	M4-9L <sub>a</sub> (30"x21") WITH STREET SIGN AND DIRECTION OF TRAFFIC
10	WESTBOUND MANHATTAN/ARSENAL RD. DETOUR	M4-9L (30"x21") WITH STREET SIGN AND DIRECTION OF TRAFFIC
11	WESTBOUND MANHATTAN/ARSENAL RD. DETOUR	M4-9R <sub>a</sub> (30"x21") WITH STREET SIGN AND DIRECTION OF TRAFFIC
12	WESTBOUND MANHATTAN/ARSENAL RD. DETOUR	M4-9R (30"x21") WITH STREET SIGN AND DIRECTION OF TRAFFIC
13	WESTBOUND MANHATTAN/ARSENAL RD. END DETOUR	M4-8 <sub>a</sub> (24"x18") WITH STREET SIGN AND INFORMATION SIGN
14	ROAD CLOSED MILES AHEAD LOCAL TRAFFIC ONLY	R11-3 <sub>a</sub> (60"x30")
15	ROAD CLOSED AHEAD	W20-2 (48"x48")
16	ROAD CLOSED	R11-2 (48"x30")
17	MANHATTAN/ARSENAL RD CLOSED BETWEEN BUSH RD AND IL ROUTE 53 USE RIVER RD	
		INFO (60"x30")

### ROAD CLOSURE GENERAL NOTES

1. THE CONTRACTOR WILL BE ALLOWED TO CLOSE MANHATTAN-ARSENAL ROAD FOR THE DURATION OF THE PROJECT AS DETAILED IN THE SPECIFICATIONS.
2. THE DETOUR ROUTE SHALL BE POSTED PRIOR TO CLOSING THE ROAD.
3. ALL TRAFFIC CONTROL WORK ASSOCIATED WITH THE ROAD CLOSURE, SIGNING, AND BARRICADING, SHALL BE INCLUDED IN THE PAY ITEM FOR "TRAFFIC CONTROL AND PROTECTION FOR TEMPORARY DETOUR".
4. THE CONTRACTOR SHALL GIVE THE ENGINEER, COUNTY, AND IDOT A 72 HOUR NOTICE PRIOR TO PLACING THE ADVANCE NOTICE SIGNS.
5. "ADVANCE NOTICE SIGNS" "17" SHALL BE PLACED TWO WEEKS PRIOR TO CLOSING THE ROADWAY.
6. SIGN SPACING SHALL BE 500' TYPICAL UNLESS OTHERWISE SHOWN OR DIRECTED BY THE ENGINEER.

REVISIONS		WILL COUNTY DEPARTMENT OF HIGHWAYS	
NAME	DATE		
		<p align="center"><b>TEMPORARY DETOUR PLAN</b></p> <p align="center">MANHATTAN-ARSENAL ROAD OVER JACKSON CREEK</p>	

SCALE: NONE  
DATE 12-08-06

DRAWN BY SVJ  
CHECKED BY JJS

COMPANY NAME: SEC, INC.  
PROJECT: CONTRACT 1, SCOTT GREECH  
DATE: 12/8/2006  
V:\Jobs\2004\848595\Lead\Sheets\848595-614.dwg  
SEC PROJ. NO.: 83885