

|                       |         |           |                  |             |
|-----------------------|---------|-----------|------------------|-------------|
| ROUTE NO.             | SECTION | COUNTY    | SHEET            | SHEET NO. 1 |
| FAP 0525              |         | WINNEBAGO | 187 27           | 5 SHEETS    |
| FED. ROAD DIST. NO. 7 |         | ILLINOIS  | FED. AID PROJECT |             |
| • 02-00518-00-BR      |         |           |                  |             |

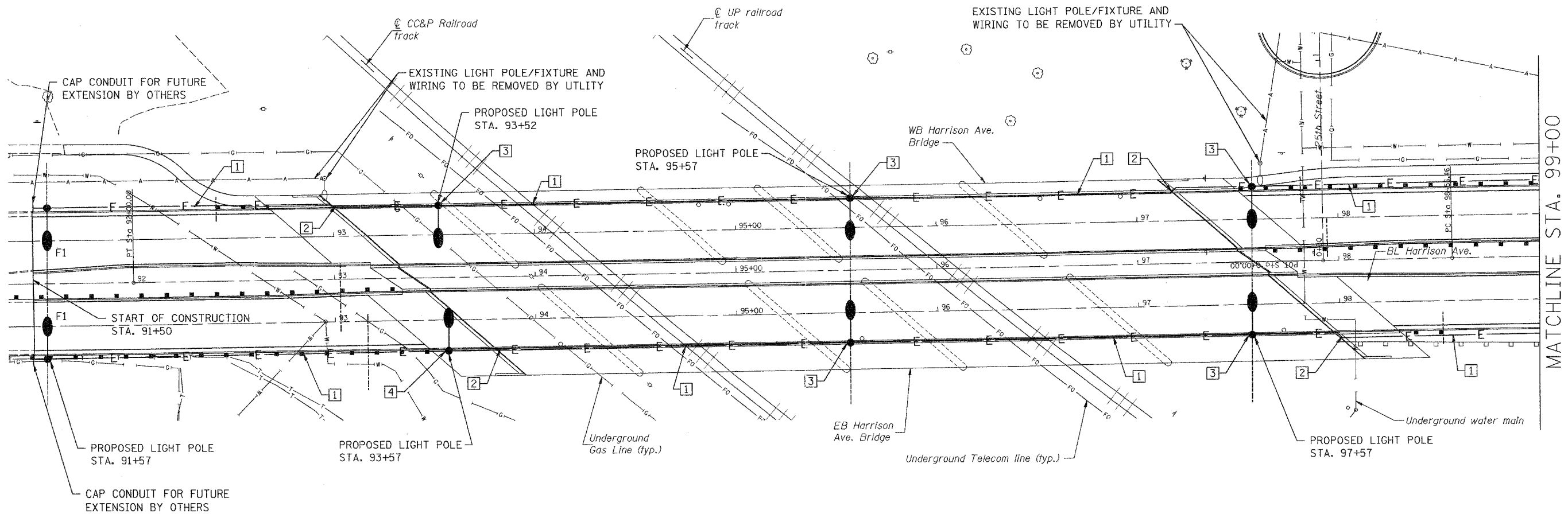

**KEYED NOTES:**

- 1 2" C. (SCHED. 40 PVC)
- 2 JUNCTION BOX BELOW BRIDGE ON ABUTMENT - REFER TO DETAIL ON LIGHTING SHEET L5.
- 3 PROVIDE TYPE F1 AND F2 LIGHT FIXTURES ON BRIDGE LIGHT POLES ONLY. REFER TO MOUNTING DETAIL ON SHEET L4.
- 4 PROVIDE TYPE F1 AND F2 LIGHT FIXTURES ON APPROACH PAVEMENT PARAPET. REFER TO MOUNTING DETAIL ON SHEET L4.

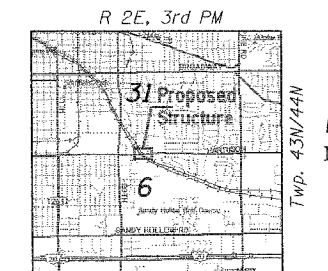
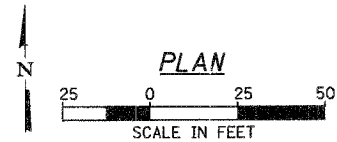

LOCATION SKETCH

| SUMMARY OF QUANTITIES - HARRISON AVENUE BRIDGE                      |          |      |
|---|----------|------|
| CONDUIT IN TRENCH, 2" DIA., PVC                                     | LIN. FT. | 1800 |
| CONDUIT EMBEDDED IN STRUCTURE, 2" DIA., PVC                         | LIN. FT. | 845  |
| JUNCTION BOX, STAINLESS STEEL, ATTACHED TO STRUCTURE 18" x 12" x 6" | EACH     | 4    |
| TRENCH AND BACKFILL FOR ELECTRIC WORK                               | LIN. FT. | 1800 |
| LUMINAIRE, PULSE START, METAL HALIDE, 400W                          | EACH     | 14   |
| LUMINAIRE, PULSE START, METAL HALIDE, 150W                          | EACH     | 6    |
| LIGHT POLE, ALUMINUM, 40 FT. M.H., 10 FT. MAST ARM                  | EACH     | 14   |
| LIGHT POLE FOUNDATION   | EACH     | 8    |
| CONDUIT, FLEXIBLE METALLIC, WEATHERPROOF, 2"                        | EACH     | 4    |

THE LOCATION, SIZE AND TYPE OF MATERIAL OF EXISTING UNDERGROUND UTILITIES INDICATED ON THE PLANS IS NOT REPRESENTED AS BEING ACCURATE, SUFFICIENT OR COMPLETE. IT SHALL BE THE CONTRACTOR'S RESPONSIBILITY TO DETERMINE THE ACTUAL LOCATION OF ALL SUCH FACILITIES, INCLUDING THE SERVICE CONNECTIONS TO UNDERGROUND UTILITIES. PRIOR TO CONSTRUCTION THE CONTRACTOR SHALL NOTIFY THE UTILITY COMPANIES OF HIS OPERATIONAL PLANS AND SHALL OBTAIN FROM THE RESPECTIVE UTILITY COMPANIES DETAILED INFORMATION AND ASSISTANCE RELATIVE TO THE LOCATION OF THEIR FACILITIES AND THE WORKING SCHEDULE OF THE COMPANIES FOR REMOVAL OR ADJUSTMENT WHERE REQUIRED. IN THE EVENT AN UNEXPECTED UTILITY INTERFERENCE IS ENCOUNTERED DURING CONSTRUCTION, THE CONTRACTOR SHALL IMMEDIATELY NOTIFY THE UTILITY COMPANY OF JURISDICTION. THE ENGINEER SHALL ALSO BE IMMEDIATELY NOTIFIED. ANY SUCH MAINS AND SERVICES SHALL BE RESTORED TO SERVICE AT ONCE AND PAID FOR BY THE CONTRACTOR AT NO ADDITIONAL COST TO THE CONTRACT.

CONTACT JOINT UTILITY LOCATING INFORMATION FOR EXCAVATING (JULIE) 1-800-892-0123 FOR UTILITY INFORMATION.

Corporate License Number 184-001-084

**BRIDGE LIGHTING PLAN**

**HARRISON AVENUE BRIDGE  
OVER UP & CC&P RAILROAD  
F.A.P. ROUTE 0525  
SECTION 02-00518-00-BR  
ROCKFORD, ILLINOIS  
WESTBOUND STRUCTURE NO. 101-6109  
EASTBOUND STRUCTURE NO. 101-6111**

© Copyright Hanson Professional Services Inc. 2005

L1



JOB NO. 03R1751

DATE 07/18/06

7/18/06 AM  
 12:14:00.6 07/18 AM  
 IN03 085-03R1751 Structure Sheet Lighting.P.d 12:12:06 EC100.dgn  
 LAYOUT PJT 07/14/06  
 DRAWN ANC 07/14/06  
 REVIEWED PJT 07/14/06