

| | | | | |
|-----------------------|----------------|----------------------------|--------------|-----------|
| F.A.S. RTE. | SECTION | COUNTY | TOTAL SHEETS | SHEET NO. |
| 342 | 02-00208-01-BR | LIVINGSTON | 24 | 8 |
| STA. 171+70 | | TO STA. 174+70 | | |
| FED. ROAD DIST. NO. 7 | | ILLINOIS FED. AID PROJECT* | | |
| CONTRACT NO. 87283 | | SHEET NO. B3 | | |
| OF 16 SHEETS | | | | |

**PROPOSED CONTOUR
END LOCATIONS**

| LOCATION | ELEVATION | STATION | OFFSET |
|----------|-----------|---------|--------|
| 1 | 75 | 172+71 | 21' LT |
| 2 | 74 | 172+70 | 26' LT |
| 3 | 73 | 172+69 | 29' LT |
| 4 | 72 | 172+69 | 32' LT |
| 5 | 71 | 172+69 | 35' LT |
| 6 | 70 | 172+69 | 38' LT |
| 7 | 70 | 172+77 | 43' LT |
| 8 | 71 | 172+76 | 46' LT |
| 9 | 72 | 172+77 | 48' LT |
| 10 | 73 | 172+77 | 50' LT |
| 11 | 74 | 172+78 | 53' LT |
| 12 | 75 | 172+79 | 55' LT |
| 13 | 75 | 172+84 | 66' LT |
| 14 | 74 | 172+88 | 67' LT |
| 15 | 73 | 172+90 | 71' LT |
| 16 | 72 | 172+93 | 72' LT |
| 17 | 71 | 172+96 | 75' LT |
| 18 | 70 | 172+99 | 78' LT |
| 19 | 69 | 173+02 | 88' LT |
| 20 | 68 | 173+05 | 88' LT |
| 21 | 67 | 173+06 | 91' LT |
| 22 | 67 | 173+24 | 72' LT |
| 23 | 68 | 173+31 | 52' LT |
| 24 | 69 | 173+32 | 54' LT |
| 25 | 70 | 173+33 | 56' LT |
| 26 | 71 | 173+34 | 59' LT |
| 27 | 72 | 173+36 | 59' LT |
| 28 | 73 | 173+38 | 59' LT |
| 29 | 74 | 173+41 | 60' LT |
| 30 | 75 | 173+43 | 61' LT |
| 31 | 75 | 173+49 | 61' LT |
| 32 | 75 | 173+81 | 30' LT |
| 33 | 76 | 172+80 | 19' RT |
| 34 | 75 | 172+88 | 22' RT |
| 35 | 74 | 172+90 | 25' RT |
| 36 | 73 | 172+92 | 27' RT |
| 37 | 72 | 172+93 | 30' RT |
| 38 | 71 | 172+93 | 33' RT |
| 39 | 71 | 172+91 | 37' RT |
| 40 | 72 | 172+92 | 40' RT |
| 41 | 73 | 172+93 | 43' RT |
| 42 | 73 | 173+09 | 60' RT |
| 43 | 72 | 173+19 | 59' RT |
| 44 | 71 | 173+26 | 56' RT |
| 45 | 70 | 173+39 | 58' RT |
| 46 | 69 | 173+41 | 57' RT |
| 47 | 68 | 173+45 | 55' RT |
| 48 | 67 | 173+53 | 61' RT |
| 49 | 66 | 173+49 | 54' RT |
| 50 | 65 | 173+54 | 57' RT |
| 51 | 65 | 173+64 | 55' RT |
| 52 | 66 | 173+66 | 56' RT |
| 53 | 67 | 173+71 | 61' RT |
| 54 | 68 | 173+72 | 60' RT |
| 55 | 69 | 173+74 | 58' RT |
| 56 | 70 | 173+76 | 58' RT |
| 57 | 71 | 173+78 | 58' RT |
| 58 | 72 | 173+83 | 58' RT |
| 59 | 73 | 173+86 | 49' RT |
| 60 | 73 | 173+91 | 38' RT |
| 61 | 72 | 172+92 | 33' RT |
| 62 | 72 | 173+94 | 32' RT |
| 63 | 73 | 173+95 | 29' RT |
| 64 | 74 | 173+96 | 26' RT |
| 65 | 75 | 173+95 | 23' RT |
| 66 | 76 | 173+98 | 19' RT |

Note: Stations and offsets for the proposed contour end locations are from the roadway centerline.

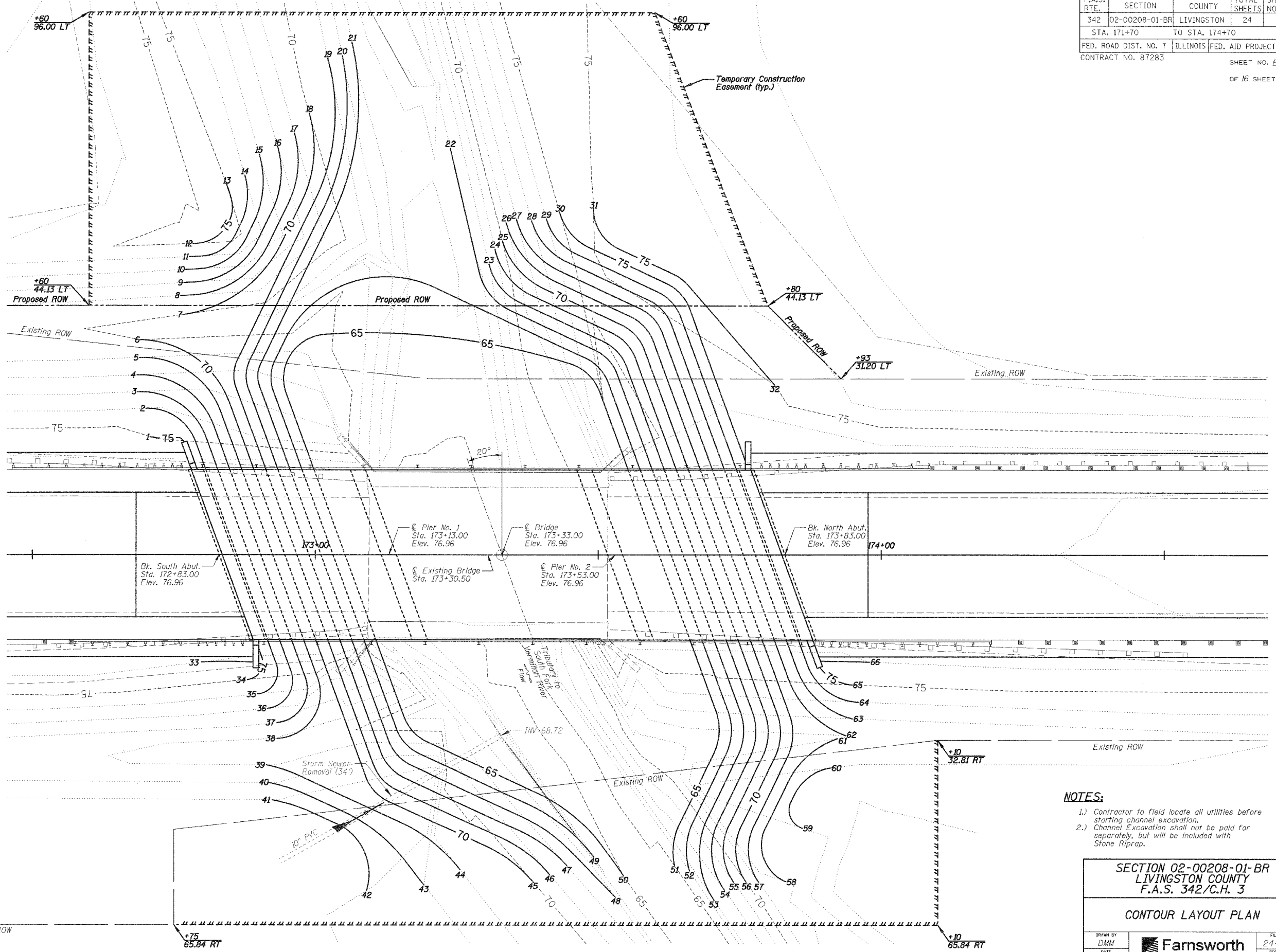

- NOTES:**
- 1.) Contractor to field locate all utilities before starting channel excavation.
 - 2.) Channel Excavation shall not be paid for separately, but will be included with Stone Riprap.

**SECTION 02-00208-01-BR
LIVINGSTON COUNTY
F.A.S. 342/C.H. 3**

CONTOUR LAYOUT PLAN

| | | |
|--|---|---|
| DRAWN BY DMM DATE 12/01/06 CHECKED BY MSW | <p>2700 Woodrow Drive Bloomington, Illinois 61704 309/898-6626 309/898-1271 fax</p> | FILE NO. 24-7131 BOOK NO. 2606 SHEET NO. 8 OF 24 |
|--|---|---|