

HALF SECTION NEAR ABUTMENTS  
\*At  $\frac{1}{2}$  of Bridge

HALF SECTION NEAR PIERS  
\*At  $\frac{1}{2}$  of Bridge

**SUPERSTRUCTURE  
BILL OF MATERIALS**

Bar	No.	Size	Length	Shape
a	66	#5	19'-2"	—
a1	66	#8	35'-8"	—
a2	64	#8	18'-6"	—
a3	54	#7	22'-8"	—
a4	27	#7	27'-0"	—
a5	56	#7	31'-11"	—
a6	28	#7	40'-3"	—
a7	12	#8	22'-8"	—
a8	6	#8	28'-6"	—
a9	8	#8	32'-10"	—
a10	4	#8	40'-3"	—
b	148	#5	29'-8"	—
b1	7	#5	29'-0"	—
b2	10	#5	29'-0"	—
s2	282	#4	6'-10 $\frac{1}{2}$ "	□
Item	Unit	Quantity		
Concrete Superstructure	Cu. Yd.	164.9		
Bridge Deck Grooving	Sq. Yd.	308		
Protective Coat	Sq. Yd.	330		
Reinforcement Bars, Epoxy Coated	Pound	29,420		

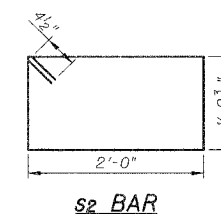
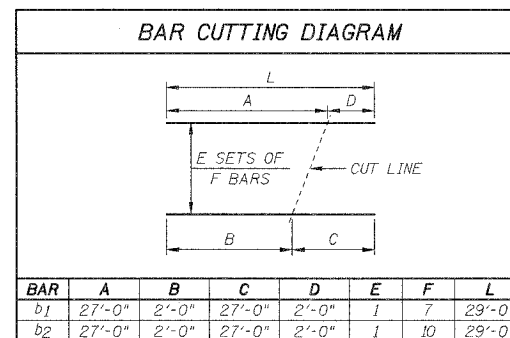

SECTION 02-00208-01-BR  
LIVINGSTON COUNTY  
F.A.S. 342/C.H. 3

**SUPERSTRUCTURE CROSS SECTION**

DRAWN BY DMM	 2709 Meadow Drive Bloomington, Illinois 61704 309/888-8436, 309/883-1871 fax	FILE NO. 24-7131
DATE 12/01/06		BOOK NO. 2606
CHECKED BY MSW		SHEET NO. 10 OF 24