

ROUTE NO.	SECTION	COUNTY	TOTAL SHEETS	SHEET NO.
T.R. 189	01-1127-00-BR	IROQUOIS	20	4
ROAD DIST.	ILLINOIS	DOUGLAS		

CONTRACT NO. 87287

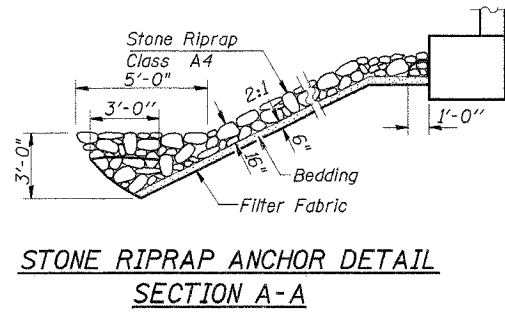
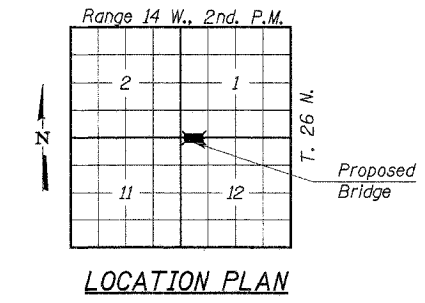
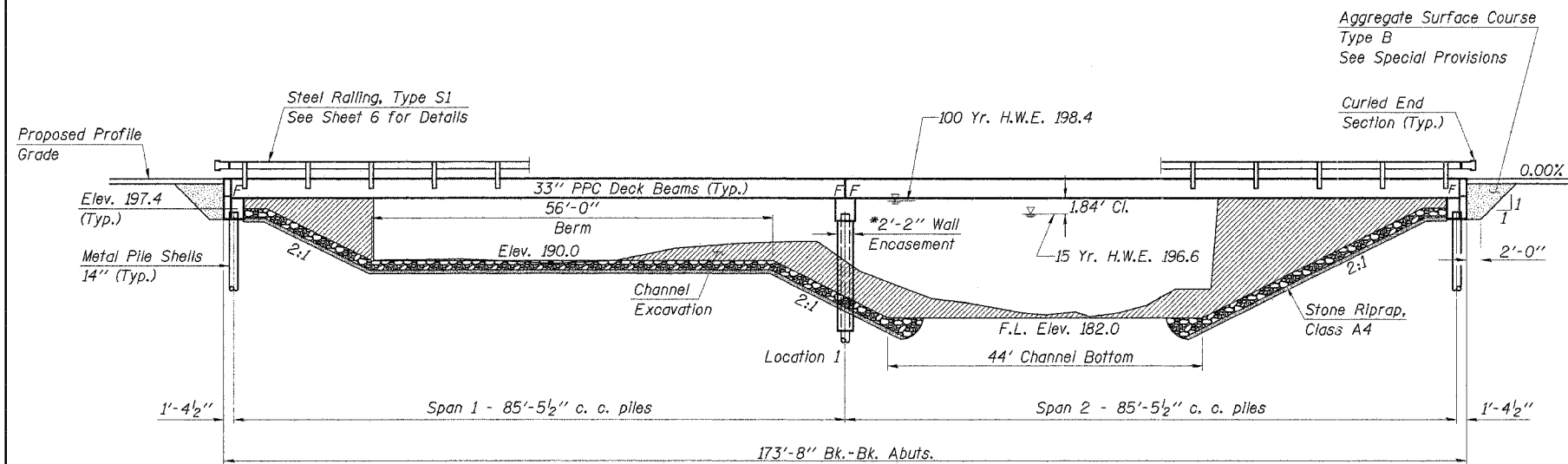

GENERAL NOTES

See sheets 10, 11, 12 & 13 for Boring data.

Reinforcement bars shall conform to the requirements of ASTM A706 Grade 60 (IL Modified). See Special Provisions.

The Contractor shall drive one steel test pile in a permanent location at each abutment and at the Pier as directed by the Engineer, before ordering the remainder of piles.

Layout of slope protection system may be varied in the field to suit ground conditions as directed by the Engineer.

Aggregate Surface Course, Ty. B shall be used to backfill behind each abutment as indicated by the Engineer. The additional quantity of CA-10 is included in the total quantity for Aggregate Surface Course, Ty. B. (See Special Provisions).

**SPRING CREEK
BUILT 200_ BY
DOUGLAS ROAD DISTRICT
IROQUOIS COUNTY
SEC. 01-1127-00-BR
F.A. PROJ. BROS-075(126)
STR. NO. 038-4056 LOADING HS20**

LETTERING FOR NAME PLATE
See Std. 515001

TOTAL BILL OF MATERIAL

ITEM	UNIT	SUPER	SUB	TOTAL
Precast Prestressed Concrete Deck Beams (33" Depth)	Sq. Ft.	5160		5160
Concrete Structures	Cu. Yd.		72.4	72.4
Reinforcement Bars	Pound		6510	6510
Steel Railing, Type S1	Foot	344		344
Name Plates	Each		1	1
Metal Shell Piles 14"	Foot		1061	1061
Test Pile Metal Shells	Each		3	3
Stone Riprap, Class A4	Ton		475	475
Filter Fabric	Sq. Yd.		637	637
Aggregate Surface Course, Type B	Ton		111	111
Underwater Structure Excavation Protection-Location 1	Each		1	1

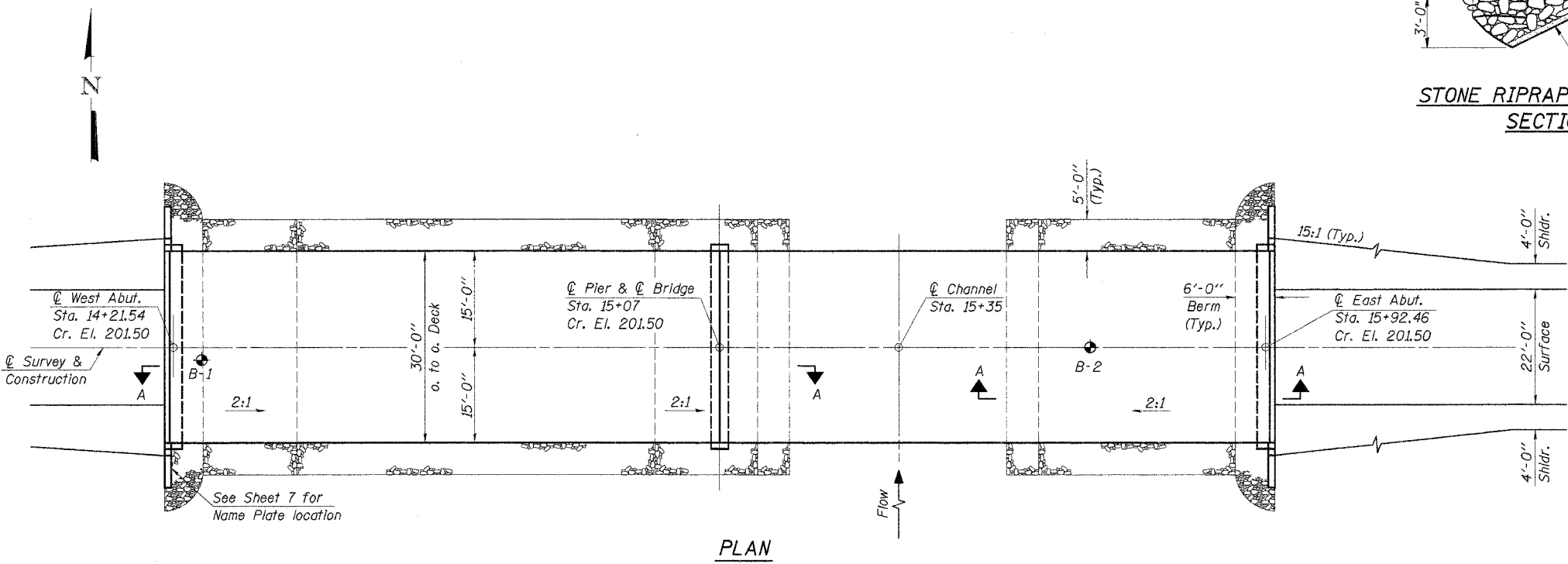

Note: IDNR - Office of Water Resources has issued Permit No. DS2005014 for construction of this project.

DESIGN STRESSES

$f'_c = 5,000$ p.s.i. (Prestressed Beams)
 $f'_{el} = 4,000$ p.s.i. (Prestressed Beams)
 $f_c = 1,400$ p.s.i. (Concrete)
 $f'_s = 270,000$ p.s.i. (Prestressed Strands)
 $f_{sl} = 201,960$ p.s.i. (Prestressed Strands)
 $f_s = 24,000$ p.s.i. (Reinf. Bars -- Field Units)
 $f_y = 60,000$ p.s.i. (Reinf. Bars -- Field Units)
 $n = 9$ (Concrete)
 LOADING HS20-44
 Design Specifications: 2002 AASHTO
 25#/Sq. Ft. Included in dead load for future wearing surface.

WATERWAY INFORMATION

Drainage Area	156.36 Sq. Mi.
Existing Opening (15 Yr.)	957 Sq. Ft.
Required Opening (15 Yr.)	1428 Sq. Ft.
Proposed Opening (15 Yr.)	1428 Sq. Ft.
Design Discharge (15 Yr.)	4167 C.F.S.
Created Head (15 Yr.)	0.1 Ft.
100 Year Discharge	6129 C.F.S.
100 Yr. Created Head	0.1 Ft.

DESIGNED	SFM
CHECKED	FJS
DRAWN	SAP
CHECKED	SFM

"I certify that to the best of my knowledge, information and belief, this bridge design is structurally adequate for the design loading shown on the plans. The design is an economical one for the style of structure and complies with requirements of the current 'AASHTO Standard Specifications for Highway Bridges'."



ILLINOIS STRUCTURAL NO. 2934 (Expires 11/30/08)

GENERAL PLAN & ELEVATION

**SECTION 01-1127-00-BR
DOUGLAS ROAD DISTRICT
IROQUOIS COUNTY
STA. 15+07**

4440 ASH GROVE SPRINGFIELD, IL 62711 (217) 793-8600 www.fehr-graham.com	FEHR-GRAHAM & ASSOCIATES, LLC ENGINEERING AND SCIENCE CONSULTANTS PREPARED BY: SPRINGFIELD, IL	JOB NO.: 46816 FILE: GPE_DGN DATE: 12/08/06
--	---	---