

S.E. 1/4, SECTION 6, T. 28 N., R. 14 W., 2nd P.M.
KENNETH HANSEN & JULIA HANSEN

ROUTE	SECTION	COUNTY	TOTAL SHEETS	SHEET NO.
C.H. 4	04-00034	ILLINOIS	16	4
FAS 321-04-BR		ILLINOIS		
STA. 136+25.00		TO STA. 141+75.00		
ROAD DISTRICT		ILLINOIS		
		PROJ. BR-321131		
CONTRACT NO. 87299				

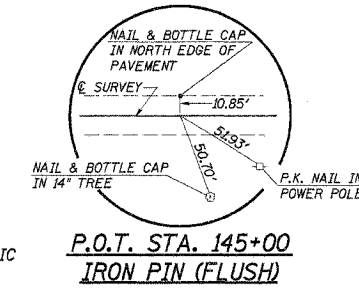
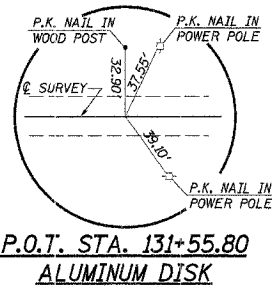

PIPES TO BE REMOVED
RT. STA. 139+75, CMP 12" FIELD TILE
RT. STA. 140+05, 18" CMP, 24' LONG
LT. STA. 140+52 TO 141+50, 4" PLASTIC PIPE, 98' LONG
QUANTITIES INCLUDED IN "EARTH EXCAVATION".

ENTRANCES TO BE BUILT
RT. STA. 141+00, F.E. -10.0%, 28' ROADBED
QUANTITIES INCLUDED IN THOSE LISTED

ALUMINUM DISK
@ STA. 131+55.80
E. 1/4 COR., SEC. 6
T. 28 N., R. 14 W., 2ND P.M.

ALUMINUM DISK
STA. 158+05.8
CENTER SEC. 6
T. 28 N., R. 14 W., 2ND P.M.

CHANNEL EXCAVATION
THE CHANNEL SHALL BE EXCAVATED AS SHOWN WITHIN THE LIMITS OF THE PROPOSED STRUCTURE THEN TAPER TO THE EXISTING CHANNEL AT THE R.O.W. LINES. SUITABLE EXCAVATED MATERIAL TO BE USED IN THE EMBANKMENT AS DIRECTED BY THE ENGINEER.
CHANNEL EXCAVATION = 284 CU. YD.



KEVIN P. ELLIOT & CAROL J. ELLIOT

VIRGIL HANSEN FARMS, INC.

EXISTING STRUCTURE NO. 038-0052
PRECAST CONCRETE SLAB BRIDGE ON CONCRETE PILE BENT PIERS AND CREOSOTED TIMBER PILE BENT SPILL-THRU ABUTMENTS, WITH CONCRETE SLOPE WALLS; 3 SPANS @ 24'-0", 30'-0", 24'-0"; 78'-11" BK.-BK. ABUTMENTS 26'-2" O.-O., 0° SKEW. (SEE SPECIAL PROVISIONS)
REMOVAL OF EXISTING STRUCTURES = L. SUM

OVERHEAD POWER
EASTERN ILLINI ELECTRIC COOP.
P.O. BOX 96
PAXTON, IL 60957
BILL HOFFSHNEIDER
217-379-2131 EXT. 155

BURIED CABLE
VERIZON NORTH, INC
1312 E. EMPIRE
BLOOMINGTON, IL 61701
JONNA FRICKE
309-663-3422

N.E. 1/4, SECTION 6, T. 28 N., R. 14 W., 2nd P.M.

