

F.A.S. NO.	SECTION	COUNTY	TOTAL SHEETS
418	04-00069-00-RS	HENDERSON	16
FED. ROAD DIST. NO. ILLINOIS FED. AID PROJECT			

INDEX OF SHEETS

- 1 Cover Sheet
- 2 Summary of Quantities / General Notes
- 3 Existing Typical Sections
- 4-7 Proposed Typical Sections
- 8-9 Schedules
- 10 Project Centerline Plan
- 11 Entrance & Mailbox Details
- 12 Butt Joint Details
- 13 Sideroad Details
- 14-15 Intersection Detail Sheets
- 16 Storm Water Pollution Prevention Plan

LIST OF STANDARDS

- Standard 000001-04 Standard Symbols, Abbreviations and Patterns
- Standard 542306-01 Precast Reinforced Concrete Elliptical Flared End Section
- Standard 630001-07 Steel Plate Beam Guardrail
- Standard 630301-04 Shoulder Widening for Type 1 (Special) Guardrail Terminals
- Standard 635006-02 Reflector and Terminal Marker Placement
- Standard 701006-02 Off-Road Operations, 2L, 2W, 4.5 m (15') to 600 mm (24") from Pavement Edge
- Standard 701011-01 Off-Road Moving Operations, 2L, 2W, Day Only
- Standard 701201-02 Lane Closure, 2L, 2W, Day Only, For Speeds > 45 mph
- Standard 701306-01 Lane Closure, 2L, 2W, Slow Moving Operations Day Only, for Speeds > 45 mph
- Standard 701311-02 Lane Closure, 2L, 2W Moving Operations - Day Only
- Standard 702001-06 Traffic Control Devices
- Standard 780001-01 Typical Pavement Markings
- Standard BLR 14-9 Portland Cement Concrete Pavement
- Standard BLR 24-1 Mailbox Turnout for Local Roads

STATE OF ILLINOIS
DEPARTMENT OF TRANSPORTATION
DIVISION OF HIGHWAYS
**PLANS FOR PROPOSED
LOCAL AGENCY IMPROVEMENT**

**ROADWAY IMPROVEMENTS
VANTINE ROAD (F.A.S. 418)
SECTION 04-00069-00-RS
GLADSTONE ROAD DISTRICT
HENDERSON COUNTY
PROJECT NO. RS-0418(110)
C-94-067-05**

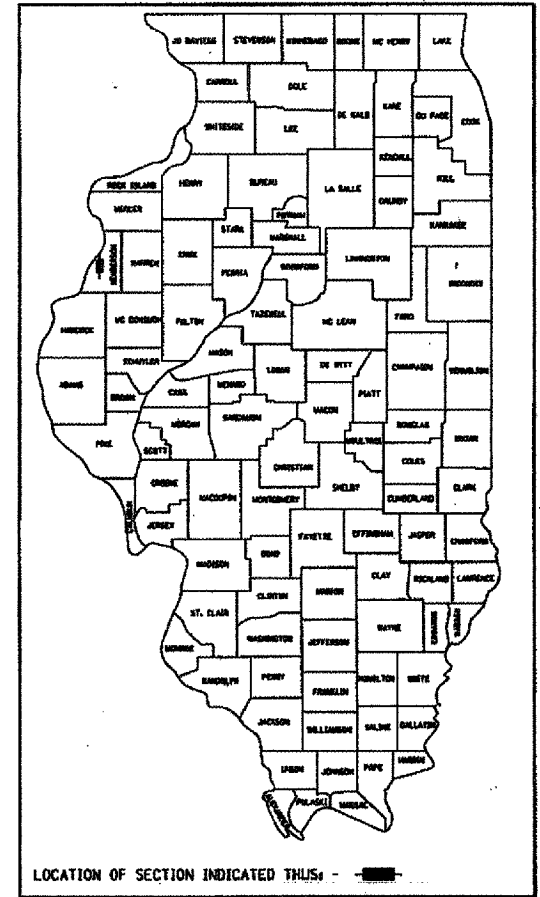

ROADWAY CLASSIFICATION: COLLECTOR
CURRENT ADT = <750
DESIGN YEAR ADT = 750
DESIGN SPEED: 50 MPH
DESIGN GUIDELINES: 3R
VARIANCES GRANTED: YES
COMMITMENTS: NONE

JOINT UTILITY LOCATING INFORMATION FOR EXCAVATORS
J.U.L.I.E. Telephone No. Toll Free 1-800-892-0123

CONTRACT NO. : 89366

URS
345 EAST ASH AVENUE, SUITE B
DECATUR, ILLINOIS 62526
PH. 217-875-4800

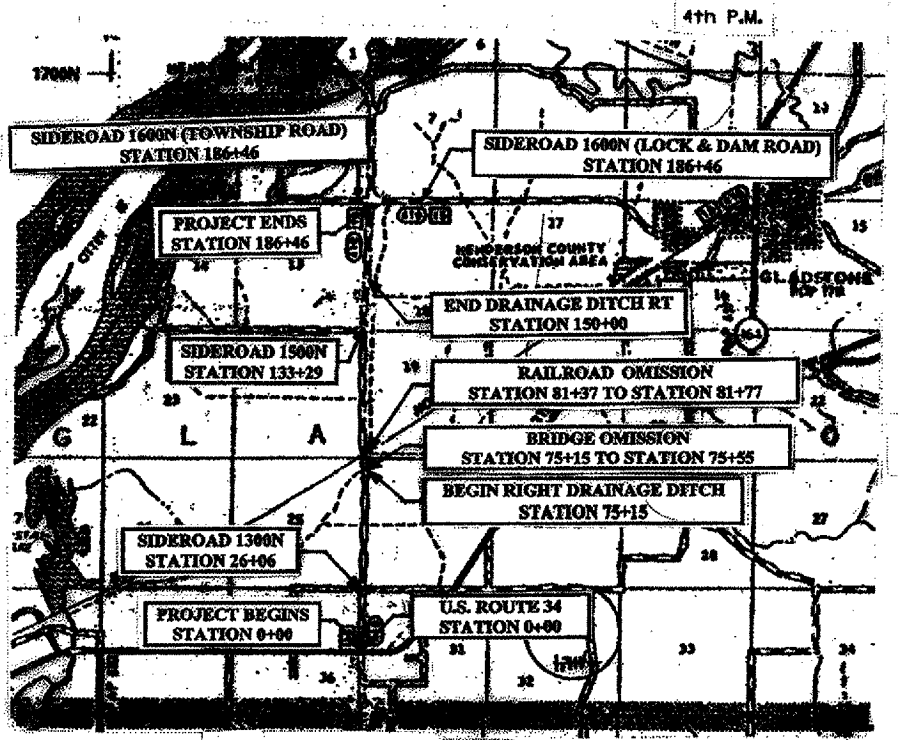

LAYOUT

Approximate Scale: miles
Total and Net Length of Improvement 18,646 Feet = 3.53 Miles

APPROVED 12 Nov 2006 Robert J. Williams COUNTY ENGINEER

APPROVED _____ 20____ ROAD COMMISSIONER

PASSED 11 JANUARY 2007 John Laballe DISTRICT FOUR ENGINEER OF LOCAL ROADS & STREETS

Releasing For Bid Based on Limited Review 12 January 2007 J.E. Cramer DEPUTY DIRECTOR OF HIGHWAYS, REGION THREE ENGINEER

STATE OF ILLINOIS DEPARTMENT OF TRANSPORTATION

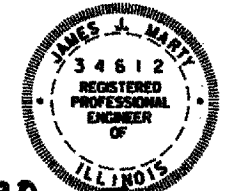

Exp 11-30-07
James J. Martz
Illinois Professional No. 34612

1-5-07
Date

F.A.S. RTE.	SECTION	COUNTY	TOTAL SHEETS	SHEET NO.
418	04-00069-00-RS	HENDERSON	15	2
STA.		TO STA.		
FED. ROAD DIST. NO.		ILLINOIS FED. AID PROJECT		
CONTRACT NO. 89366				

SUMMARY OF QUANTITIES

<u>ITEM</u>	<u>UNIT</u>	<u>QUANTITY</u>
20200100 EARTH EXCAVATION	CU YD	332
20201400 SUB-BASE GRANULAR MATERIAL, TYPE A	TON	131
20400800 FURNISHED EXCAVATION	CU YD	3339
20800150 TRENCH BACKFILL	CU YD	14.9
40200800 AGGREGATE SURFACE COURSE, TYPE B	TON	192.8
40600100 BITUMINOUS MATERIALS (PRIME COAT)	GALLON	3791.8
40600300 AGGREGATE (PRIME COAT)	TON	142.4
40600982 HOT-MIX ASPHALT SURFACE REMOVAL - BUTT JOINT	SO YD	863
40603085 HOT-MIX ASPHALT BINDER COURSE, IL-19.0, N70	TON	7298.7
40603340 HOT-MIX ASPHALT SURFACE COURSE, MIX "D", N70	TON	5512.9
42000301 PORTLAND CEMENT CONCRETE PAVEMENT 8" (JOINTED)	SO YD	556
42001300 PROTECTIVE COAT	SO YD	1112
44000100 PAVEMENT REMOVAL	SO YD	1046
44000200 DRIVEWAY PAVEMENT REMOVAL	SO YD	117
48101200 AGGREGATE SHOULDERS, TYPE B	TON	2441.8
* 50105210 REMOVE EXISTING CULVERTS	FOOT	46
54207165 PIPE CULVERTS, TYPE I, REINFORCED CONCRETE - ELLIPTICAL, EQUIVALENT ROUND-SIZE 30"	FOOT	52
54214725 PRECAST REINFORCED CONCRETE FLARED END SECTIONS - ELLIPTICAL, EQUIVALENT ROUND-SIZE 30"	EACH	2
△ 63000000 STEEL PLATE BEAM GUARD RAIL, TYPE A	FOOT	7650
△ 63100075 TRAFFIC BARRIER TERMINAL, TYPE 5A	EACH	1
△ 63100167 TRAFFIC BARRIER TERMINAL TYPE I, SPECIAL (TANGENT)	EACH	10
67100100 MOBILIZATION	L SUM	1
* 70103700 TRAFFIC CONTROL COMPLETE	L SUM	1
70300100 SHORT-TERM PAVEMENT MARKING	FOOT	24376
70301000 WORK ZONE PAVEMENT MARKING REMOVAL	SO FT	4059
△ 78001100 PAINT PAVEMENT MARKING - LETTERS AND SYMBOLS	SO FT	122
△ 78001110 PAINT PAVEMENT MARKING - LINE 4"	FOOT	51746
△ 78001180 PAINT PAVEMENT MARKING - LINE 24"	FOOT	60
△ 78201000 TERMINAL MARKER - DIRECT APPLIED	EACH	10
20048665 RAILROAD PROTECTIVE LIABILITY INSURANCE	L SUM	1

* SEE SPECIAL PROVISIONS

△ SPECIALTY ITEMS

GENERAL NOTES

IT SHALL BE THE CONTRACTOR'S RESPONSIBILITY TO DETERMINE THE ACTUAL LOCATION OF ALL UNDERGROUND UTILITY FACILITIES. HE SHALL ALSO OBTAIN FROM THE RESPECTIVE UTILITY COMPANIES DETAILED INFORMATION RELATIVE TO THE LOCATION OF THEIR FACILITIES AND THE WORKING SCHEDULES OF THE UTILITY COMPANIES FOR THEIR MARKING OF THE EXACT LOCATION.

THE LOCAL AGENCY WILL DETERMINE AND HANDLE ALL NECESSARY TEMPORARY AND PERMANENT EROSION CONTROL MEASURES DURING CONSTRUCTION ACCORDING TO THE STORM WATER POLLUTION PREVENTION PLAN.

A QUANTITY OF 1 LUMP SUM HAS BEEN PROVIDED FOR RAILROAD PROTECTIVE LIABILITY INSURANCE.

RAILROAD FLAGGERS SHALL BE UTILIZED IN ACCORDANCE WITH SECTION 107.12 OF THE STANDARD SPECIFICATIONS FOR ROAD AND BRIDGE CONSTRUCTION, WHEN APPLICABLE DURING CONSTRUCTION. THE CONTRACTOR SHALL PAY THE COSTS OF RAILROAD FLAGGERS REQUIRED FOR TRANSPORTING MATERIAL AND EQUIPMENT ACROSS THE TRACKS. ALL OTHER RAILROAD COSTS FOR SHALL BE PAID FOR AS EXTRA WORK ACCORDING TO SECTION 109.04(b)(7) OF THE STANDARD SPECIFICATIONS FOR ROAD AND BRIDGE CONSTRUCTION.

APPLICATION RATES

GRANULAR MATERIALS	2.05	TONS/CU. YD.
BITUMINOUS SURFACE & BINDER COURSES	112	LBS./SQ. YD./IN.
BITUMINOUS MATERIALS (PRIME COAT)	0.05	GAL./SQ. YD. (ON EXISTING PAVEMENT)
	0.03	GAL./SQ. YD. (FOG COAT ON NEW BINDER)
AGGREGATE (PRIME COAT)	4	LBS./SQ. YD. (ON EXISTING PAVEMENT)
	2	LBS./SQ. YD. (FOG COAT ON NEW BINDER)

REVISIONS		ILLINOIS DEPARTMENT OF TRANSPORTATION F.A.S. 408 (VANTINE ROAD) SUMMARY OF QUANTITIES & GENERAL NOTES SCALE: N/A DATE: 1-5-07 DRAWN BY: CGF CHECKED BY: JLM
NO.	DATE	

F.A.S. RTE.	SECTION	COUNTY	TOTAL SHEETS	SHEET NO.
41B	04-00069-00-RS	HENDERSON	15	3
STA.		TO STA.		
FED. ROAD DIST. NO.	ILLINOIS	FED. AID PROJECT		
CONTRACT NO. 89366				

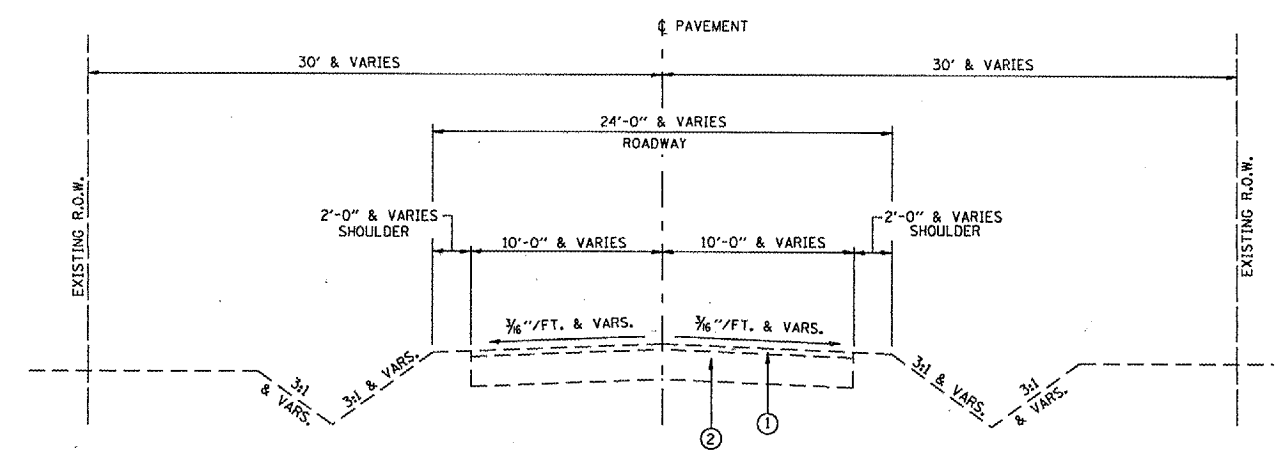

EXISTING TYPICAL SECTION

* STA. 0+00 TO 75+15
 ** STA. 155+00 TO 186+46

- ① OIL & CHIP SURFACE COURSE
 * (VARIES FROM 4.0" TO 6.0")
 ** (VARIES FROM 3.0" TO 4.25")
- ② AGGREGATE BASE COURSE
 * (VARIES FROM 3.0" TO 5.5")
 ** (VARIES FROM 6.0" TO 9.0")

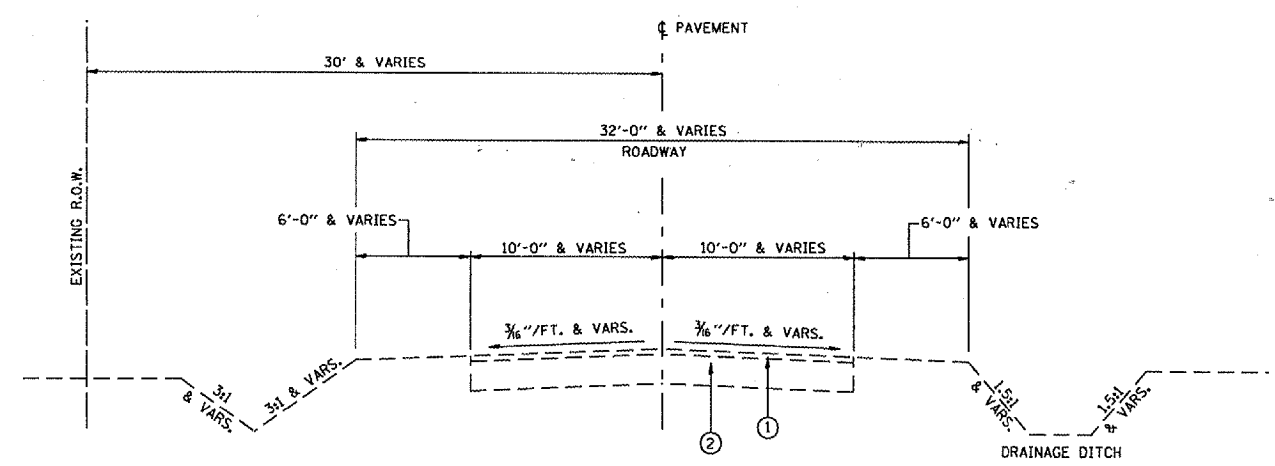

EXISTING TYPICAL SECTION

* STA. 75+15 TO 155+00

- ① OIL & CHIP SURFACE COURSE
 * (VARIES FROM 3.0" TO 7.0")
- ② AGGREGATE BASE COURSE
 * (VARIES FROM 3.0" TO 7.0")

REVISIONS	
NAME	DATE

ILLINOIS DEPARTMENT OF TRANSPORTATION
 F.A.S. 41B (VANTINE ROAD)

EXISTING TYPICAL SECTIONS

SCALE: N/A
 DATE: 1-5-07
 DRAWN BY: CGF
 CHECKED BY: JJM

F.A.S. RTE.	SECTION	COUNTY	TOTAL SHEETS	SHEET NO.
41B	04-00069-00-RS	HENDERSON	15	4
STA.		TO STA.		
FED. ROAD DIST. NO.		ILLINOIS FED. AID PROJECT		
CONTRACT NO. 89366				

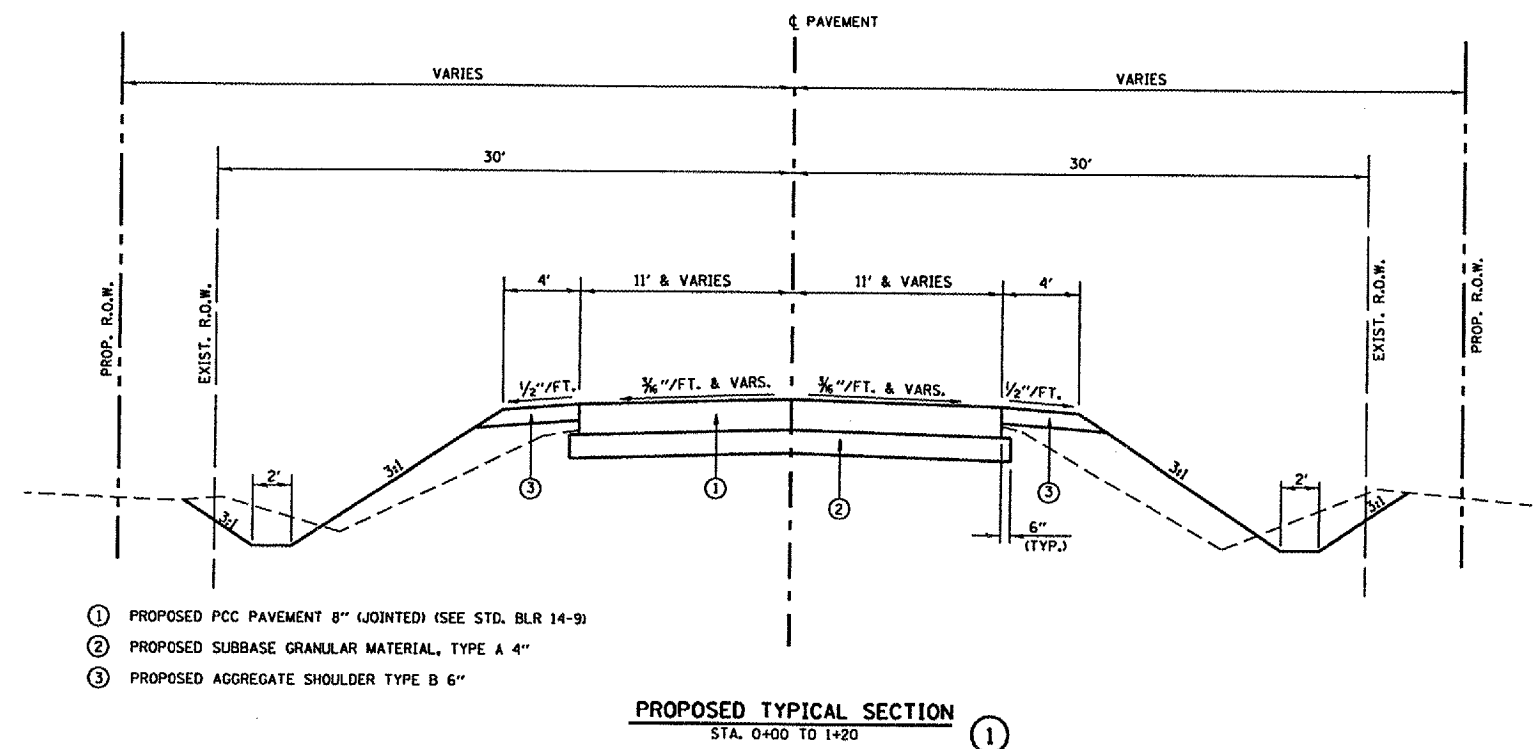

PAVEMENT DESIGN - RIGID (80,000 LB VEHICLE)

DP = 20 YR.
 ADT₍₂₀₂₅₎ = 750; PV=660, SU=53, MU=38
 CLASS III ROAD, E_(RI) = 3ksi
 TF_(ACTUAL) = 0.29
 TF_(MIN.) = 0.50

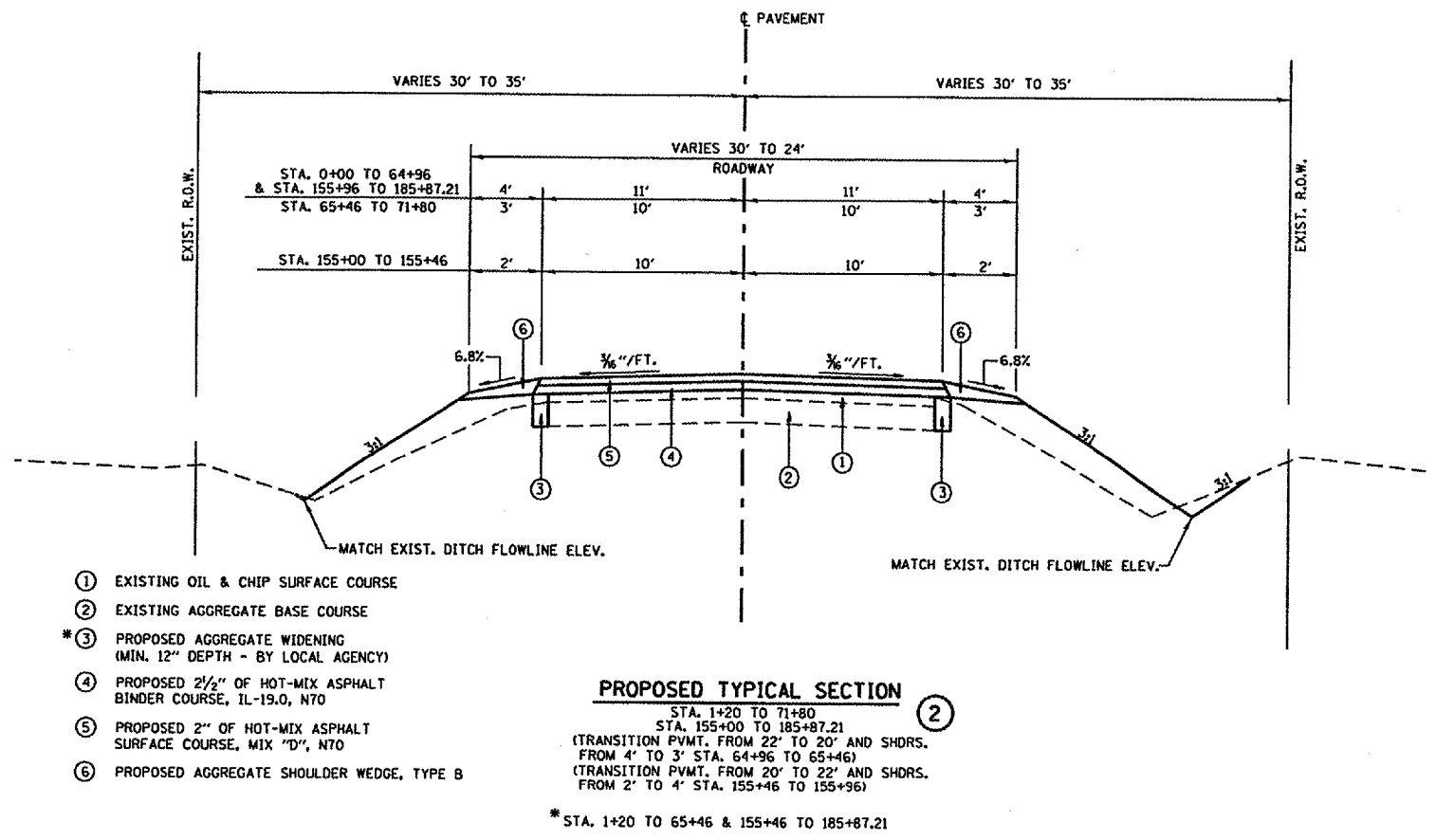

PAVEMENT DESIGN - FLEXIBLE (80,000 LB VEHICLE)

DP = 20 YR.
 ADT₍₂₀₂₅₎ = 750; PV=660, SU=53, MU=38
 CLASS III ROAD, E_(RI) = 3ksi
 TF = 0.20

BITUMINOUS MIXTURE REQUIREMENTS

LOCATION	FAS 41B	FAS 41B
MIX USE	BINDER	SURFACE
AC/PG	PG 64-22	PG 64-22
RAP %	15	10
DESIGN VOIDS	4.0 @ N=70	4.0 @ N=70
MIXTURE COMPOSITION (GRAD. MIXTURE)	IL-19.0	IL-9.5 OR IL-12.0
FRICTION	N/A	MIX D (DOLOMITE ONLY)

REVISIONS	
NAME	DATE

ILLINOIS DEPARTMENT OF TRANSPORTATION
 F.A.S. 41B (VANTINE ROAD)

PROPOSED TYPICAL SECTIONS

SCALE: N/A
 DATE: 1-5-07
 DRAWN BY: CGF
 CHECKED BY: JJM

F.A.S. RTE.	SECTION	COUNTY	TOTAL SHEETS	SHEET NO.
418	04-00069-00-RS	HENDERSON	15	5
STA.		TO STA.		
FED. ROAD DIST. NO.	ILLINOIS	FED. AID PROJECT		
CONTRACT NO. 89366				

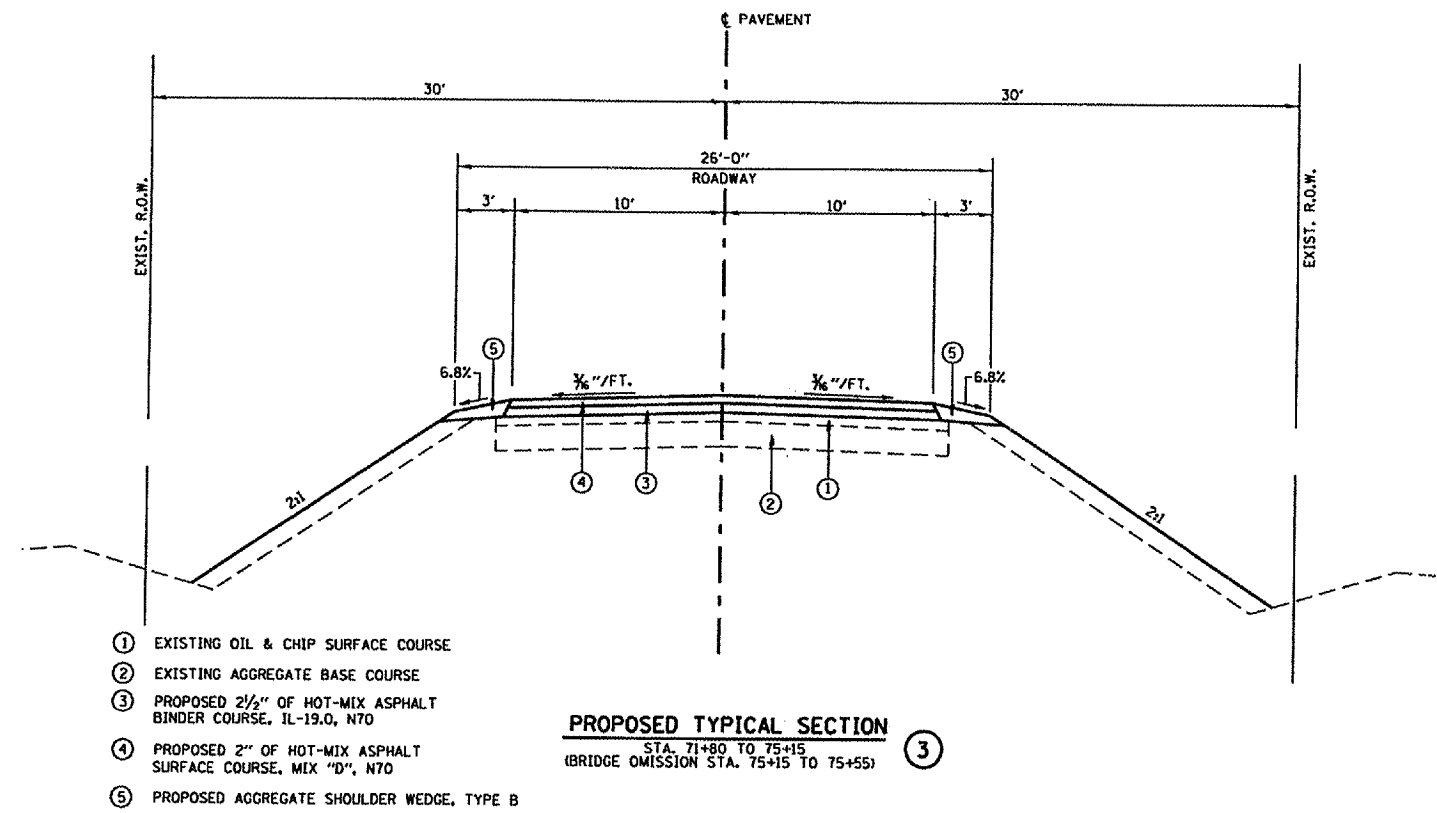

- ① EXISTING OIL & CHIP SURFACE COURSE
- ② EXISTING AGGREGATE BASE COURSE
- ③ PROPOSED 2 1/2" OF HOT-MIX ASPHALT BINDER COURSE, IL-19.0, N70
- ④ PROPOSED 2" OF HOT-MIX ASPHALT SURFACE COURSE, MIX "D", N70
- ⑤ PROPOSED AGGREGATE SHOULDER WEDGE, TYPE B

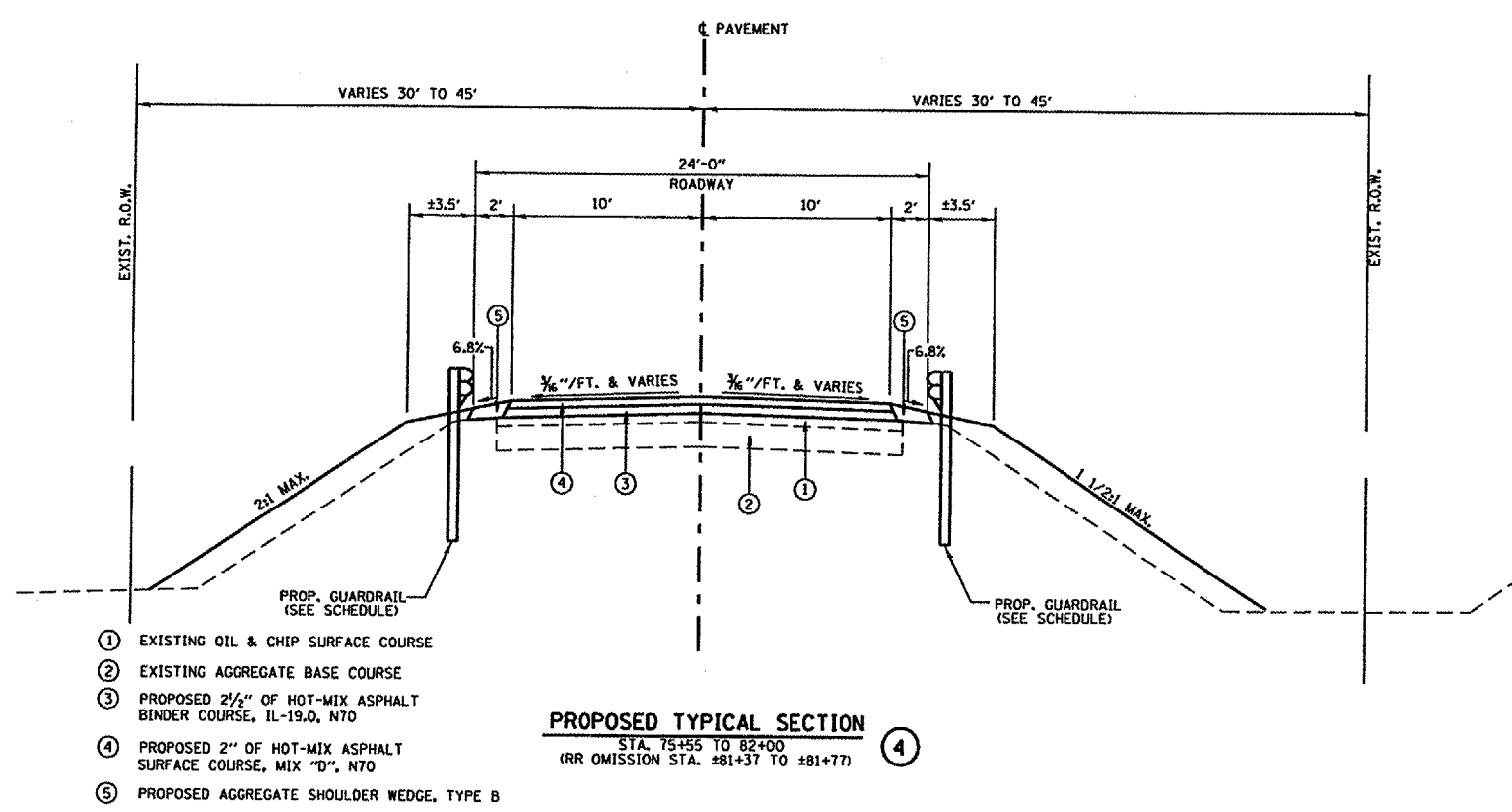

- ① EXISTING OIL & CHIP SURFACE COURSE
- ② EXISTING AGGREGATE BASE COURSE
- ③ PROPOSED 2 1/2" OF HOT-MIX ASPHALT BINDER COURSE, IL-19.0, N70
- ④ PROPOSED 2" OF HOT-MIX ASPHALT SURFACE COURSE, MIX "D", N70
- ⑤ PROPOSED AGGREGATE SHOULDER WEDGE, TYPE B

PAVEMENT DESIGN - FLEXIBLE (80,000 LB VEHICLE)

DP = 20 YR.
 ADT (2025) = 750; PV=660, SU=53, MU=38
 CLASS III ROAD, E_(RI) = 3ksi
 TF = 0.20

BITUMINOUS MIXTURE REQUIREMENTS

LOCATION	FAS 418	FAS 418
MIX USE	BINDER	SURFACE
AC/PG	PG 64-22	PG 64-22
RAP %	15	10
DESIGN VOIDS	4.0 @ N=70	4.0 @ N=70
MIXTURE COMPOSITION (GRAD. MIXTURE)	IL-19.0	IL-9.5 OR IL-12.0
FRICTION	N/A	MIX D (DOLOMITE ONLY)

REVISIONS	
NAME	DATE

ILLINOIS DEPARTMENT OF TRANSPORTATION
 F.A.S. 418 (VANTINE ROAD)

PROPOSED TYPICAL SECTIONS

SCALE: N/A
 DATE: 1-5-07
 DRAWN BY: CGF
 CHECKED BY: JUM

F.A.S. RTE.	SECTION	COUNTY	TOTAL SHEETS	SHEET NO.
418	04-00069-00-RS	HENDERSON	15	6
STA.		TO STA.		
FED. ROAD DIST. NO.	ILLINOIS	FED. AID PROJECT		
CONTRACT NO. 89366				

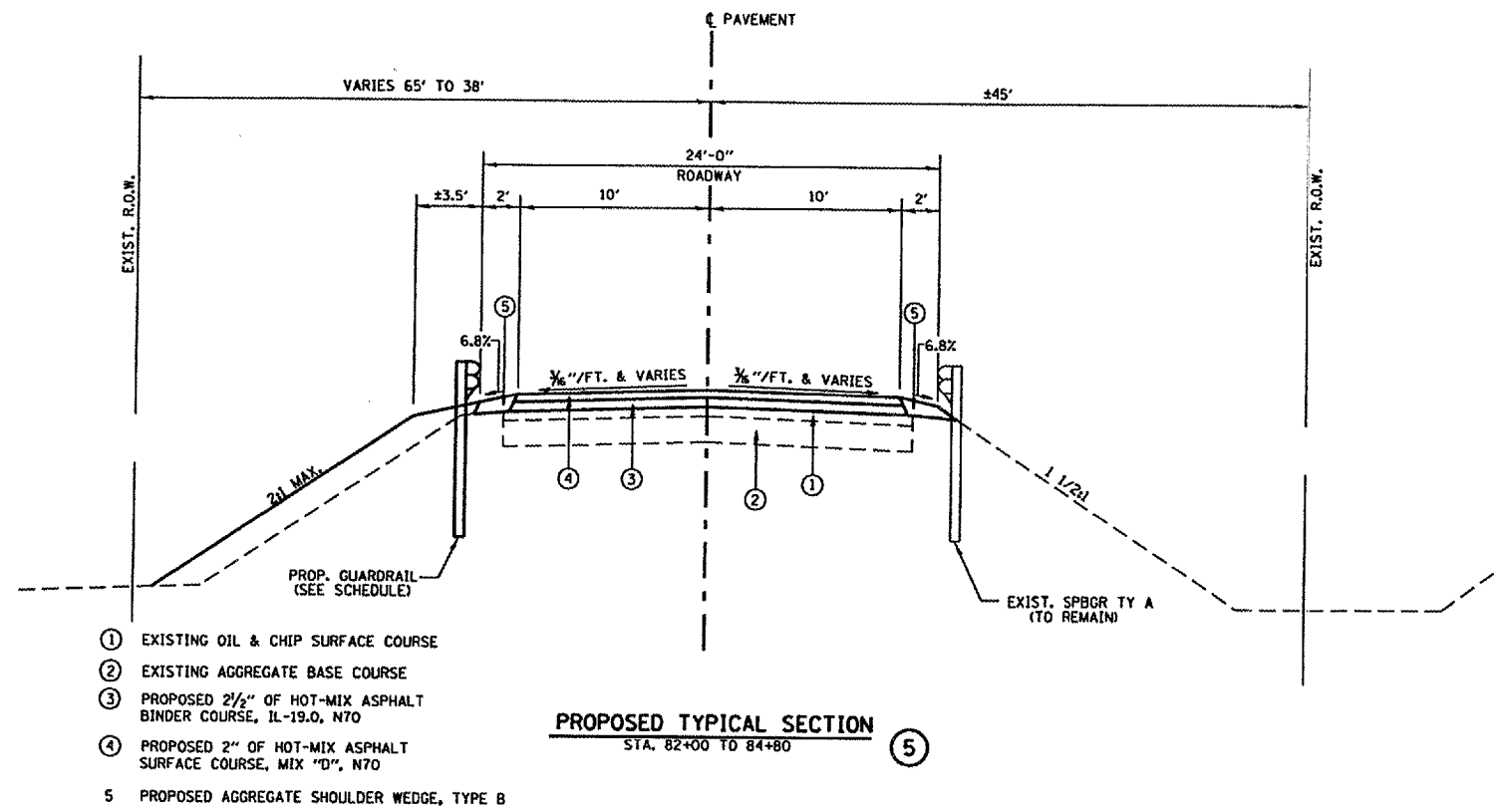

- ① EXISTING OIL & CHIP SURFACE COURSE
- ② EXISTING AGGREGATE BASE COURSE
- ③ PROPOSED 2 1/2" OF HOT-MIX ASPHALT BINDER COURSE, IL-19.0, N70
- ④ PROPOSED 2" OF HOT-MIX ASPHALT SURFACE COURSE, MIX "D", N70
- ⑤ PROPOSED AGGREGATE SHOULDER WEDGE, TYPE B

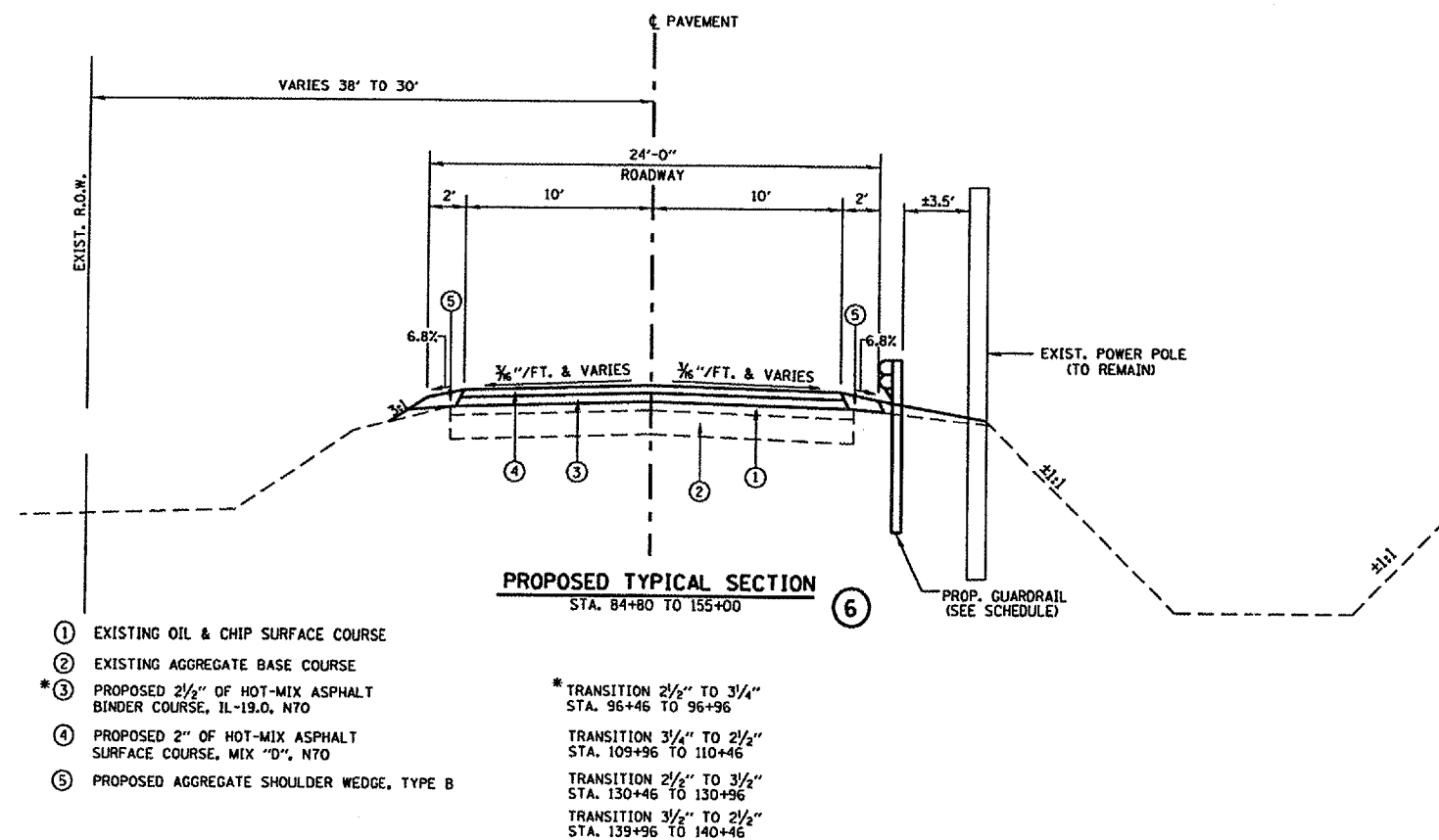

- ① EXISTING OIL & CHIP SURFACE COURSE
- ② EXISTING AGGREGATE BASE COURSE
- *③ PROPOSED 2 1/2" OF HOT-MIX ASPHALT BINDER COURSE, IL-19.0, N70
- ④ PROPOSED 2" OF HOT-MIX ASPHALT SURFACE COURSE, MIX "D", N70
- ⑤ PROPOSED AGGREGATE SHOULDER WEDGE, TYPE B

* TRANSITION 2 1/2" TO 3 1/4"
STA. 96+46 TO 96+96
TRANSITION 3 1/4" TO 2 1/2"
STA. 109+96 TO 110+46
TRANSITION 2 1/2" TO 3 1/4"
STA. 130+46 TO 130+96
TRANSITION 3 1/2" TO 2 1/2"
STA. 139+96 TO 140+46

PAVEMENT DESIGN - FLEXIBLE (80,000 LB VEHICLE)

DP = 20 YR.
ADT(2025) = 750; PV=660, SU=53, MU=38
CLASS III ROAD, E_(RI) = 3ksi
TF = 0.20

BITUMINOUS MIXTURE REQUIREMENTS

LOCATION	FAS 418	FAS 418
MIX USE	BINDER	SURFACE
AC/PG	PG 64-22	PG 64-22
RAP %	15	10
DESIGN VOIDS	4.0 @ N=70	4.0 @ N=70
MIXTURE COMPOSITION (GRAD. MIXTURE)	IL-19.0	IL-9.5 OR IL-12.0
FRICTION	N/A	MIX D (DOLOMITE ONLY)

REVISIONS	
NAME	DATE

ILLINOIS DEPARTMENT OF TRANSPORTATION
F.A.S. 418 (VANTINE ROAD)

PROPOSED TYPICAL SECTIONS

SCALE: N/A
DATE: 1-5-07
DRAWN BY: CCF
CHECKED BY: JJM

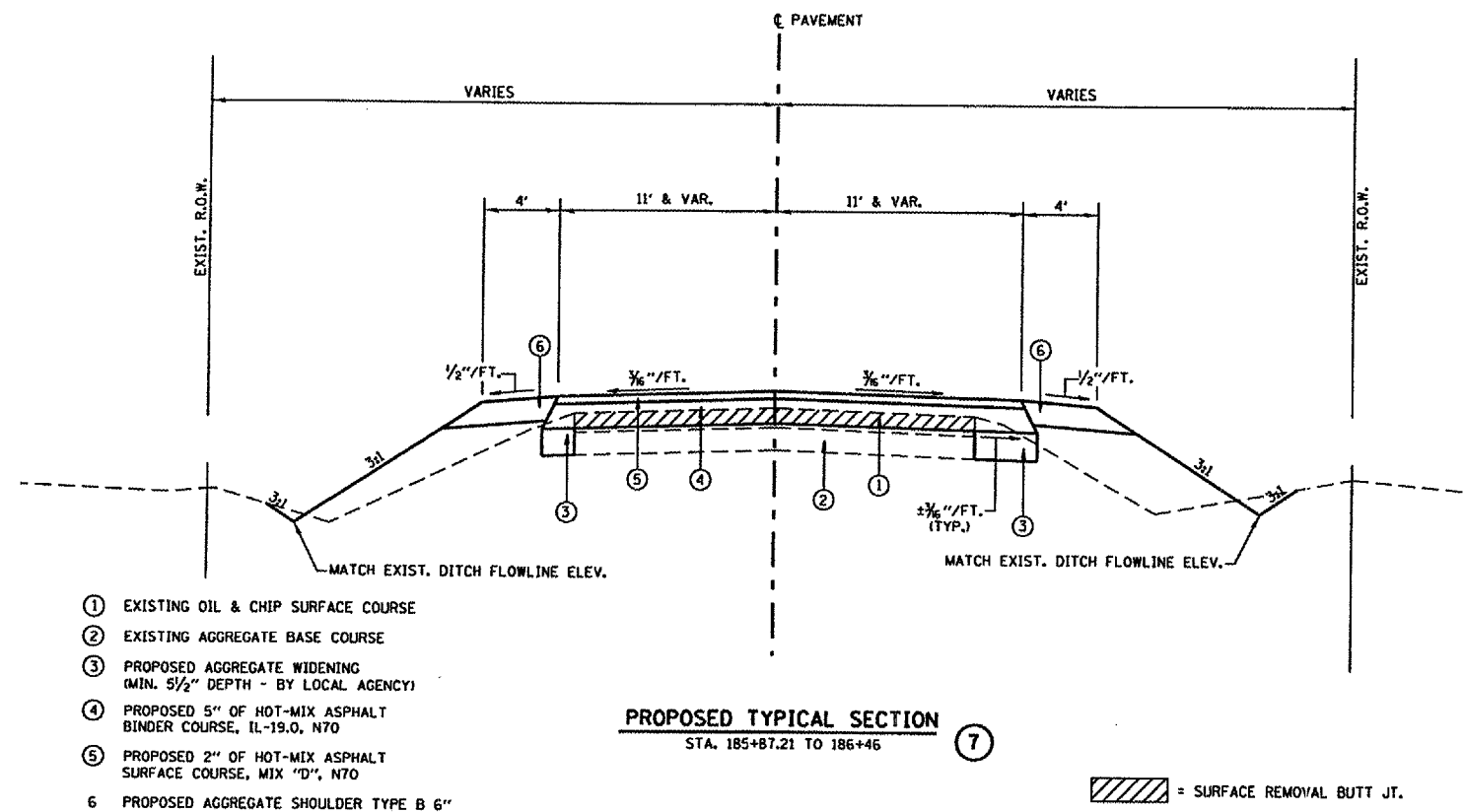

PAVEMENT DESIGN - FLEXIBLE (80,000 LB VEHICLE)

DP = 20 YR.
 ADT₍₂₀₂₅₎ = 750; PV=660, SU=53, MU=38
 CLASS III ROAD, E_(R) = 3ksi
 TF = 0.20

BITUMINOUS MIXTURE REQUIREMENTS

LOCATION	FAS 418	FAS 418
MIX USE	BINDER	SURFACE
AC/PG	PG 64-22	PG 64-22
RAP %	15	10
DESIGN VOIDS	4.0 @ N=70	4.0 @ N=70
MIXTURE COMPOSITION (GRAD. MIXTURE)	IL-19.0	IL-9.5 OR IL-12.0
FRICTION	N/A	MIX D (DOLOMITE ONLY)

PROPOSED TYPICAL SECTION
 STA. 185+87.21 TO 186+46

7

= SURFACE REMOVAL BUTT JT.

REVISIONS		ILLINOIS DEPARTMENT OF TRANSPORTATION F.A.S. 418 (VANTINE ROAD)
NAME	DATE	
		PROPOSED TYPICAL SECTIONS
SCALE: N/A	DRAWN BY CGF	CHECKED BY JJM
DATE: 1-5-07		

F.A.S. RTE.	SECTION	COUNTY	TOTAL SHEETS	SHEET NO.
418	04-00069-00-RS	HENDERSON	15	8
STA.		TO STA.		
FED. ROAD DIST. NO.		ILLINOIS	FED. AID PROJECT	
CONTRACT NO. 89366				

MAINLINE SCHEDULE

LOCATION	SUB GRAN MAT A (TON)	BIT MATLS PR CT (GAL)	AGG PR CT (TON)	HMA SURF REM BUTT JT (SQ YD)	HMA BC IL-19.0 N70 (TON)	HMA SC "D" N70 (TON)	PCC PVT 8 JOINTED (SQ YD)	PROTECTIVE COAT (SQ YD)	PAVEMENT REM (SQ YD)	AGGREGATE SHLDS B (TON)
STA 0+00.00 TO 1+20.00	131	40600100	40600300	40600982	40603085	40603340	42000301	42001300	44000100	48101200
STA 1+20.00 TO 64+96.00		1337.2	50.2		2235.7	1758.8	556	1112	336	925.7
STA 64+96.00 TO 65+46.00		10.1	0.4		16.8	13.2				6.9
STA 65+46.00 TO 74+25.00		168.7	6.3		280.9	220.6				112.4
STA 74+25.00 TO 75+15.00		16.4	0.6		56.6	22.6			240	11.2
STA 75+55.00 TO 76+45.00		16.4	0.6		56.6	22.6			240	8.9
STA 76+45.00 TO 80+47.00		77.2	2.9		128.5	100.9				39.7
STA 80+47.00 TO 81+37.00		16.3	0.6	230	28.7	22.6				8.9
STA 81+77.00 TO 82+57.00		16.4	0.6		56.6	22.6			230	8.9
STA 82+57.00 TO 96+46.00		264.7	10.0		440.6	346.1				136.3
STA 96+46.00 TO 96+96.00		9.6	0.3		18.4	12.5				5.5
STA 96+96.00 TO 109+96.00		250.4	9.4		541.7	326.3				156.9
STA 109+96.00 TO 110+46.00		9.6	0.3		18.4	12.5				5.5
STA 110+46.00 TO 130+46.00		383.9	14.4		639.1	501.9				197.6
STA 130+46.00 TO 130+96.00		9.6	0.4		19.2	12.5				5.7
STA 130+96.00 TO 139+96.00		173.6	6.5		404.3	225.9				99.1
STA 139+96.00 TO 140+46.00		9.6	0.4		19.2	12.5				5.7
STA 140+46.00 TO 155+46.00		287.9	10.9		479.3	376.4				148.2
STA 155+46.00 TO 155+96.00		10.1	0.4		16.8	13.2				6.4
STA 155+96.00 TO 185+87.21		627.3	23.6		1048.9	825.1				439.8
STA 185+87.21 TO 186+46.00		27.5	1.0	248	97.0	38.0				36.0
ADDED QUANTITY FOR RUTTING					630.8	475.8				
TOTALS	131	* 3722.5	* 139.8	* 478	* 7234.1	* 5362.6	556	1112	1046.0	* 2421.4

* PARTIAL QUANTITY

ENTRANCE AND MAILBOX TURNOUT SCHEDULE

LOCATION	TYPE	WIDTH	AGG SURF CSE B (TON)	BIT MATLS PR CT (GAL)	AGG PR CT (TON)	HMA BC IL-19.0 N70 (TON)	HMA SC "D" N70 (TON)	DRIVE PAVEMENT REM (SQ YD)
RT STA 53+85.12	P.E. & M.B.T.O.	40	40200800	40600100	40600300	40603085	40603340	44000200
LT STA 53+85.12	P.E.	11	3.8	1.2	0.04	2.1	1.7	117
LT STA 54+89.99	P.E.	14	6.4	0.7	0.03	1.2	1.0	
RT STA 56+99.73	P.E.	12	5.5	0.6	0.03	1.1	0.9	
RT STA 64+86.28	F.E.	20	14.4					
LT STA 64+86.28	F.E.	20	14.4					
RT STA 73+25.26	F.E.	20	16.1					
RT STA 77+61.18	F.E.	20	25.9					
LT STA 77+61.18	F.E.	20	10.7					
LT STA 86+31.98	P.E.	19	7.7	0.5	0.02	0.8	0.6	
LT STA 103+20.80	F.E.	25	13.3					
LT STA 107+95.78	F.E.	20	10.7					
LT STA 122+73.49	F.E.	16	8.7					
RT STA 147+50.38	P.E. & M.B.T.O.	15	6.1	1.3	0.05	2.3	1.9	
RT STA 154+87.39	F.E.	20	10.7					
LT STA 160+13.82	F.E.	21	9.7					
LT STA 160+66.47	F.E.	23	10.5					
TOTALS			192.8	*12.5	* 0.5	* 11.6	*22.5	117

* PARTIAL QUANTITY

SIDEROAD SCHEDULE

LOCATION	SIDEROAD	BIT MATLS PR CT (GAL)	AGG PR CT (TON)	HMA SURF REM BUTT JT (SQ YD)	HMA BC IL-19.0 N70 (TON)	HMA SC "D" N70 (TON)	AGGREGATE SHLDS B (TON)
LT STA 26+06.00	1300N	40600100	40600300	40600982	40603085	40603340	48101200
RT STA 26+06.00	1300N	15.4	0.6	123	10.2	35.7	5.0
LT STA 133+29.00	1500N	14.5	0.5	132	10.7	38.1	4.9
TOTALS		* 56.8	* 2.1	* 385	* 53.0	* 127.8	* 20.4

* PARTIAL QUANTITY

REVISIONS	
NAME	DATE

ILLINOIS DEPARTMENT OF TRANSPORTATION
F.A.S. 418 (VANTINE ROAD)

SCHEDULE OF QUANTITIES

SCALE: N/A
DATE: 1-5-07

DRAWN BY CGF
CHECKED BY JJM

GUARDRAIL SCHEDULE

LOCATION	SPBGR TY A (FT) 63000000	TR BAR TRM TI SPL TAN (EACH) 63100167	TRAF BAR TERM T5A (EACH) 63100075	TERMINAL MARKER-DA (EACH) 78201000	EXISTING GUARDRAIL (TO REMAIN) (FT)
RT STA 75+55.00 TO 75+68.25			1		
RT STA 75+68.25 TO 76+87.00	118.75			1	
RT STA 76+87.00 TO 77+37.00		1		1	
RT STA 77+87.00 TO 78+37.00		1		1	
RT STA 78+37.00 TO 80+87.00	250.00				
RT STA 80+87.00 TO 81+37.00		1		1	
RT STA 81+37.00 TO 84+80.00					*343
RT STA 84+80.00 TO 146+80.00	6200.00				
RT STA 146+80.00 TO 147+30.00		1		1	
RT STA 147+70.00 TO 148+20.00		1		1	
RT STA 148+20.00 TO 154+20.00	600.00				
RT STA 154+20.00 TO 154+70.00		1		1	
LT STA 77+80.75 TO 78+30.75		1		1	
LT STA 78+30.75 TO 80+87.00	256.25				
LT STA 80+87.00 TO 81+37.00		1		1	
LT STA 81+77.00 TO 82+27.00		1		1	
LT STA 82+27.00 TO 84+52.00	225.00				
LT STA 84+52.00 TO 85+02.00		1		1	
TOTALS	7650	10	1	10	*343

*ESTIMATED QUANTITY (FOR INFORMATION ONLY - NOT A PAY ITEM)

PAINT PAVEMENT MARKINGS

LOCATION	TYPE	PT PVT MK LTRS & SYMB (SQ FT) 78001100	PAINT PVT MK LINE 4 (FOOT) 78001110		PAINT PVT MK LINE 24 (FOOT) 78001180
			WHITE	YELLOW	WHITE
STA 0+00.00 TO 186+46.00	30-10 SKIP DASH			3287	
** RT STA 81+00.00	LETTERS & SYMBOLS	61			
** LT STA 82+00.00	LETTERS & SYMBOLS	61			
LT STA 65+00.00 TO 90+00.00	NO PASSING			2500	30
RT STA 65+00.00 TO 90+00.00	NO PASSING			2500	30
LT STA 135+00.00 TO 163+00.00	NO PASSING			3000	
RT STA 135+00.00 TO 163+00.00	NO PASSING			3000	
LT STA 0+00.00 TO 1+20.00	EDGE LINE		185		
RT STA 0+00.00 TO 1+20.00	EDGE LINE		139		
LT STA 1+20.00 TO 185+87.21	EDGE LINE		18467		
RT STA 1+20.00 TO 185+87.21	EDGE LINE		18467		
LT STA 185+87.21 TO 186+46.00	EDGE LINE		78		
RT STA 185+87.21 TO 186+46.00	EDGE LINE		123		
SUBTOTALS			37459	14287	
TOTALS		122	51746		60

**LOCATIONS HAVE BEEN ESTIMATED. PLACE ACCORDING TO HIGHWAY STANDARD 780001-01.

SHORT-TERM PAVEMENT MARKINGS

LOCATION	TYPE	SHORT-TERM PAVT MKING (FOOT) 70300100	WORK ZONE PAVT MK REM (SQ FT) 70301000
		YELLOW	
AFTER BINDER COURSE PLACEMENT			
STA 0+00.00 TO 65+00.00	CENTERLINE	592	
STA 65+00.00 TO 90+00.00	NO PASSING ZONE	5000	
STA 90+00.00 TO 135+00.00	CENTERLINE	400	
STA 135+00.00 TO 165+00.00	NO PASSING ZONE	6000	
STA 165+00.00 TO 186+46.00	CENTERLINE	196	
AFTER SURFACE COURSE PLACEMENT			
STA 0+00.00 TO 65+00.00	CENTERLINE	592	197
STA 65+00.00 TO 90+00.00	NO PASSING ZONE	5000	1665
STA 90+00.00 TO 135+00.00	CENTERLINE	400	133
STA 135+00.00 TO 165+00.00	NO PASSING ZONE	6000	1999
STA 165+00.00 TO 186+46.00	CENTERLINE	196	65
TOTALS		24376	4059

CULVERT REMOVAL SCHEDULE

LOCATION	TYPE	SIZE	REM EXIST CULVERTS (FT) 50105210
STA 0+11.95	CMP	30"	46
TOTAL			46

TRAFFIC CONTROL

LOCATION	TRAF CONT COMPL (L SUM) 70103700	MOBILIZATION (L SUM) 67100100
STA 0+00.00 TO 186+46.00	1	1
TOTALS	1	1

EARTHWORK SCHEDULE

LOCATION	EXCAVATION (CUT) (CU YD) 20200100	EXCAVATION (CUT) (ADJUSTED FOR SHRINKAGE) (CU YD)	EMBANKMENT (FILL) (CU YD)	EARTHWORK BALANCE WASTE (+) OR FURNISHED EXCAVATION (-) (CU YD) 20400800
STA. 0+00 TO 186+46 (VANTINE RD.)	278	210	3568	-3358
STA. 98+71.52 TO 99+51.79 (U.S. 34)	54	41	22	19
TOTALS	332	251	3550	-3339

(NOTE: PER BDE MANUAL CH. 64-2.02(a), USE SHRINKAGE FACTOR = 25%)
(NOTE: EMBANKMENT IS FOR INFORMATION ONLY & NOT A PAY ITEM)
(NOTE: ALL EARTHWORK QUANTITIES HAVE BEEN ESTIMATED)

CROSSROAD PIPE CULVERT SCHEDULE

LOCATION	P CUL 1 RC-E EORS 30 (FT) 54207165	PRCF END S EL EORS 30 (EACH) 54214725	TRENCH BACKFILL (CU YD) 20800150
0+40.00	52	2	14.9
TOTALS	52	2	14.9

REVISIONS		ILLINOIS DEPARTMENT OF TRANSPORTATION F.A.S. 418 (VANTINE ROAD)
NAME	DATE	
		<p style="text-align: center;">SCHEDULE OF QUANTITIES</p> <p>SCALE: N/A DATE: 1-5-07</p> <p style="text-align: right;">DRAWN BY CGF CHECKED BY JUM</p>

F.A.S. RTE.	SECTION	COUNTY	TOTAL SHEETS	SHEET NO.
418	04-00069-00-RS	HENDERSON	15	10
STA.		TO STA.		
FED. ROAD DIST. NO.		ILLINOIS FED. AID PROJECT		
CONTRACT NO. 89366				

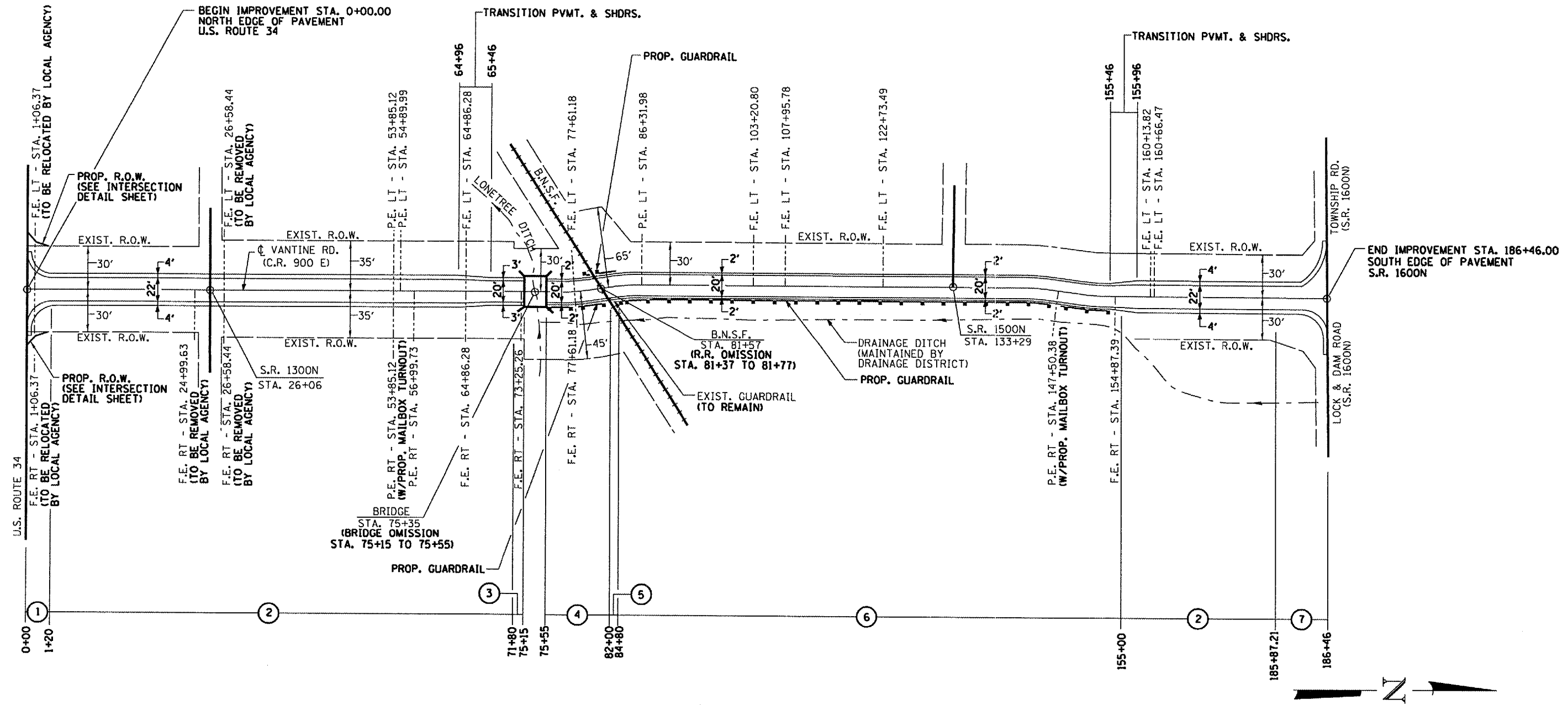

① = TYPICAL SECTION NO.

LENGTH OF OVERLAY = 18,646 FT. (3.53 MILES)

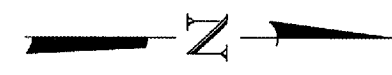

REVISIONS	
NAME	DATE

ILLINOIS DEPARTMENT OF TRANSPORTATION
F.A.S. 418 (VANTINE ROAD)

PROJECT CENTERLINE PLAN

SCALE: N/A
DATE: 1-5-07

DRAWN BY CGF
CHECKED BY JJM

F.A.S. RTE.	SECTION	COUNTY	TOTAL SHEETS	SHEET NO.
418	04-00069-00-RS	HENDERSON	15	11
STA.	TO STA.			
FED. ROAD DIST. NO.	ILLINOIS	FED. AID PROJECT		
CONTRACT NO. 89366				

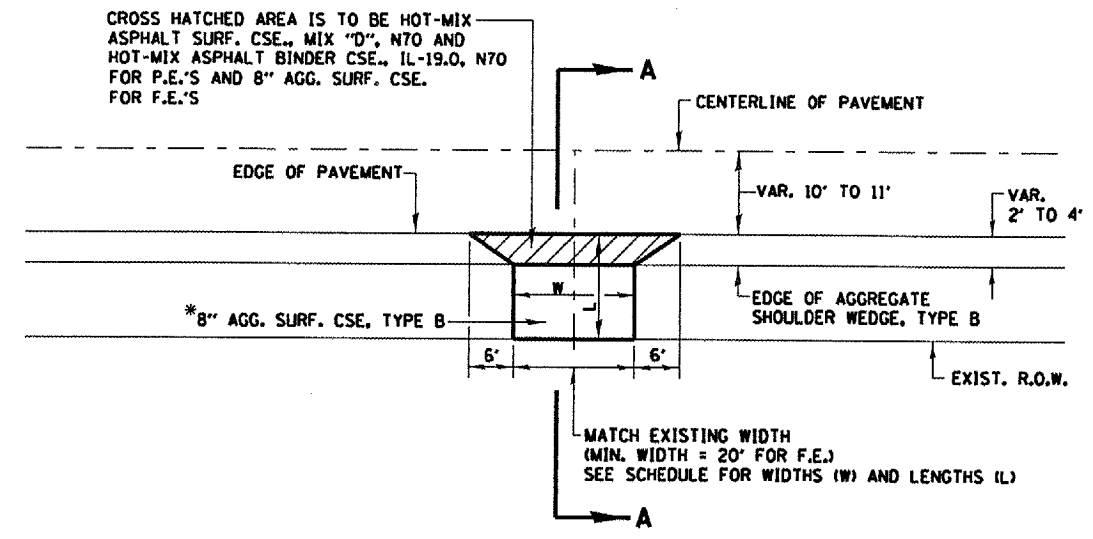

* P.E. LT STATION 53+85.12 - 6" AGG. BSE CSE, TYPE B WITH 2" HOT-MIX ASPHALT SURF. CSE., MIX "D", N70 (AGG. BSE. CSE., TYPE B SHALL BE PAID FOR AS AGG. SURF. CSE., TYPE B)

TYPICAL PLAN DETAIL OF PRIVATE AND FIELD ENTRANCES

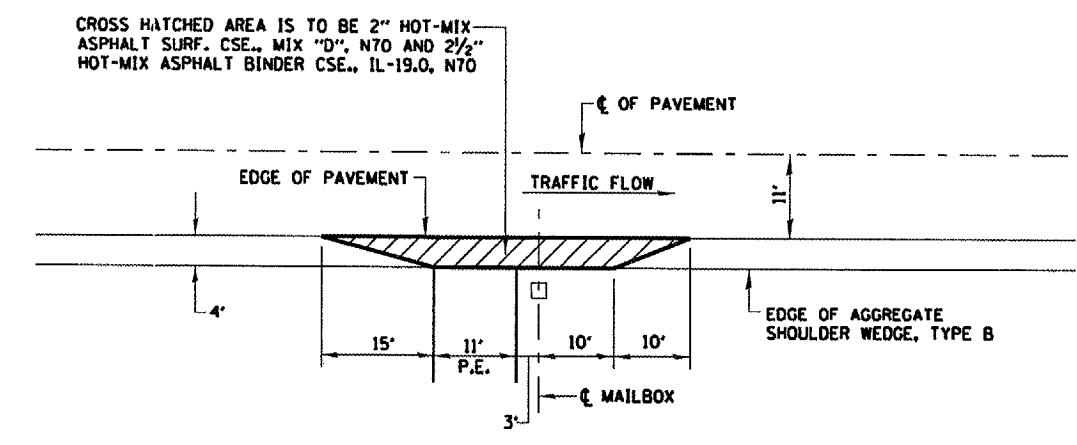

NOTE: MAILBOXES SHALL BE MOUNTED SUCH THAT THE FACE OF THE MAILBOX IS 6" TO 12" AND THE POST A MINIMUM OF 24" FROM THE EDGE OF THE TURNOUT SURFACING.

TYPICAL PLAN DETAIL OF MAILBOX TURNOUT

P.E. RT. STA. 53+85.12

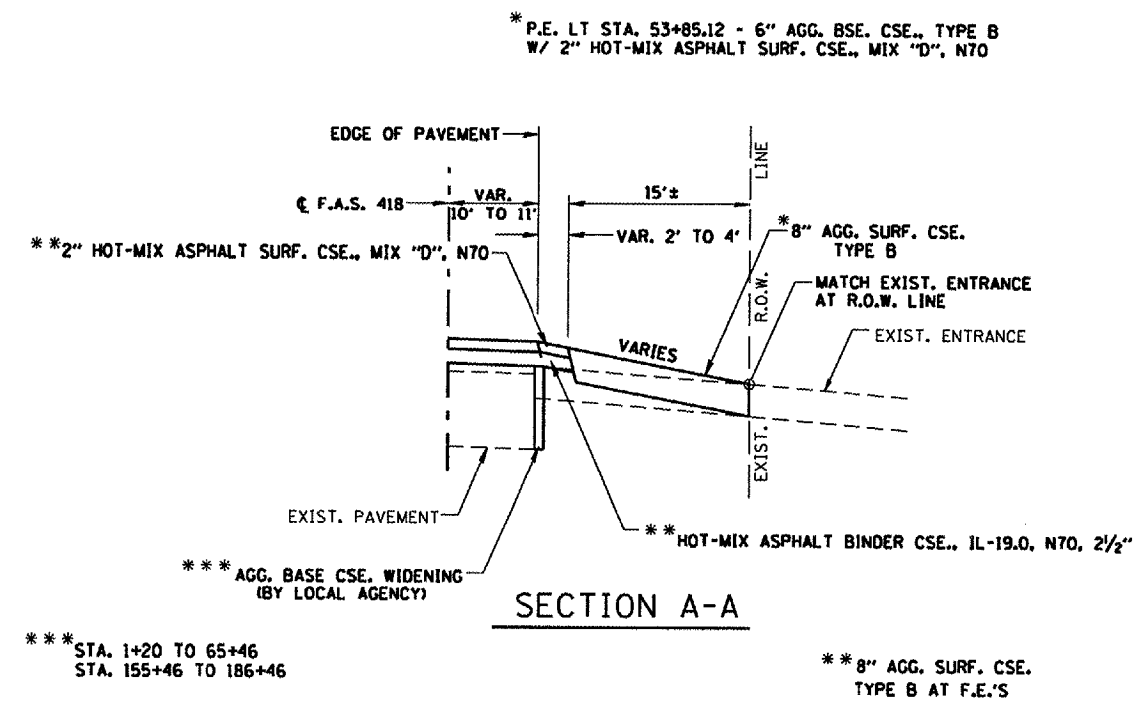

*** STA. 1+20 TO 65+46
STA. 155+46 TO 186+46

** 8" AGG. SURF. CSE. TYPE B AT F.E.'S

TYPICAL DETAIL OF PRIVATE AND FIELD ENTRANCES

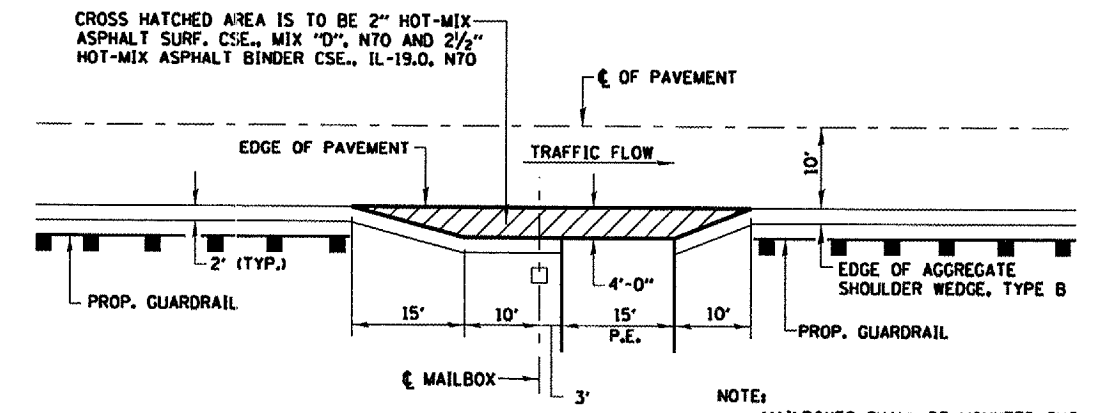

NOTE: MAILBOXES SHALL BE MOUNTED SUCH THAT THE FACE OF THE MAILBOX IS 6" TO 12" AND THE POST A MINIMUM OF 24" FROM THE EDGE OF THE TURNOUT SURFACING.

TYPICAL PLAN DETAIL OF MAILBOX TURNOUT

P.E. RT. STA. 147+50.38

REVISIONS	
NAME	DATE

ILLINOIS DEPARTMENT OF TRANSPORTATION
F.A.S. 418 (VANTINE ROAD)

**ENTRANCE & MAILBOX TURNOUT
DETAILS**

SCALE: N/A
DATE: 1-5-07

DRAWN BY CCF
CHECKED BY JJM

F.A.S. RTE.	SECTION	COUNTY	TOTAL SHEETS	SHEET NO.
418	04-00069-00-RS	HENDERSON	15	12
STA.	TO STA.			
FED. ROAD DIST. NO.	ILLINOIS FED. AID PROJECT			
CONTRACT NO. 89366				

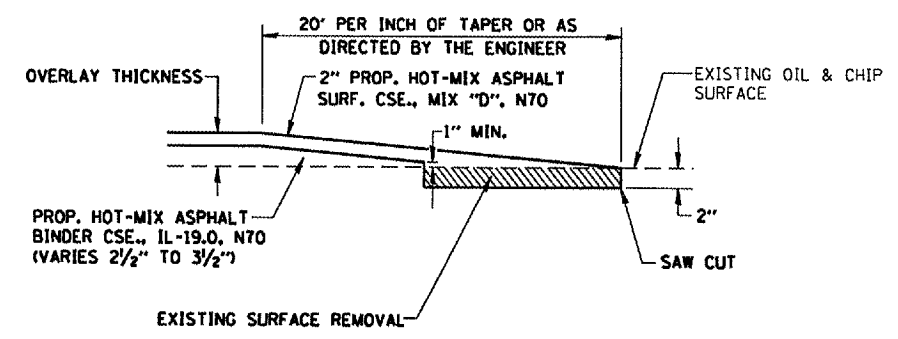

ELEVATION

LOCATION	BEGIN	END	OVERLAY THICKNESS
S.R. 1300N (W. LEG) - STA. 26+06	11' LT.	101' LT.	4 1/2"
S.R. 1300N (E. LEG) - STA. 26+06	11' RT.	101' RT.	4 1/2"
S.R. 1500N - STA. 133+29	10' LT.	120' LT.	5 1/2"

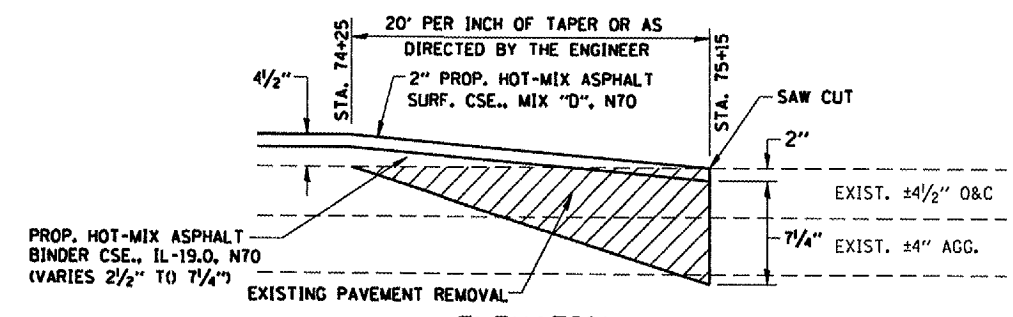

ELEVATION
(S. OF BRIDGE)

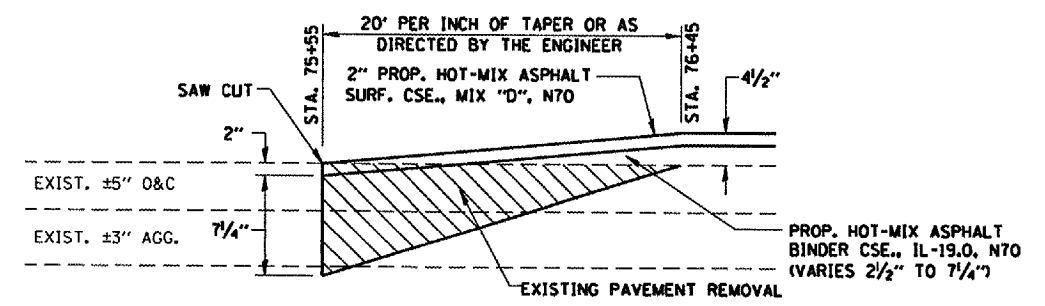

ELEVATION
(N. OF BRIDGE)

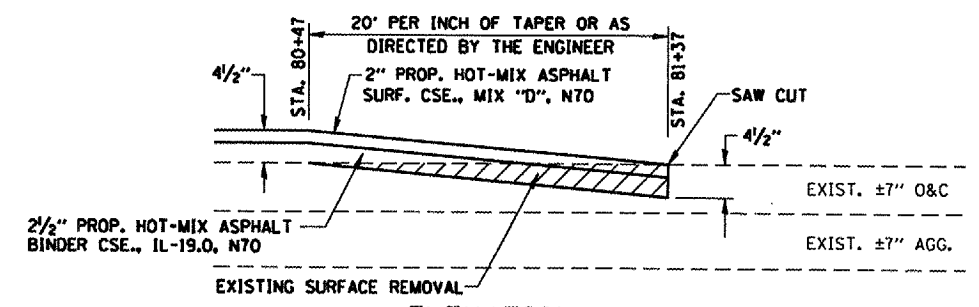

ELEVATION
(S. OF R.R. TRACKS)

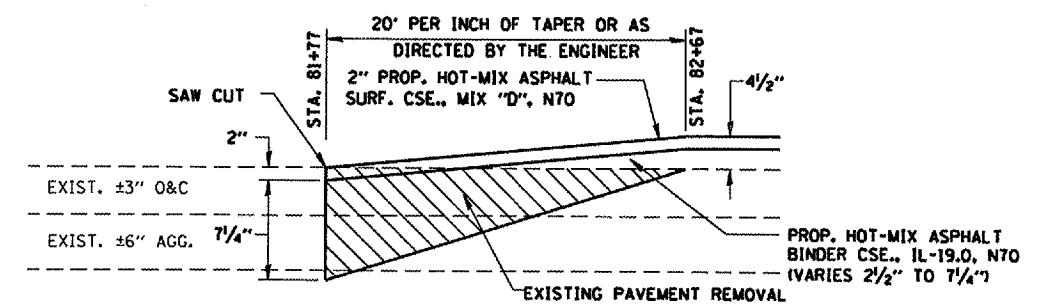

ELEVATION
(N. OF R.R. TRACKS)

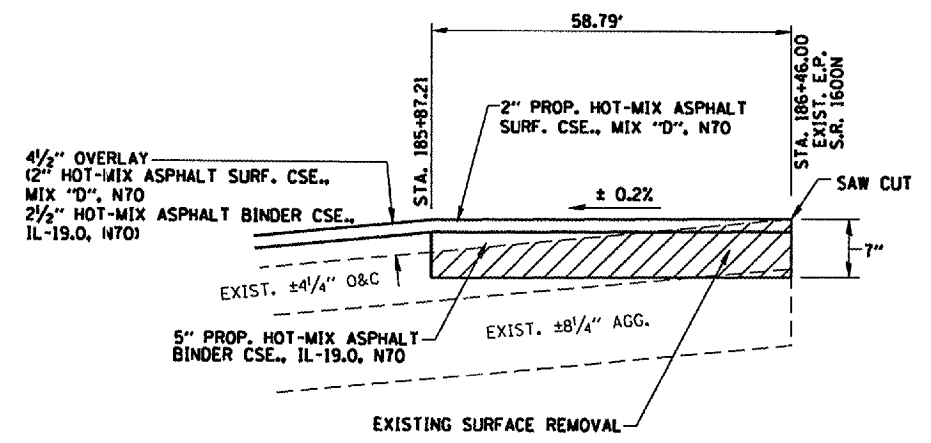

ELEVATION
(S.R. 1600N)

REVISIONS	
NAME	DATE

ILLINOIS DEPARTMENT OF TRANSPORTATION
F.A.S. 418 (VANTINE ROAD)

BUTT JOINT DETAILS

SCALE: N/A
DATE: 1-5-07

DRAWN BY CGF
CHECKED BY JJM

F.A.S. RTE.	SECTION	COUNTY	TOTAL SHEETS	SHEET NO.
418	04-00069-00-RS	HENDERSON	15	13
STA.		TO STA.		
FED. ROAD DIST. NO.	ILLINOIS	FED. AID PROJECT		
CONTRACT NO. 89366				

SIDEROAD	R1	R2
1300N	25'(SW) 30'(NE)	35'(NW) 25'(SE)

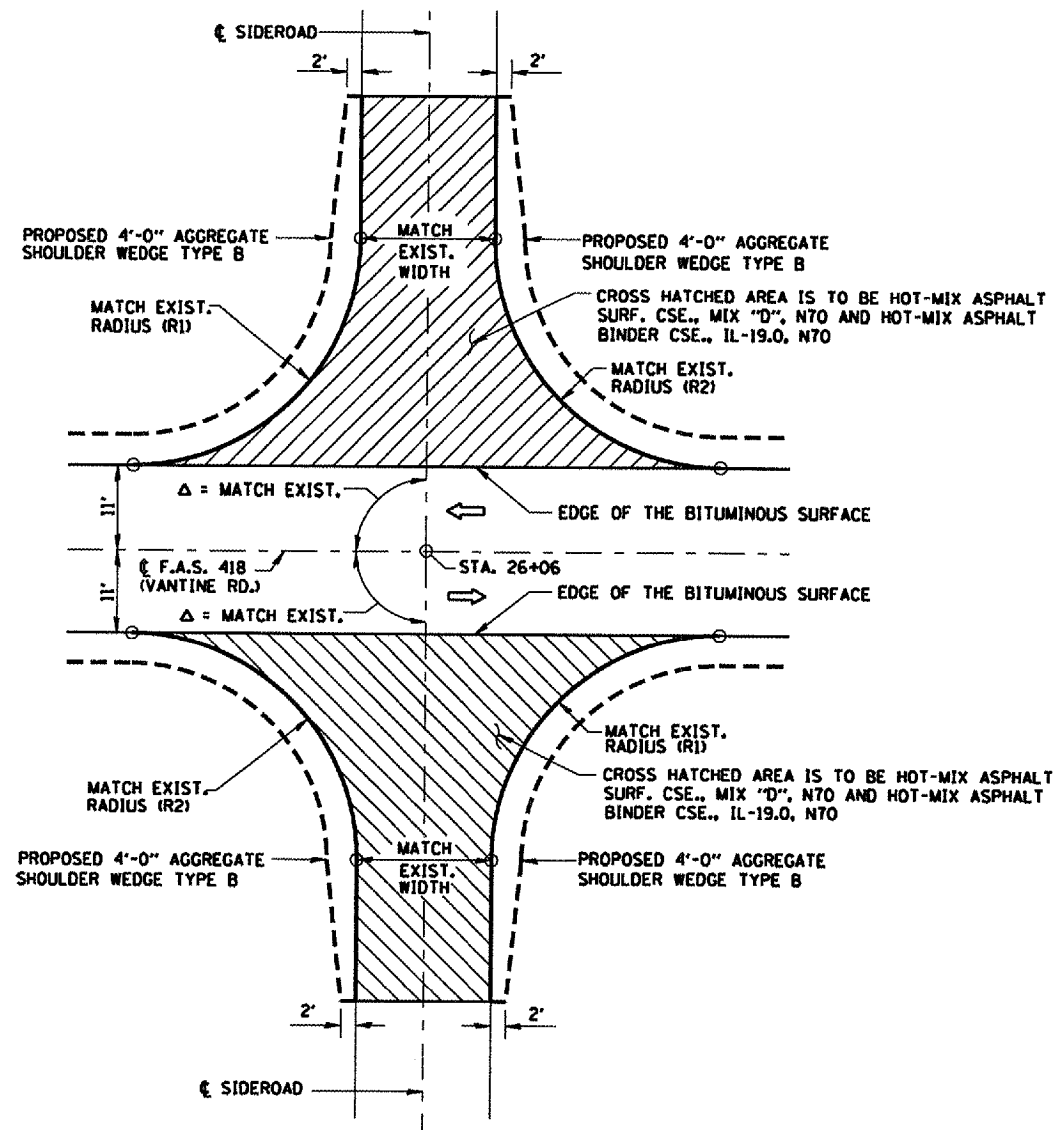
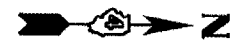

PLAN
S.R. 1300N

SIDEROAD	R1	R2
1500N	40'(SW) 70'(NW)	70'(NW)

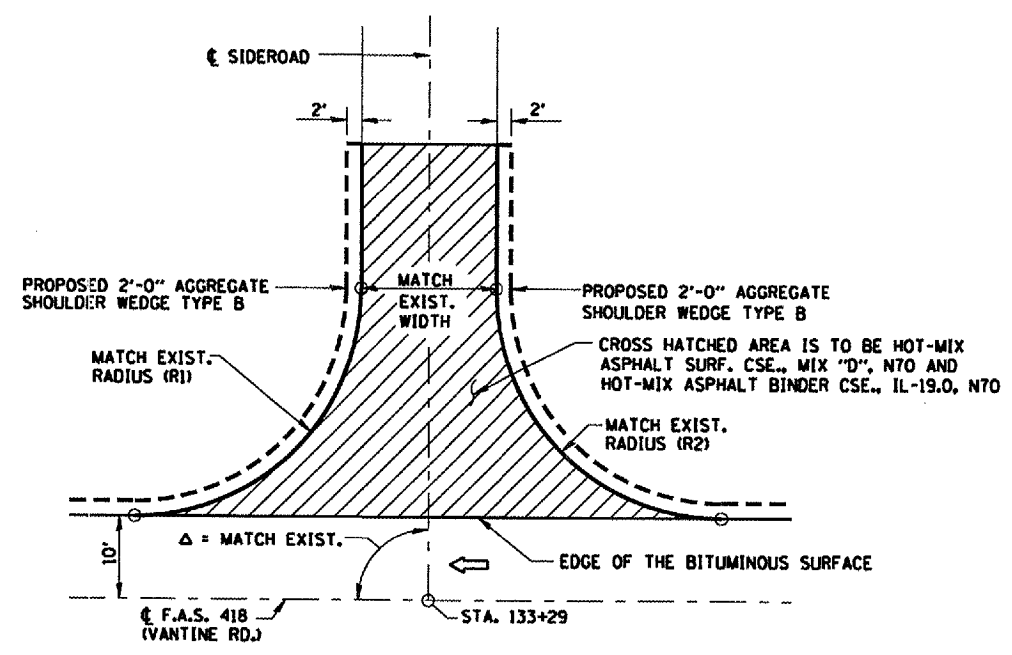

PLAN
S.R. 1500N

REVISIONS	
NAME	DATE

ILLINOIS DEPARTMENT OF TRANSPORTATION
F.A.S. 418 (VANTINE ROAD)

SIDEROAD DETAILS

SCALE: N/A
DATE: 1-5-07
DRAWN BY: CGF
CHECKED BY: JJM

F.A.S. RTE:	SECTION	COUNTY	TOTAL SHEETS	SHEET NO.
418	04-00069-00-RS	HENDERSON	15	14
STA. N/A	TO STA. N/A			
FED. ROAD DIST. NO.	ILLINOIS	FED. AID PROJECT	CONTRACT NO. 89366	

STA. 186+46.00 (C VANTINE ROAD) =
 STA. 200+00.00 (SOUTH E.O.P. S.R. 1600N)
 ELEV. 100.44

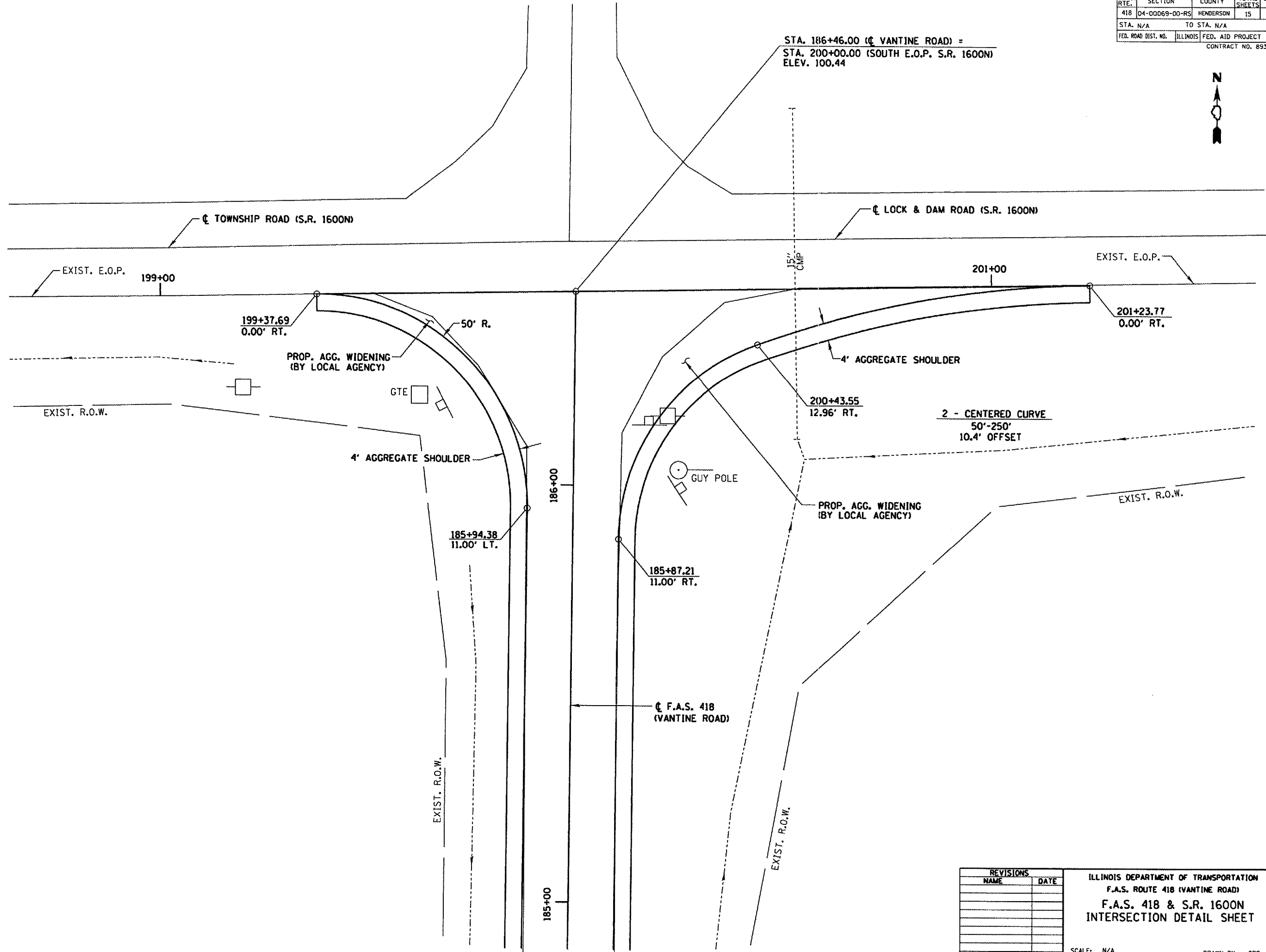

REVISIONS	
NAME	DATE

ILLINOIS DEPARTMENT OF TRANSPORTATION
 F.A.S. ROUTE 418 (VANTINE ROAD)
 F.A.S. 418 & S.R. 1600N
 INTERSECTION DETAIL SHEET

SCALE: N/A
 DATE: 1-5-07
 DRAWN BY: SRS
 CHECKED BY: JJM

F.A.S. RTE.	SECTION	COUNTY	TOTAL SHEETS	SHEET NO.
418	04-00069-00-RS	HENDERSON	15	15
STA. N/A	TO STA. N/A			
FED. ROAD DIST. NO.	ILLINOIS	FED. AID PROJECT		
CONTRACT NO. 89366				

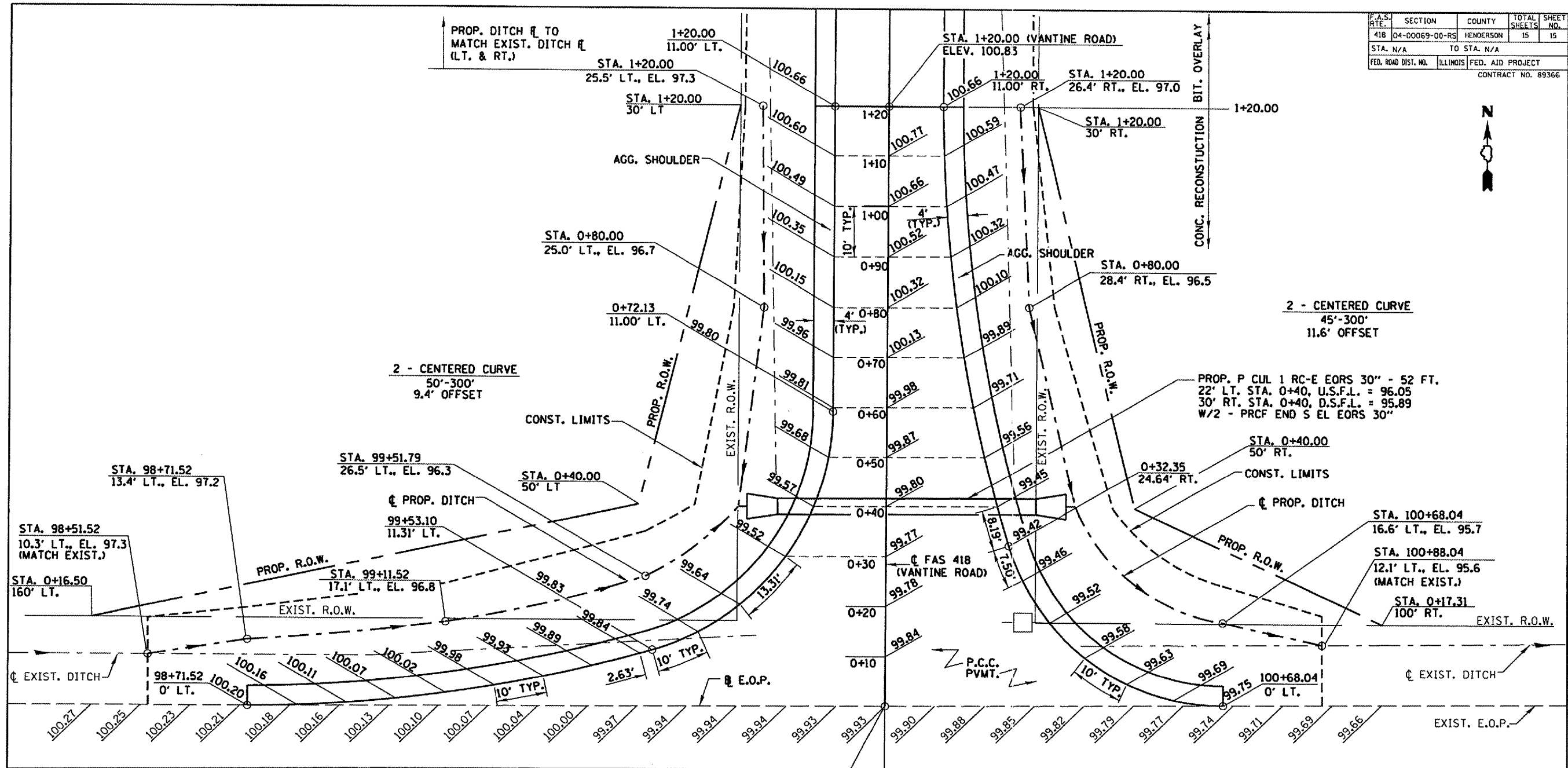

STA. 0+00.00 (C VANTINE ROAD) =
 STA. 100+00.00 (NORTH E.O.P. U.S. 34)
 ELEV. 99.93

PLAN

CONC. RECONSTRUCTION BIT. OVERLAY

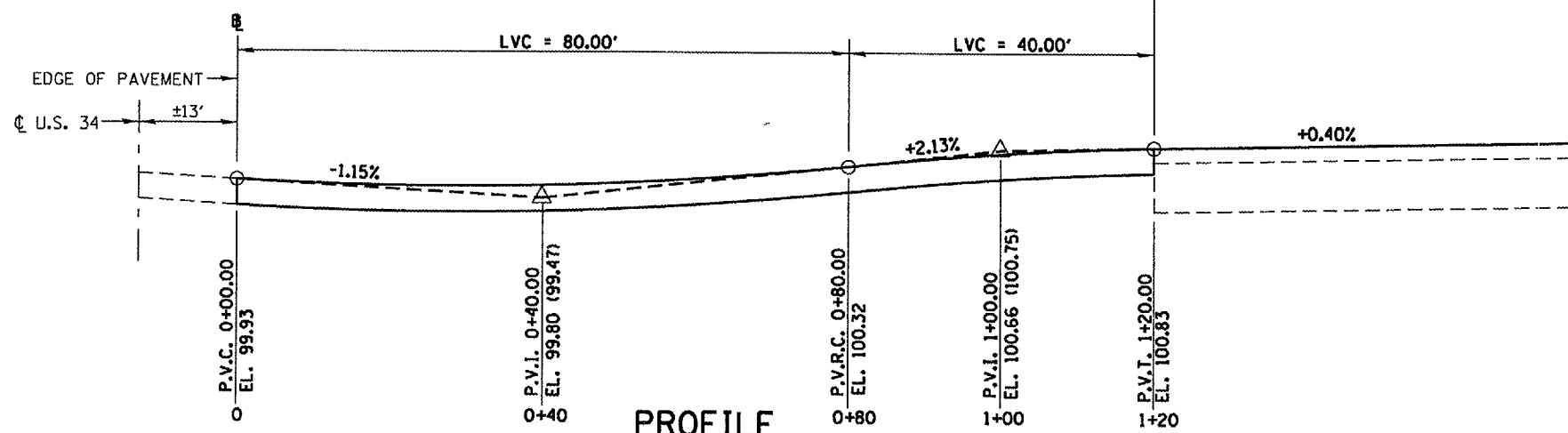

PROFILE

REVISIONS	
NAME	DATE

ILLINOIS DEPARTMENT OF TRANSPORTATION
 F.A.S. ROUTE 418 (VANTINE ROAD)
 F.A.S. 418 & U.S. 34
 INTERSECTION DETAIL SHEET

SCALE: N/A
 DATE: 1-5-07

DRAWN BY: SRS
 CHECKED BY: JJM

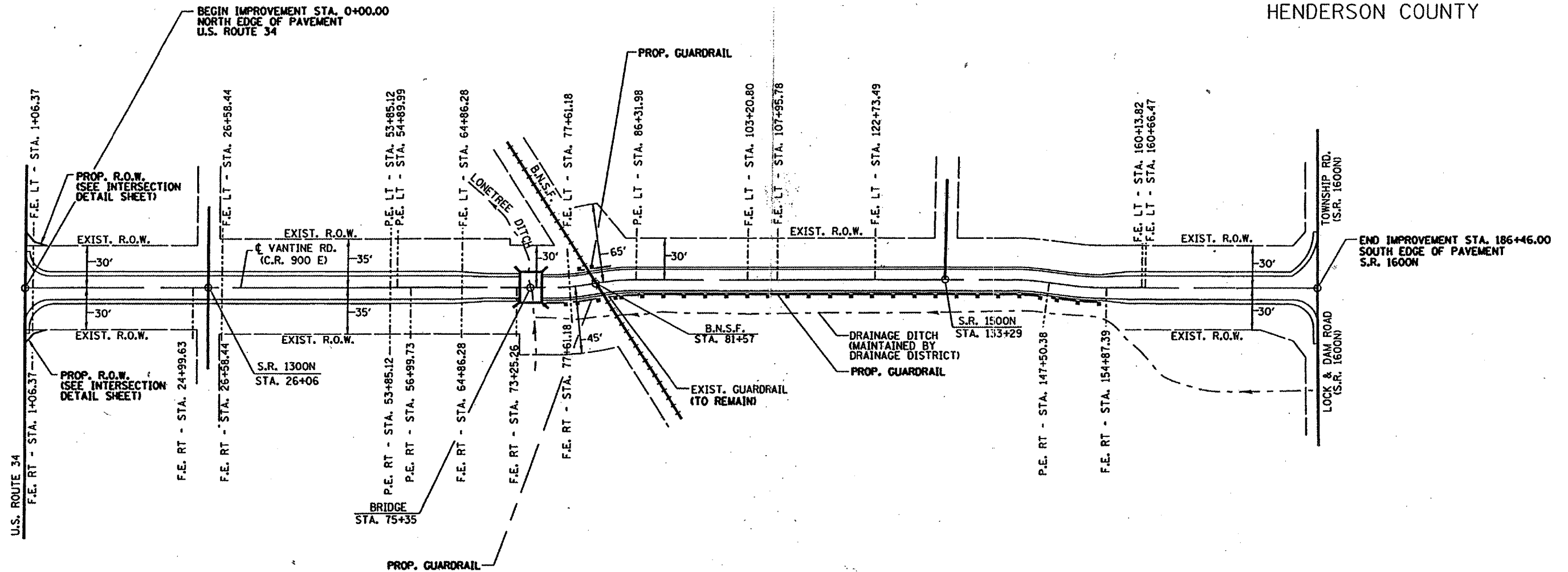

STORM WATER POLLUTION PREVENTION PLAN

DESCRIPTION OF INTENDED SEQUENCE FOR MAJOR CONSTRUCTION ACTIVITIES:

1. GRADE THE EXISTING FRONT SLOPES.
2. NECESSARY EMBANKMENT WILL BE PLACED ALONG THE ENTIRE LENGTH OF THE JOB FOR THE PROPOSED ROADWAY.
3. PLACEMENT, MAINTENANCE, REMOVAL AND PROPER CLEAN-UP OF TEMPORARY EROSION CONTROL ITEMS, SUCH AS TEMPORARY SEEDING AND OTHER MISCELLANEOUS EROSION CONTROL MEASURES, IF NECESSARY, AS DIRECTED BY THE RESIDENT ENGINEER.
4. PLACEMENT OF PERMANENT EROSION CONTROL ITEMS, INCLUDING RIPRAP AND SEEDING.
5. FINAL GRADING AND OTHER MISCELLANEOUS ITEMS.

NOTES: ALL TEMPORARY EROSION CONTROL ITEMS, IF NECESSARY, WILL BE HANDLED BY THE LOCAL AGENCY AS DIRECTED BY THE ENGINEER.

ALL PERMANENT EROSION CONTROL ITEMS WILL BE HANDLED BY THE LOCAL AGENCY AS DIRECTED BY THE ENGINEER.

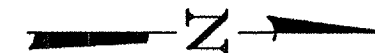

LENGTH OF OVERLAY = 18,646 FT. (3.53 MILES)
 (NOT TO SCALE)

