

F.A.U. RTE.	SECTION	COUNTY	TOTAL SHEETS	SHEET NO.
6579	05-00035-00-RP	PEORIA	31	8
STA. 9+16.5		TO STA. 12+50		
FED. ROAD DIST. NO. 4		ILLINOIS FED. AID PROJECT		

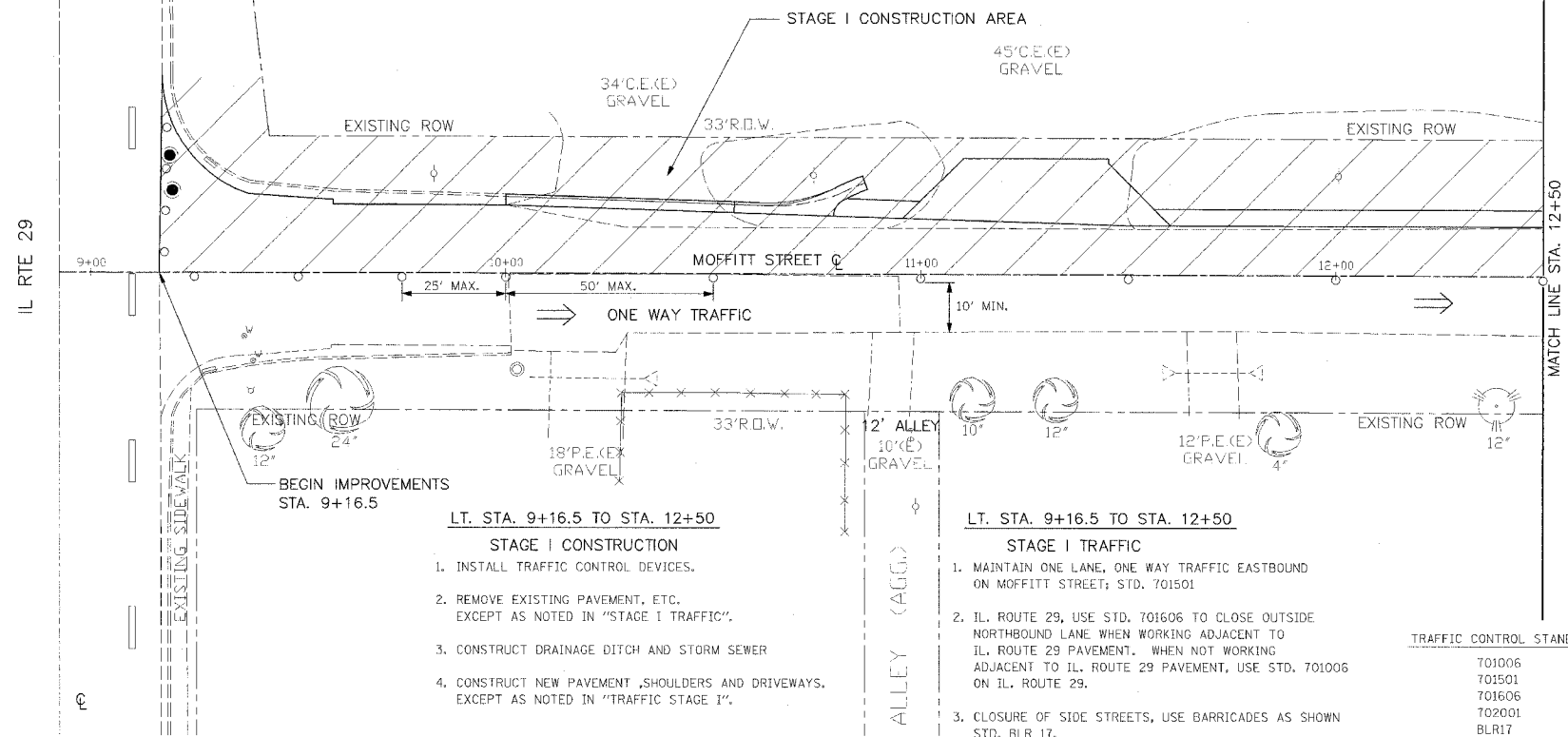

- LT. STA. 9+16.5 TO STA. 12+50**  
**STAGE I CONSTRUCTION**
1. INSTALL TRAFFIC CONTROL DEVICES, EXCEPT AS NOTED IN "STAGE I TRAFFIC".
  2. REMOVE EXISTING PAVEMENT, ETC. EXCEPT AS NOTED IN "STAGE I TRAFFIC".
  3. CONSTRUCT DRAINAGE DITCH AND STORM SEWER.
  4. CONSTRUCT NEW PAVEMENT, SHOULDERS AND DRIVEWAYS, EXCEPT AS NOTED IN "TRAFFIC STAGE 1".

- LT. STA. 9+16.5 TO STA. 12+50**  
**STAGE I TRAFFIC**
1. MAINTAIN ONE LANE, ONE WAY TRAFFIC EASTBOUND ON MOFFITT STREET; STD. 701501.
  2. IL. ROUTE 29, USE STD. 701606 TO CLOSE OUTSIDE NORTHBOUND LANE WHEN WORKING ADJACENT TO IL. ROUTE 29 PAVEMENT. WHEN NOT WORKING ADJACENT TO IL. ROUTE 29 PAVEMENT, USE STD. 701006 ON IL. ROUTE 29.
  3. CLOSURE OF SIDE STREETS, USE BARRICADES AS SHOWN STD. BLR 17.
  4. MAINTAIN ACCESS TO PROPERTY OWNERS.

**TRAFFIC CONTROL STANDARDS**

701006
701501
701606
702001
BLR17

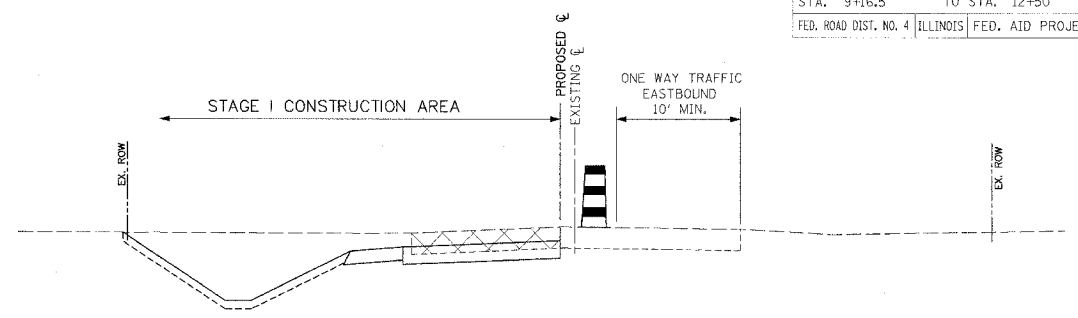

**STAGE I MAINTENANCE OF TRAFFIC**

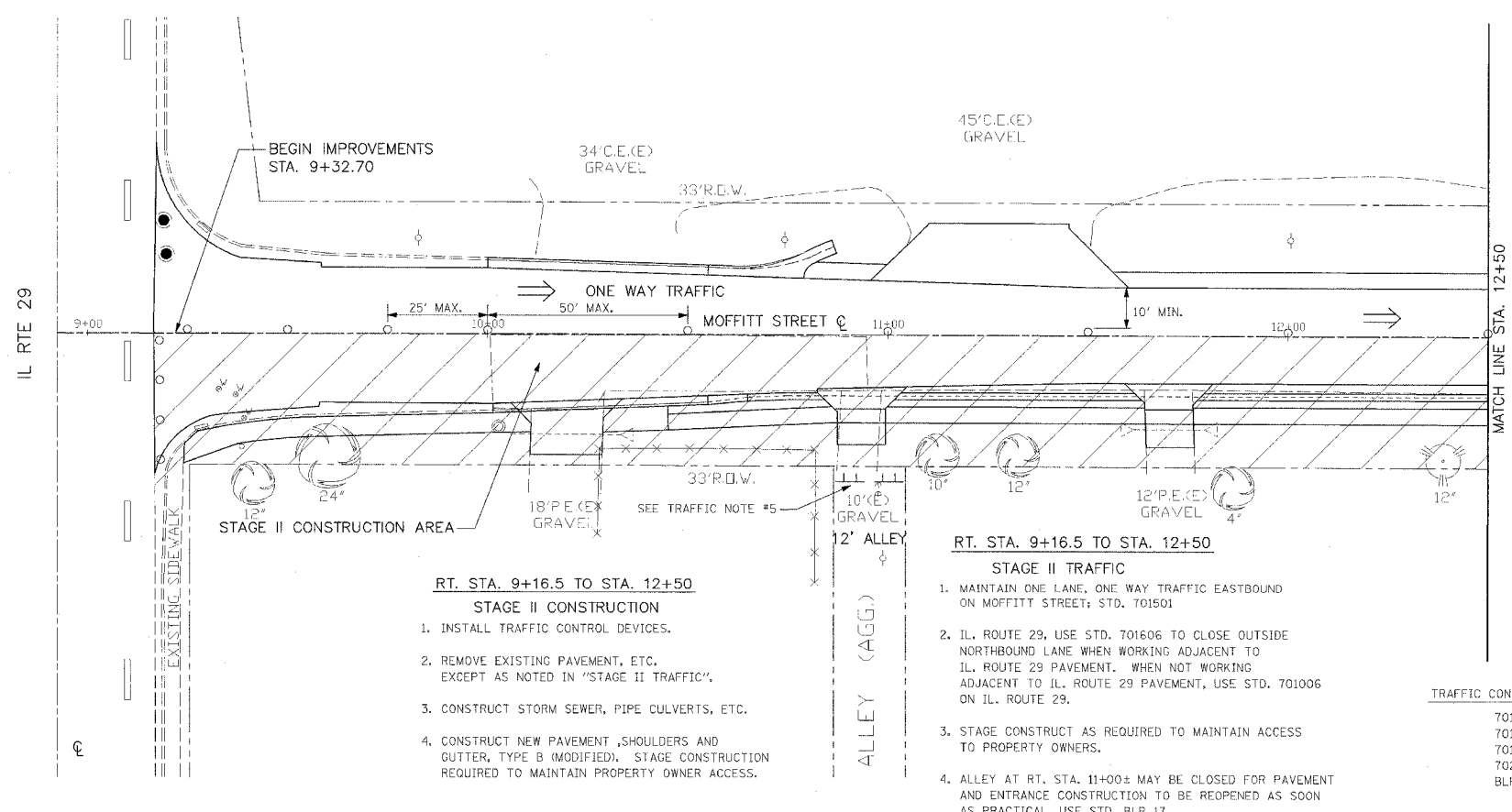

- RT. STA. 9+16.5 TO STA. 12+50**  
**STAGE II CONSTRUCTION**
1. INSTALL TRAFFIC CONTROL DEVICES.
  2. REMOVE EXISTING PAVEMENT, ETC. EXCEPT AS NOTED IN "STAGE II TRAFFIC".
  3. CONSTRUCT STORM SEWER, PIPE CULVERTS, ETC.
  4. CONSTRUCT NEW PAVEMENT, SHOULDERS AND GUTTER, TYPE B (MODIFIED), STAGE CONSTRUCTION REQUIRED TO MAINTAIN PROPERTY OWNER ACCESS.

- RT. STA. 9+16.5 TO STA. 12+50**  
**STAGE II TRAFFIC**
1. MAINTAIN ONE LANE, ONE WAY TRAFFIC EASTBOUND ON MOFFITT STREET; STD. 701501.
  2. IL. ROUTE 29, USE STD. 701606 TO CLOSE OUTSIDE NORTHBOUND LANE WHEN WORKING ADJACENT TO IL. ROUTE 29 PAVEMENT. WHEN NOT WORKING ADJACENT TO IL. ROUTE 29 PAVEMENT, USE STD. 701006 ON IL. ROUTE 29.
  3. STAGE CONSTRUCT AS REQUIRED TO MAINTAIN ACCESS TO PROPERTY OWNERS.
  4. ALLEY AT RT. STA. 11+00± MAY BE CLOSED FOR PAVEMENT AND ENTRANCE CONSTRUCTION TO BE REOPENED AS SOON AS PRACTICAL, USE STD. BLR 17.

**TRAFFIC CONTROL STANDARDS**

701006
701501
701606
702001
BLR17

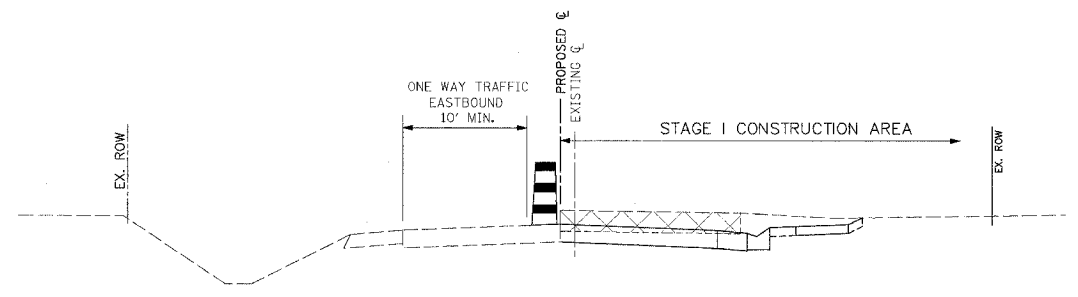

**STAGE II MAINTENANCE OF TRAFFIC**

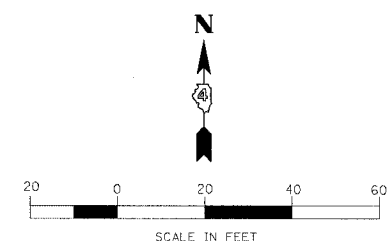

**REVISIONS**

NAME	DATE

ILLINOIS DEPARTMENT OF TRANSPORTATION  
**MOFFITT STREET IMPROVEMENTS**  
**MAINTENANCE OF TRAFFIC STAGES I AND II**  
**STA. 9+16.5 TO STA. 12+50**

DATE: 12/05/06  
 DRAWN BY: DLC  
 CHECKED BY: REW