

F.A.U. RTE.	SECTION	COUNTY	TOTAL SHEETS	SHEET NO.
6579	05-00035-00-RR	PEORIA	31	9
STA. 12+50		TO STA. 17+50		
FED. ROAD DIST. NO. 4 ILLINOIS		FED. AID PROJECT		

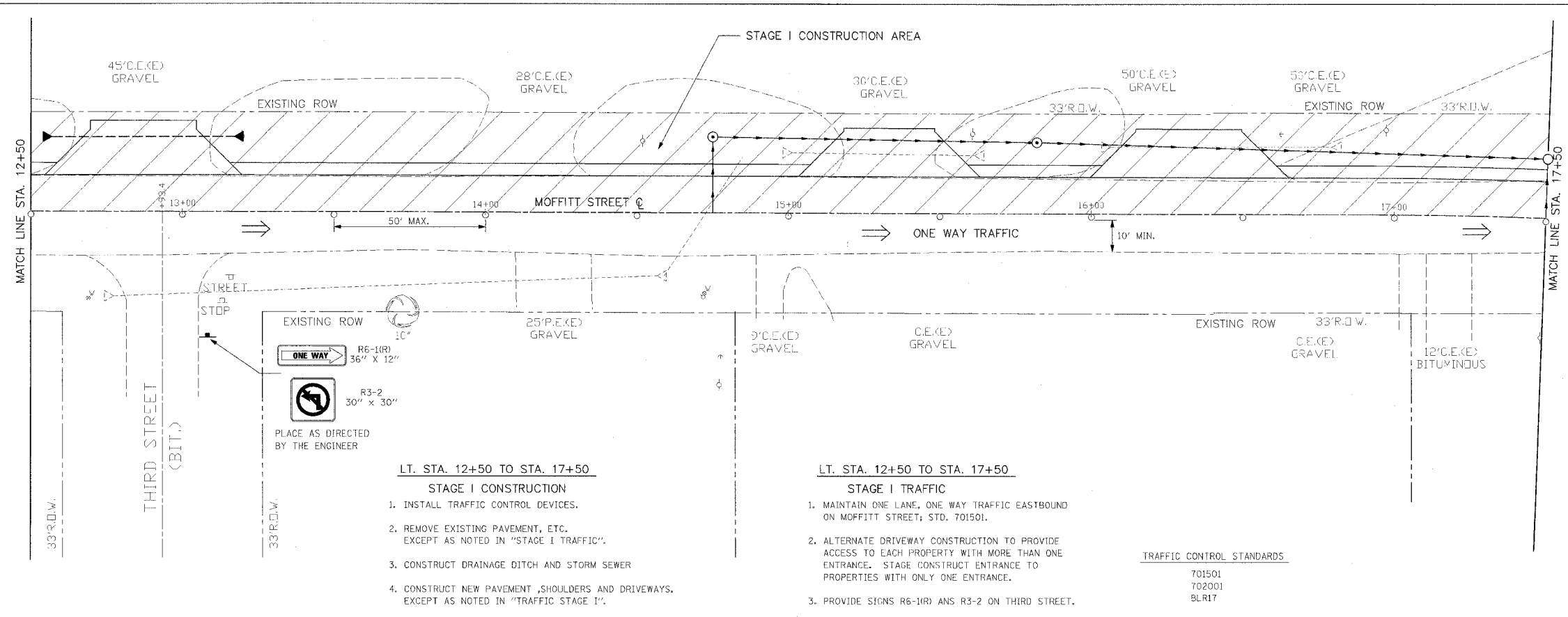

- LT. STA. 12+50 TO STA. 17+50**
- STAGE I CONSTRUCTION**
1. INSTALL TRAFFIC CONTROL DEVICES.
 2. REMOVE EXISTING PAVEMENT, ETC. EXCEPT AS NOTED IN "STAGE I TRAFFIC".
 3. CONSTRUCT DRAINAGE DITCH AND STORM SEWER
 4. CONSTRUCT NEW PAVEMENT, SHOULDERS AND DRIVEWAYS. EXCEPT AS NOTED IN "TRAFFIC STAGE I".

- LT. STA. 12+50 TO STA. 17+50**
- STAGE I TRAFFIC**
1. MAINTAIN ONE LANE, ONE WAY TRAFFIC EASTBOUND ON MOFFITT STREET; STD. 701501.
 2. ALTERNATE DRIVEWAY CONSTRUCTION TO PROVIDE ACCESS TO EACH PROPERTY WITH MORE THAN ONE ENTRANCE. STAGE CONSTRUCT ENTRANCE TO PROPERTIES WITH ONLY ONE ENTRANCE.
 3. PROVIDE SIGNS R6-1(R) AND R3-2 ON THIRD STREET.

TRAFFIC CONTROL STANDARDS

701501
702001
BLR17

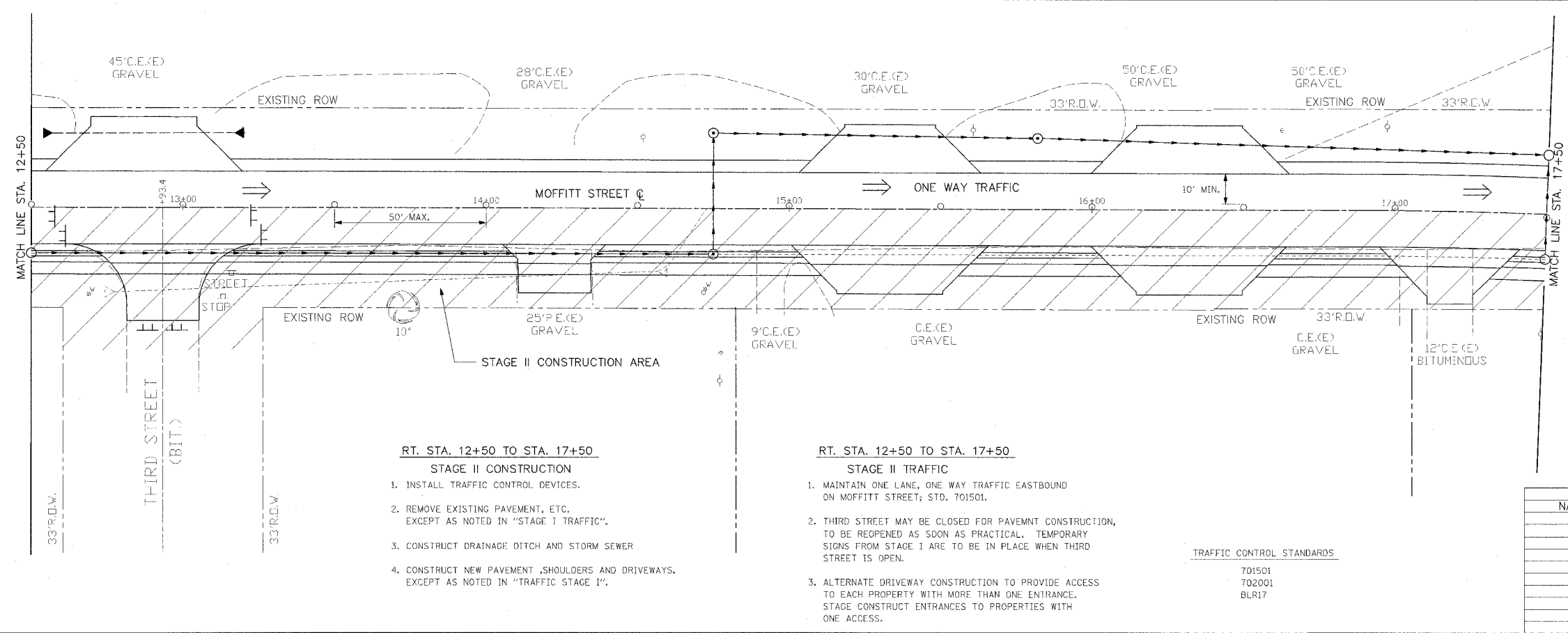

- RT. STA. 12+50 TO STA. 17+50**
- STAGE II CONSTRUCTION**
1. INSTALL TRAFFIC CONTROL DEVICES.
 2. REMOVE EXISTING PAVEMENT, ETC. EXCEPT AS NOTED IN "STAGE I TRAFFIC".
 3. CONSTRUCT DRAINAGE DITCH AND STORM SEWER
 4. CONSTRUCT NEW PAVEMENT, SHOULDERS AND DRIVEWAYS. EXCEPT AS NOTED IN "TRAFFIC STAGE I".

- RT. STA. 12+50 TO STA. 17+50**
- STAGE II TRAFFIC**
1. MAINTAIN ONE LANE, ONE WAY TRAFFIC EASTBOUND ON MOFFITT STREET; STD. 701501.
 2. THIRD STREET MAY BE CLOSED FOR PAVEMENT CONSTRUCTION, TO BE REOPENED AS SOON AS PRACTICAL. TEMPORARY SIGNS FROM STAGE I ARE TO BE IN PLACE WHEN THIRD STREET IS OPEN.
 3. ALTERNATE DRIVEWAY CONSTRUCTION TO PROVIDE ACCESS TO EACH PROPERTY WITH MORE THAN ONE ENTRANCE. STAGE CONSTRUCT ENTRANCES TO PROPERTIES WITH ONE ACCESS.

TRAFFIC CONTROL STANDARDS

701501
702001
BLR17

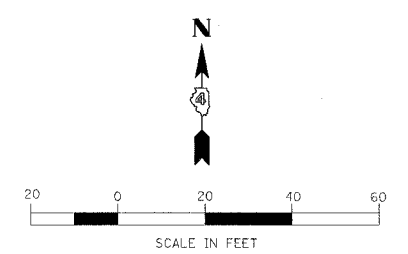

REVISIONS	
NAME	DATE

ILLINOIS DEPARTMENT OF TRANSPORTATION

MOFFITT STREET IMPROVEMENTS

MAINTENANCE OF TRAFFIC STAGES I AND II

STA. 12+50 TO STA. 17+50

DATE 12/05/06

DRAWN BY DLC
CHECKED BY REW