

F.A. RTE.	SECTION	COUNTY	TOTAL SHEETS	SHEET NO.
	05-00030-01-FP	*	44	23
STA. 67+20.50		TO STA. 77+00		
FED. ROAD DIST. NO.		ILLINOIS FED. AID PROJECT		
* FULTON & PEORIA CONTRACT NO. 89395				

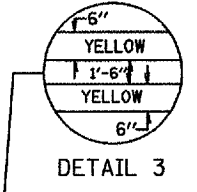
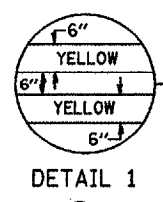
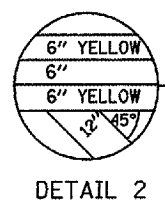
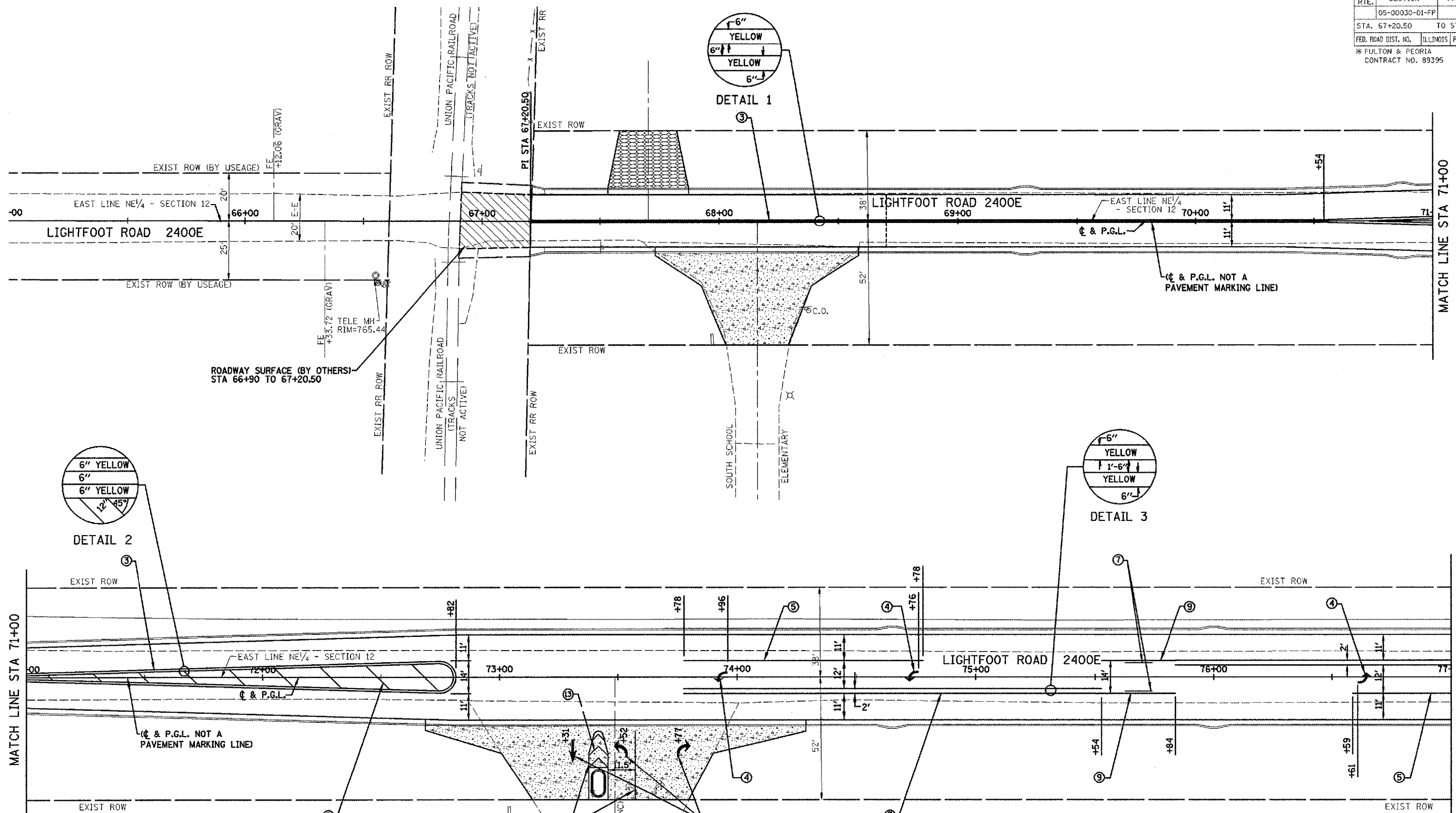

- NOTES:**
- PAVEMENT MARKING LINES SHALL NOT BE LAID DIRECTLY OVER A LONGITUDINAL CRACK OR JOINT, NOR OVER A TAR OR ASPHALT PAINTED LINE. THE EDGES OF CENTER LINE OR LANE LINES SHALL BE OFFSET A MINIMUM OF 2" FROM A LONGITUDINAL CRACK OR JOINT.
  - THE CONTRACTOR SHALL CONTACT THE CITY OF FARMINGTON PRIOR TO RELOCATION OF STOP SIGNS.
  - THE CITY SHALL FURNISH AND INSTALL ANY NEW APPLICABLE PARKING, CROSSWALK, 30 MPH SPEED LIMIT, AND OTHER TRAFFIC CONTROL SIGNS AS REQUIRED IN ACCORDANCE WITH THE MUTCD MANUAL. ALL SIGNS SHALL BE RELOCATED AND IN PLACE PRIOR TO OPENING THE STREET TO TRAFFIC.
  - SEE THE TYPICAL ROADWAY SECTION FOR OTHER DETAILS.

- 24" SOLID WHITE THERMOPLASTIC STOP BAR
- 6" SOLID WHITE THERMOPLASTIC CROSSWALK LINES STRIPED 7' WIDE
- 6" SOLID DOUBLE YELLOW THERMOPLASTIC LINE (SEE DETAIL NO. 1 OR NO. 3)
- WHITE THERMOPLASTIC PAVEMENT MARKING SYMBOL (LARGE SIZE) SEE STATE STANDARD 780001-01
- 8" WHITE THERMOPLASTIC PAVEMENT MARKING LINE
- 8" WHITE THERMOPLASTIC PAVEMENT MARKING LINE, 2' LONG, 6" GAP
- 6" YELLOW THERMOPLASTIC PAVEMENT MARKING LINE, 10' LONG, 30' GAP
- 12" SOLID YELLOW THERMOPLASTIC DIAGONAL LINES AT 20' C-C (SEE DETAIL 2)
- 6" SOLID YELLOW THERMOPLASTIC LINE
- YELLOW PAINT PAVEMENT MARKING SYMBOL (LARGE SIZE) SEE STATE STANDARD 780001-01
- 12" SOLID WHITE THERMOPLASTIC TRANSVERSE LINES @ 3' C-C
- RELOCATED STOP SIGN
- 8" SOLID YELLOW PAINT PAVEMENT MARKING LINE
- 12" SOLID YELLOW PAINT PAVEMENT MARKING LINE

CITY OF FARMINGTON, ILLINOIS  
LIGHTFOOT ROAD - 2400E  
SECTION 05-00030-01-FP

PAVEMENT MARKING PLAN

DRAWN BY DRR		FILE NO. 24-7613
DATE 11/06/06		BOOK NO. PEO-7&13
CHECKED BY RGD		SHEET NO. 23 OF 44

