

F.A. RTE.	SECTION	COUNTY	TOTAL SHEETS	SHEET NO.
	05-00030-01-FP	*	44	25
STA. 89+00		TO STA. 90+00		
FED. ROAD DIST. NO.	ILLINOIS	FED. AID PROJECT		
* FULTON & PEORIA				
CONTRACT NO. 89395				

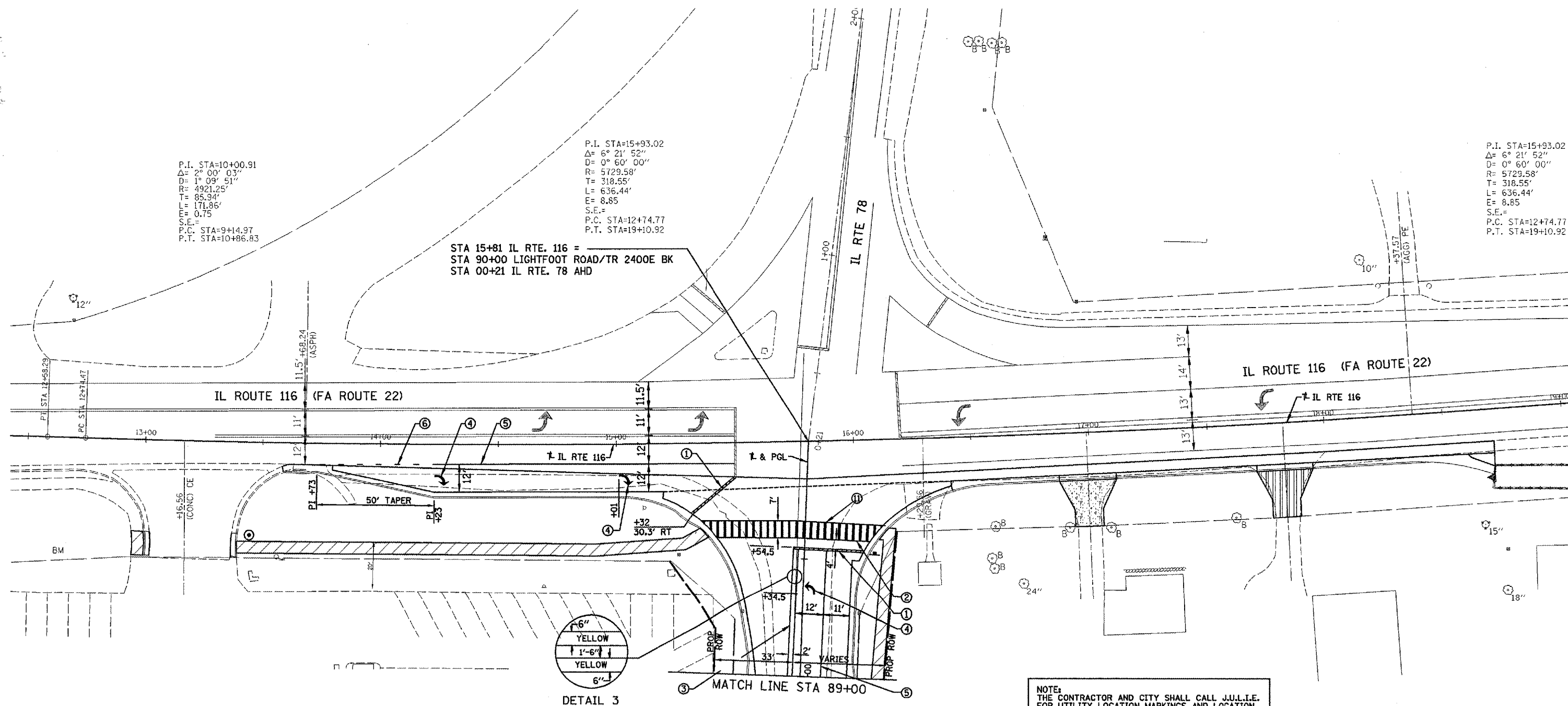

P.I. STA=10+00.91  
 $\Delta = 2^{\circ} 00' 03''$   
 $D = 1^{\circ} 09' 51''$   
 $R = 4921.25'$   
 $T = 85.94'$   
 $L = 171.86'$   
 $E = 0.75$   
 $S.E. =$   
 P.C. STA=9+14.97  
 P.T. STA=10+86.83

P.I. STA=15+93.02  
 $\Delta = 6^{\circ} 21' 52''$   
 $D = 0^{\circ} 60' 00''$   
 $R = 5729.58'$   
 $T = 318.55'$   
 $L = 636.44'$   
 $E = 8.85$   
 $S.E. =$   
 P.C. STA=12+74.77  
 P.T. STA=19+10.92

P.I. STA=15+93.02  
 $\Delta = 6^{\circ} 21' 52''$   
 $D = 0^{\circ} 60' 00''$   
 $R = 5729.58'$   
 $T = 318.55'$   
 $L = 636.44'$   
 $E = 8.85$   
 $S.E. =$   
 P.C. STA=12+74.77  
 P.T. STA=19+10.92

STA 15+81 IL RTE. 116 =  
 STA 90+00 LIGHTFOOT ROAD/TR 2400E BK  
 STA 00+21 IL RTE. 78 AHD

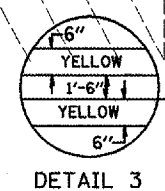

NOTE:  
 THE CONTRACTOR AND CITY SHALL CALL J.U.L.I.E.  
 FOR UTILITY LOCATION MARKINGS AND LOCATION  
 PRIOR TO INSTALLING SIGN POSTS.

- ① 24" SOLID WHITE THERMOPLASTIC STOP BAR
- ② 6" SOLID WHITE THERMOPLASTIC CROSSWALK LINES STRIPED 7' WIDE
- ③ 6" SOLID DOUBLE YELLOW THERMOPLASTIC LINE (SEE DETAIL NO. 1 OR NO. 3)
- ④ WHITE THERMOPLASTIC PAVEMENT MARKING SYMBOL (LARGE SIZE)  
SEE STATE STANDARD 780001-01
- ⑤ 8" WHITE THERMOPLASTIC PAVEMENT MARKING LINE
- ⑥ 8" WHITE THERMOPLASTIC PAVEMENT MARKING LINE, 2' LONG, 6' GAP
- ⑦ 6" YELLOW THERMOPLASTIC PAVEMENT MARKING LINE, 10' LONG, 30' GAP
- ⑧ 12" SOLID YELLOW THERMOPLASTIC DIAGONAL LINES AT 20' C-C (SEE DETAIL 2)
- ⑨ 6" SOLID YELLOW THERMOPLASTIC LINE
- ⑩ YELLOW PAINT PAVEMENT MARKING SYMBOL (LARGE SIZE) SEE STATE STANDARD 780001-01
- ⑪ 12" SOLID WHITE THERMOPLASTIC TRANSVERSE LINES @ 3' C-C
- ← RELOCATED STOP SIGN
- ⑫ 8" SOLID YELLOW PAINT PAVEMENT MARKING LINE
- ⑬ 12" SOLID YELLOW PAINT PAVEMENT MARKING LINE

- NOTES:
1. PAVEMENT MARKING LINES SHALL NOT BE LAID DIRECTLY OVER A LONGITUDINAL CRACK OR JOINT, NOR OVER A TAR OR ASPHALT PAINTED LINE. THE EDGES OF CENTER LINE OR LANE LINES SHALL BE OFFSET A MINIMUM OF 2" FROM A LONGITUDINAL CRACK OR JOINT.
  2. THE CONTRACTOR SHALL CONTACT THE CITY OF FARMINGTON PRIOR TO RELOCATION OF STOP SIGNS.
  3. THE CITY SHALL FURNISH AND INSTALL ANY NEW APPLICABLE PARKING, CROSSWALK, 30 MPH SPEED LIMIT, AND OTHER TRAFFIC CONTROL SIGNS AS REQUIRED IN ACCORDANCE WITH THE MUTCD MANUAL. ALL SIGNS SHALL BE RELOCATED AND IN PLACE PRIOR TO OPENING THE STREET TO TRAFFIC.
  4. SEE THE TYPICAL ROADWAY SECTION FOR OTHER DETAILS.

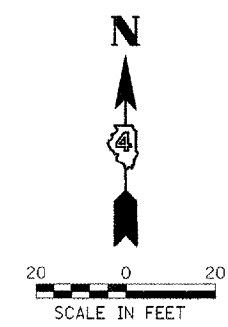

CITY OF FARMINGTON, ILLINOIS  
 LIGHTFOOT ROAD - 2400E  
 SECTION 05-00030-01-FP

PAVEMENT MARKING PLAN

Drawn by DRR		FILE NO. 24-7613
Date 11/06/06		Sheet No. PEO-7&13
Checked by DRR	2709 Seagraves Drive Springfield, Illinois 62704 217/252-2400 FAX 217/252-0670	SHEET NO. 25 OF 44