

SECTION #	TOTAL SHEETS	SHEET NO.
06-00447-12-PV	50	8

**#4001785**  
**EARTH EXCAVATION & EMBANKMENT**  
 NOTE: APPROXIMATE QUANTITIES  
 (FOR INFORMATION ONLY)  
 STAGE 2 = 71.5 CY CUT, 28.6 CY FILL  
 STAGE 3 = 161.3 CY CUT, 0.8 CY FILL  
 STAGE 4 = 98.5 CY CUT, 6.3 CY FILL  
 STA. 10+00 - 35+35 1.0 L.SUM

**44000159**  
**HMA SURF REM 2.5**  
 STA. 19+83 - 20+09 LT 14.2 SQ YD  
 STA. 19+91 - 20+18 RT 14.7 SQ YD

**44000500**  
**COMB CURB GUTTER REM**  
 STA. 13+65 - 19+85 LT 630.8 FT  
 STA. 15+58 - 19+92 RT 446.2 FT  
 STA. 20+07 - 35+87 LT 1,583.2 FT  
 STA. 20+16 - 35+90 RT 1,578.0 FT

**44000200**  
**DRIVE PAVEMENT REM**  
 STA. 20+91 LT 11.0 SQ YD  
 STA. 21+42 LT 10.5 SQ YD  
 STA. 21+93 RT 8.8 SQ YD  
 STA. 22+10 LT 11.3 SQ YD  
 STA. 22+54 RT 21.4 SQ YD  
 STA. 22+87 LT 12.4 SQ YD  
 STA. 23+54 LT 10.7 SQ YD  
 STA. 23+75 RT 19.9 SQ YD  
 STA. 24+09 LT 12.6 SQ YD  
 STA. 24+38 RT 11.1 SQ YD  
 STA. 24+93 RT 11.2 SQ YD  
 STA. 25+21 LT 10.3 SQ YD  
 STA. 25+42 RT 10.8 SQ YD  
 STA. 26+09 RT 11.7 SQ YD  
 STA. 26+18 LT 11.7 SQ YD  
 STA. 26+76 RT 10.9 SQ YD  
 STA. 26+87 LT 9.3 SQ YD  
 STA. 27+40 RT 10.1 SQ YD  
 STA. 27+89 LT 9.1 SQ YD  
 STA. 28+03 RT 11.6 SQ YD  
 STA. 28+44 LT 11.8 SQ YD  
 STA. 28+71 RT 11.6 SQ YD  
 STA. 28+95 LT 11.3 SQ YD

**44000600**  
**SIDEWALK REM**  
 STA. 19+12 LT 169.0 SQ FT  
 STA. 19+50 RT 11.6 SQ FT  
 STA. 19+50 LT 19.2 SQ FT  
 STA. 19+65 LT 98.0 SQ FT  
 STA. 19+70 RT 20.0 SQ FT  
 STA. 19+70 LT 20.0 SQ FT  
 STA. 20+24 LT 20.0 SQ FT  
 STA. 20+27 RT 20.0 SQ FT  
 STA. 20+55 LT 19.8 SQ FT  
 STA. 20+70 RT 20.0 SQ FT  
 STA. 21+20 LT 17.6 SQ FT  
 STA. 21+22 RT 20.3 SQ FT  
 STA. 21+31 RT 128.5 SQ FT  
 STA. 21+70 RT 19.4 SQ FT  
 STA. 21+71 LT 50.5 SQ FT  
 STA. 21+72 RT 75.0 SQ FT  
 STA. 21+80 LT 19.5 SQ FT  
 STA. 22+25 RT 20.0 SQ FT  
 STA. 22+36 RT 237.5 SQ FT  
 STA. 23+25 LT 21.5 SQ FT  
 STA. 23+29 RT 92.5 SQ FT  
 STA. 23+60 RT 18.0 SQ FT

**44000600**  
**SIDEWALK REM**  
 STA. 24+04 LT 60.0 SQ FT  
 STA. 24+34 RT 93.0 SQ FT  
 STA. 24+65 LT 25.3 SQ FT  
 STA. 24+75 RT 20.4 SQ FT  
 STA. 24+79 RT 25.0 SQ FT  
 STA. 25+24 RT 69.5 SQ FT  
 STA. 25+25 RT 20.5 SQ FT  
 STA. 25+75 RT 21.0 SQ FT  
 STA. 25+85 LT 16.0 SQ FT  
 STA. 26+50 RT 16.8 SQ FT  
 STA. 26+60 LT 17.5 SQ FT  
 STA. 27+18 RT 18.0 SQ FT  
 STA. 27+20 LT 44.5 SQ FT  
 STA. 27+77 RT 14.0 SQ FT  
 STA. 27+77 LT 13.6 SQ FT  
 STA. 28+23 LT 19.3 SQ FT  
 STA. 28+36 LT 66.5 SQ FT  
 STA. 28+38 RT 17.0 SQ FT  
 STA. 28+46 RT 25.0 SQ FT  
 STA. 28+75 LT 24.7 SQ FT

**44004400**  
**PAVEMENT REM SPL**  
 STA. 19+00 - 29+00 3,666.7 SQ YD  
 STA. 19+80 - 20+20 LT 22.0 SQ YD  
 STA. 19+83 - 20+25 RT 20.3 SQ YD

**60500060**  
**REMOV INLETS**  
 STA. 19+87 RT 1.0 EACH  
 STA. 19+77 LT 1.0 EACH  
 STA. 20+14 LT 1.0 EACH  
 STA. 20+23 RT 1.0 EACH  
 STA. 24+19 RT 1.0 EACH  
 STA. 24+19 LT 1.0 EACH

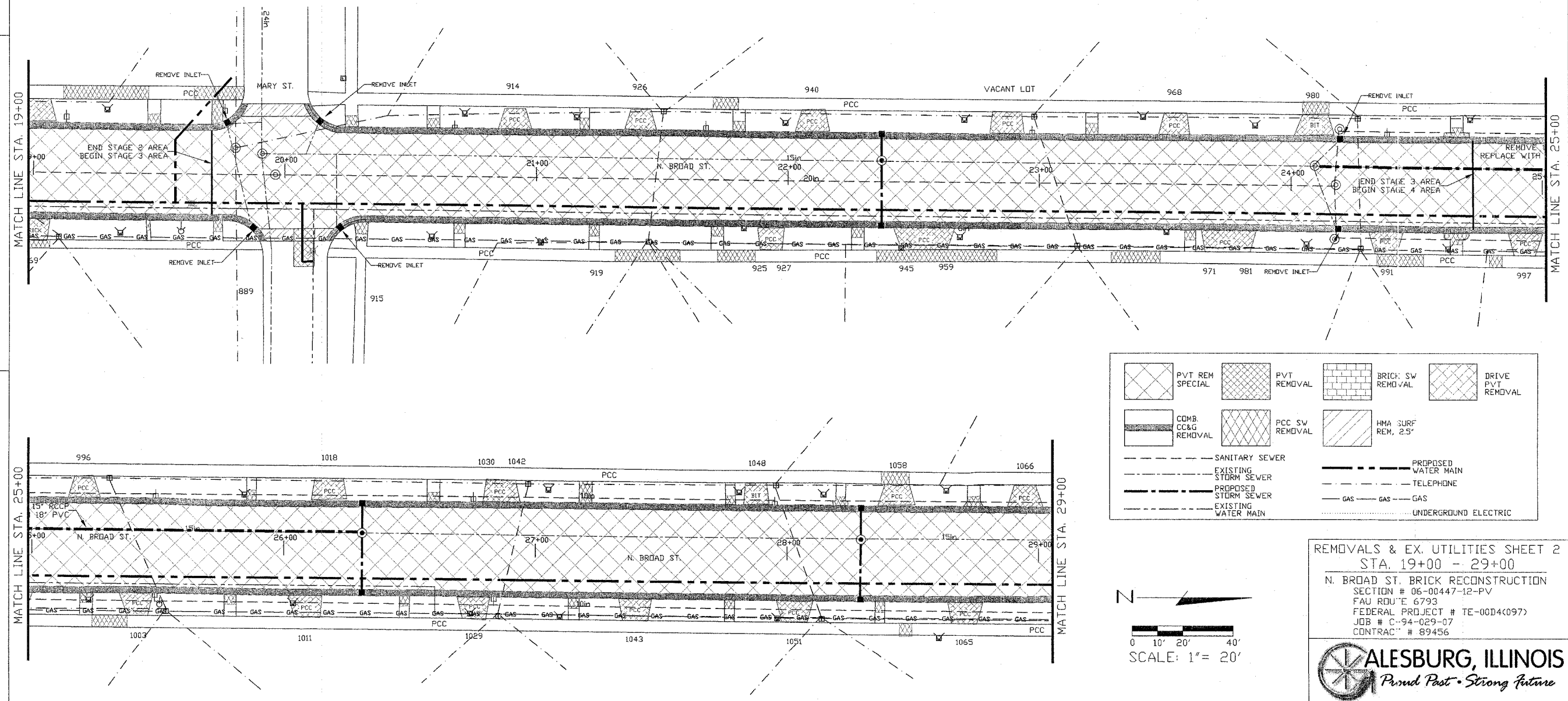

	PVT REM SPECIAL		PVT REMOVAL		BRICK SW REMOVAL		DRIVE PVT REMOVAL
	COMB. CURB GUTTER REMOVAL		PCC SW REMOVAL		HMA SURF REM. 2.5'		
SANITARY SEWER EXISTING STORM SEWER PROPOSED STORM SEWER EXISTING WATER MAIN				PROPOSED WATER MAIN TELEPHONE GAS UNDERGROUND ELECTRIC			

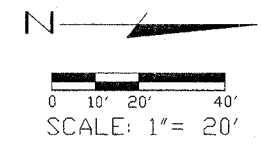

**REMOVALS & EX. UTILITIES SHEET 2**  
 STA. 19+00 - 29+00  
 N. BROAD ST. BRICK RECONSTRUCTION  
 SECTION # 06-00447-12-PV  
 FAU ROUTE 6793  
 FEDERAL PROJECT # TE-00D4(097)  
 JOB # C-94-029-07  
 CONTRACT # 89456

