

40600625 LEV BIND MM N50	STA. 13+37 - 13+76 LT	1.0 TON
40603335 HMA SC "D" N50	STA. 13+37 - 13+76 LT	3.1 TON
42400800 DETECTABLE WARNINGS	STA. 13+41 LT	8.0 SQ FT
	STA. 13+67 LT	8.0 SQ FT
60604400 COMB. CC&G TB6.18	STA. 13+56 - 14+84 LT	536.8 FT
	STA. 10+00 - 13+45 LT	352.4 FT
	STA. 13+65 - 19+85 LT	630.8 FT
550B0120 STORM SEW CL B 1 24	STA. 13+56 - 14+84 LT	127.8 FT
	STA. 14+88 - 15+47 LT	60.2 FT

42400100 PC CONCRETE SIDEWALK 4	STA. 12+56 RT	102.5 SQ FT
	STA. 12+61 LT	396.5 SQ FT
	STA. 12+80 RT	17.6 SQ FT
	STA. 12+80 LT	19.8 SQ FT
	STA. 13+30 LT	20.9 SQ FT
	STA. 13+41 LT	46.5 SQ FT
	STA. 13+45 RT	22.0 SQ FT
	STA. 14+05 LT	17.2 SQ FT
	STA. 14+25 RT	16.0 SQ FT
	STA. 14+34 RT	217.5 SQ FT
	STA. 14+60 LT	41.6 SQ FT
	STA. 14+83 LT	28.0 SQ FT
	STA. 14+91 RT	152.6 SQ FT
	STA. 14+95 RT	17.8 SQ FT
K1005863 TREE ROOT PRUNING	STA. 12+30 LT	1.0 EACH
	STA. 13+08 LT	1.0 EACH
	STA. 13+32 LT	1.0 EACH
	STA. 14+25 LT	1.0 EACH
	STA. 15+00 RT	1.0 EACH

42300200 PCC DRIVEWAY PAVT 6	STA. 12+41 RT	15.0 SQ YD
	STA. 13+00 RT	20.0 SQ YD
	STA. 13+00 LT	14.7 SQ YD
	STA. 13+73 RT	15.0 SQ YD
	STA. 14+41 RT	14.8 SQ YD
	STA. 15+00 LT	14.5 SQ YD
K1005881 TREE TRUNK PROTECTION	STA. 13+08 LT	1.0 EACH

60235700 INLETS TA T3F&G	STA. 12+55 R&L	2.0 EACH
	STA. 13+11 LT	1.0 EACH
	STA. 13+32 LT	1.0 EACH
	STA. 13+37 RT	1.0 EACH
	STA. 13+83 LT	1.0 EACH
	STA. 14+86 LT	1.0 EACH

42400460 PC CONCRETE SIDEWALK 8 SP	STA. 13+41 LT	23.5 SQ FT
	STA. 13+67 LT	26.5 SQ FT
#4001772 CONCRETE HEADER	STA. 13+34 - 13+78 LT	1.0 EACH
#4001770 BRICK SIDEWALK	STA. 12+50 LT	34.0 SQ FT
	STA. 13+67 LT	60.0 SQ FT
	STA. 13+72 LT	132.5 SQ FT
	STA. 14+11 LT	121.0 SQ FT

550B0050 STORM SEW CL B 1 12	STA. 12+55 RT	23.6 FT
	STA. 12+55 LT	7.8 FT
	STA. 12+56 - 13+52 LT	95.8 FT
	STA. 13+10 LT	20.0 FT
	STA. 13+32 - 13+40 LT	7.8 FT
	STA. 13+37 - 13+51 RT	13.6 FT
	STA. 13+41 - 13+54 LT	17.4 FT
	STA. 13+53 RT	24.2 FT
	STA. 13+54 - 13+71 LT	20.5 FT
	STA. 13+72 - 13+82 LT	10.4 FT
	STA. 14+86 RT	23.6 FT
	STA. 14+86 LT	8.0 FT
	STA. 14+87 - 15+20 RT	34.3 FT

60240220 INLETS TB T3F&G	STA. 13+41 LT	1.0 EACH
	STA. 13+55 RT	1.0 EACH
	STA. 13+72 LT	1.0 EACH
	STA. 14+86 RT	1.0 EACH
60218400 MAN TA 4 DIA T1F CL	STA. 12+55 LT	1.0 EACH
60221100 MAN TA 5 DIA T1F CL	STA. 14+86 LT	1.0 EACH
60223800 MAN TA 6 DIA T1F CL	STA. 13+54 LT	1.0 EACH

20800150 TRENCH BACKFILL	STA. 12+55 RT	3.4 CU YD
	STA. 12+55 LT	1.2 CU YD
	STA. 12+57 - 13+51 LT	19.5 CU YD
	STA. 13+10 LT	2.5 CU YD
	STA. 13+32 - 13+40 LT	1.0 CU YD
	STA. 13+37 - 13+51 RT	2.2 CU YD
	STA. 13+41 - 13+54 LT	3.0 CU YD
	STA. 13+53 RT	5.0 CU YD
	STA. 13+54 - 13+71 LT	3.9 CU YD
	STA. 13+56 - 14+84 LT	14.9 CU YD
	STA. 13+72 - 13+82 LT	1.5 CU YD
	STA. 14+86 RT	3.2 CU YD
	STA. 14+86 LT	1.1 CU YD
	STA. 14+87 - 15+20 RT	3.6 CU YD
	STA. 14+88 - 15+47 LT	7.0 CU YD

SECTION #	TOTAL SHEETS	SHEET NO.
06-0047-12-PV	50	11

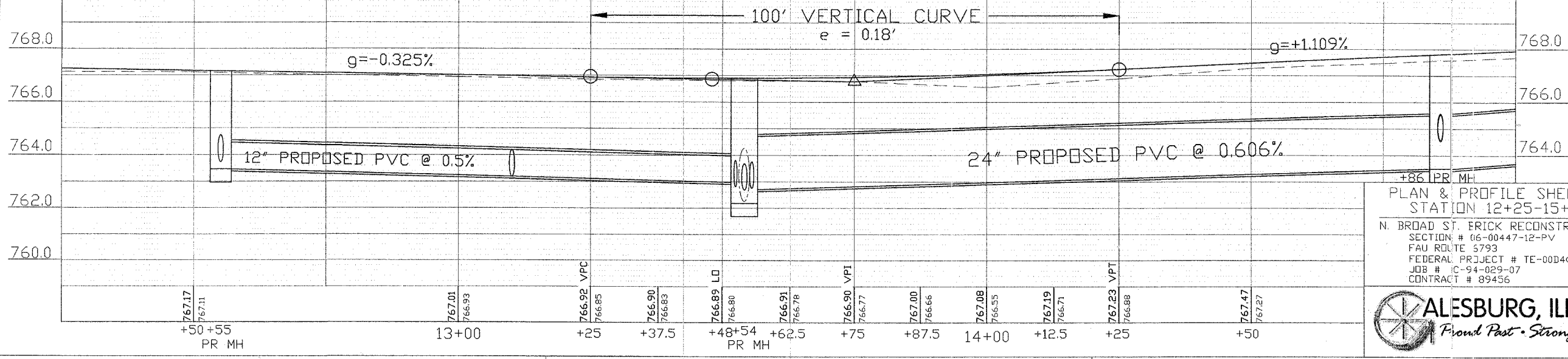
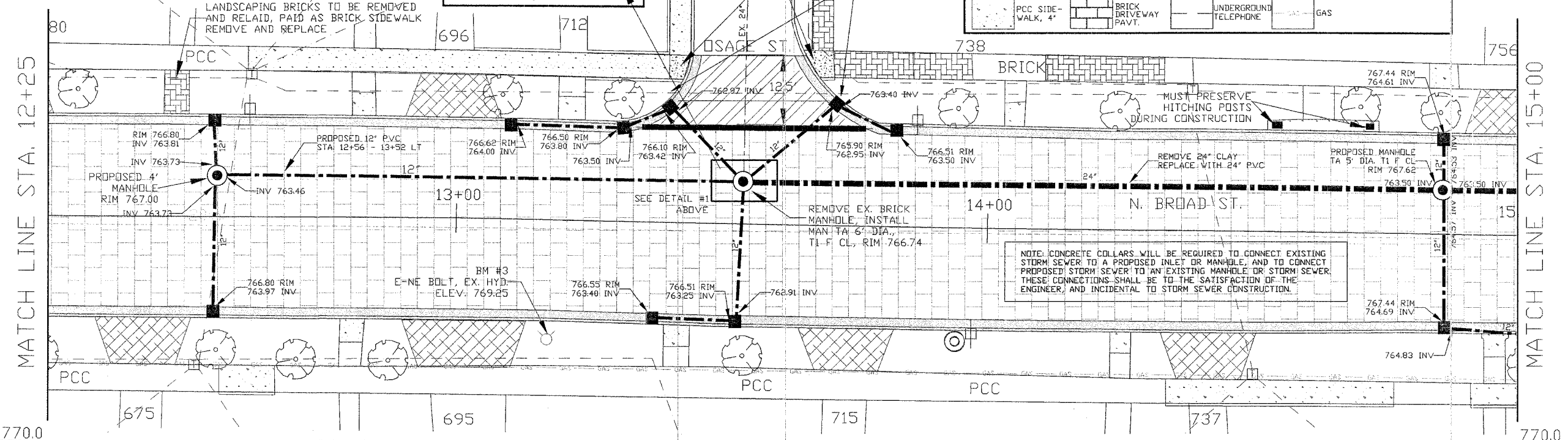
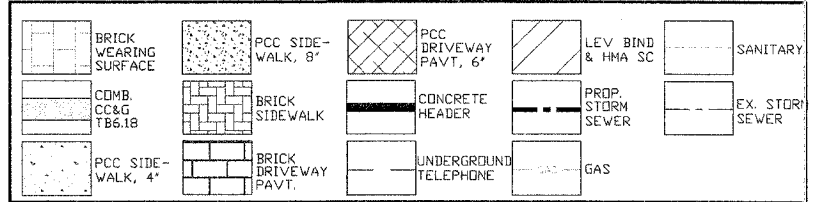
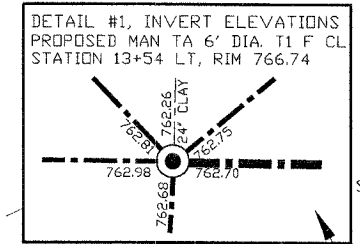
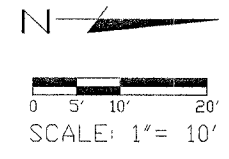

+86 IPR MH
PLAN & PROFILE SHEET 2
STATION 12+25-15+00
 N. BROAD ST. ERICK RECONSTRUCTION
 SECTION # 06-00447-12-PV
 FAU ROUTE 5793
 FEDERAL PROJECT # TE-00D4(097)
 JOB # IC-94-029-07
 CONTRACT # 89456