

ROUTE NO.	SECTION	COUNTY	TOTAL SHEETS	SHEET NO.
--	05-00154-00-BR	VERMILION	54	10
STA. TO STA.		F.H.W.A. REC. ILLINOIS PROJECT		

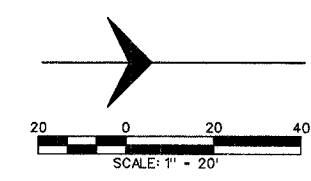

PLAN

DATE	BY
SURVEYED	
PLOTTED	
CHECKED	
NO. OF WAY CHECKED	
NO.	

PROFILE

DATE	BY
SURVEYED	
PLOTTED	
CHECKED	
NO. OF WAY CHECKED	
NO.	

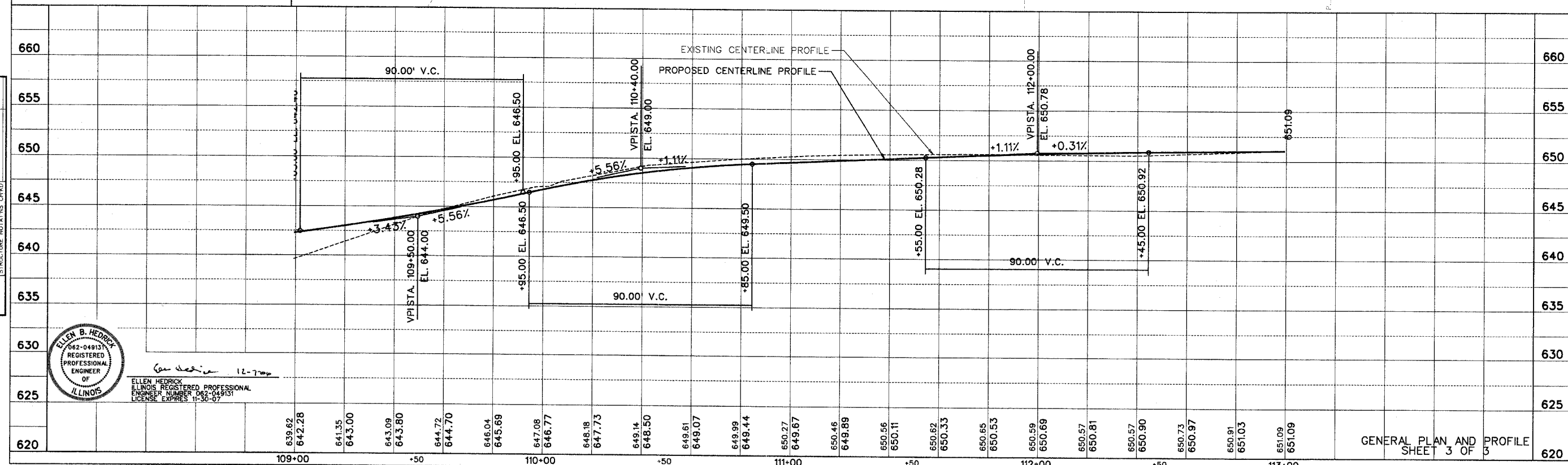
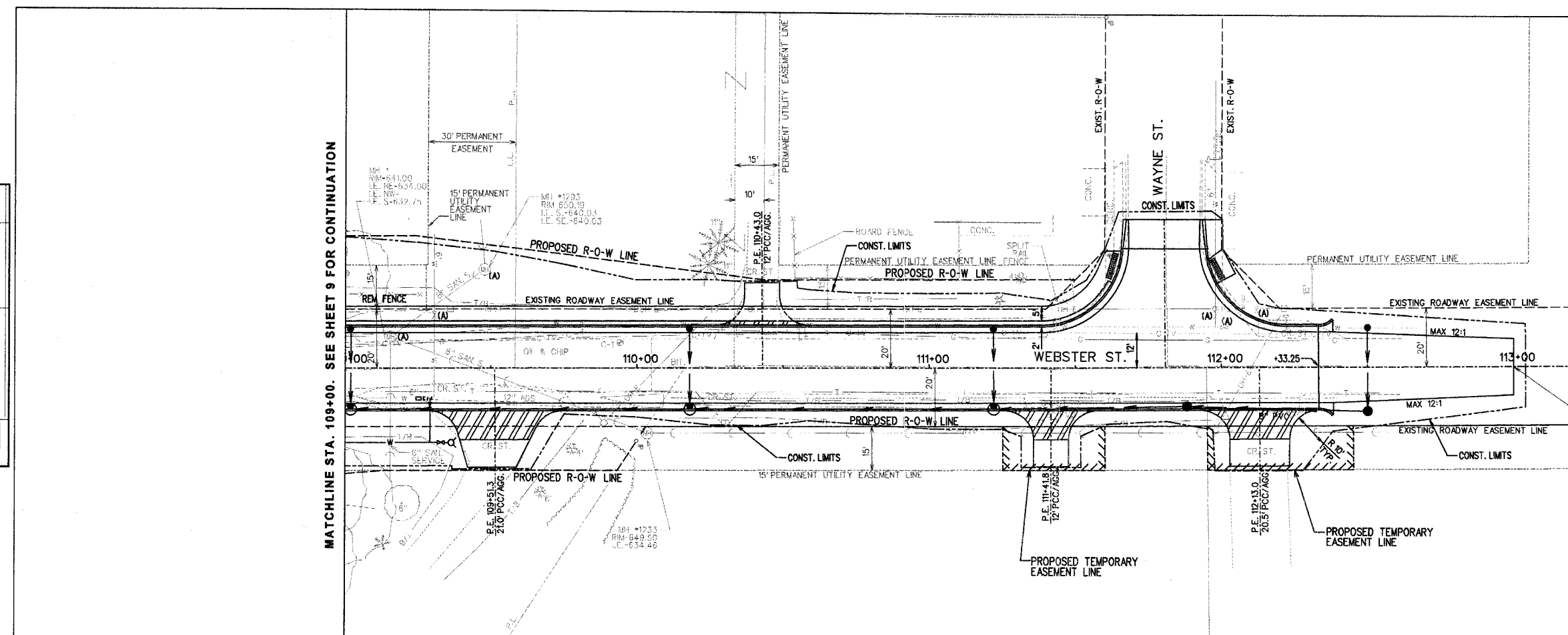

ELLEN B. HEDRICK
 062-04913
 REGISTERED PROFESSIONAL ENGINEER
 OF ILLINOIS
 LICENSE EXPIRES 11-30-04

GENERAL PLAN AND PROFILE
 SHEET 3 OF 3

\\Plan sheets\Plan 3.dgn 12/6/2006 1:02:02 PM