

ROUTE NO.	SECTION	COUNTY	TOTAL SHEETS	SHEET NO.
--	05-00154-00-BR	VERMILION	54	12
STA.	TO STA.	F.M.W.A. REG. ILLINOIS PROJECT		

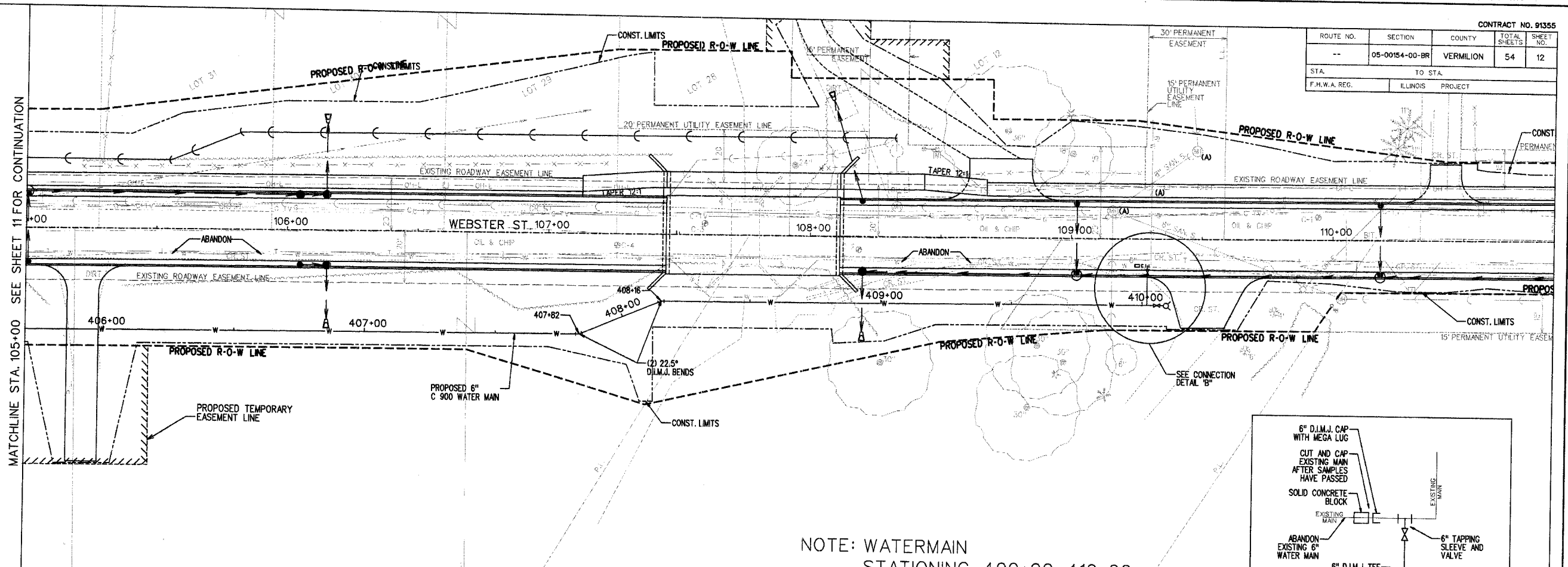

MATCHLINE STA. 105+00 SEE SHEET 11 FOR CONTINUATION

NOTE: WATERMAIN STATIONING 400+00~410+00

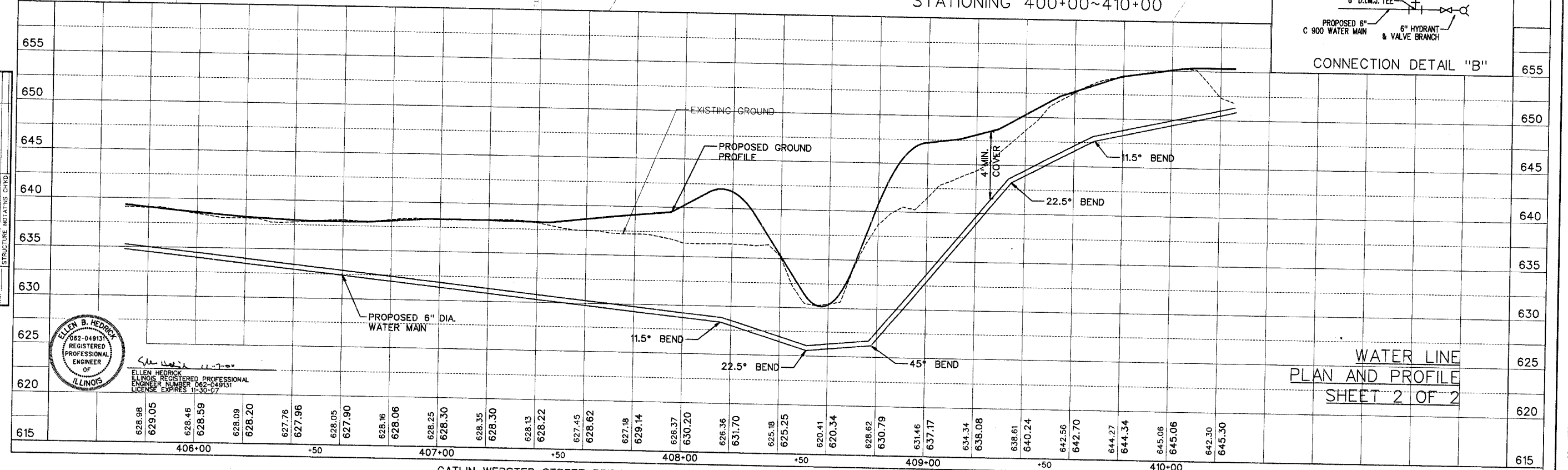
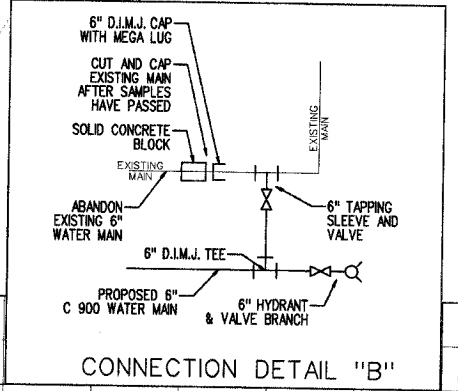

WATER LINE  
PLAN AND PROFILE  
SHEET 2 OF 2

PLAN

BY	DATE
SURVEYED	
PLOTTED	
GRADES CHECKED	
NOTE BOOK	
RT. OF WAY CHECKED	
NO.	

PROFILE

BY	DATE
SURVEYED	
PLOTTED	
GRADES CHECKED	
NOTE BOOK	
STRUCTURE NOTATION CHKD.	
NO.	



ELLEN B. HEDRICK  
REGISTERED PROFESSIONAL ENGINEER  
ILLINOIS  
ENGINEER NUMBER 082-049131  
LICENSE EXPIRES 11-30-07