

ROUTE NO.	SECTION	COUNTY	TOTAL SHEETS	SHEET NO.
--	05-00154-00-BR	VERMILION	54	16
STA. TO STA.		ILLINOIS PROJECT		
F.H.W.A. REG.		PROJECT		

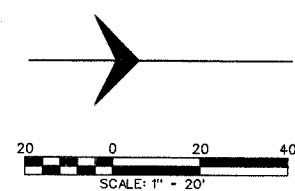

PLAN

SURVEYED	BY	DATE
PLOTTED		
ALIGNED		
CHECKED		
NO. OF WAY		
CHECKED		
NO.		

PROFILE

SURVEYED	BY	DATE
PROCESSED		
NOTED		
STRUCTURE		
NOTATIONS		
CHKD		
NO.		

MATCHLINE STA. 105+00 SEE SHEET 15 FOR CONTINUATION

MATCHLINE STA. 109+00 SEE SHEET 17 FOR CONTINUATION

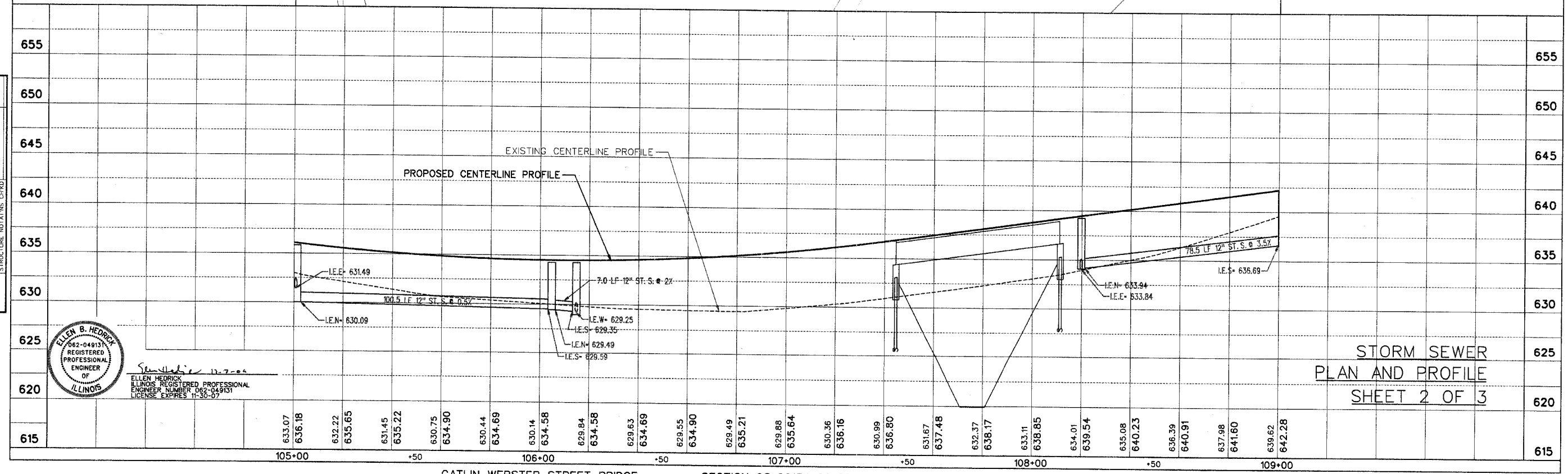
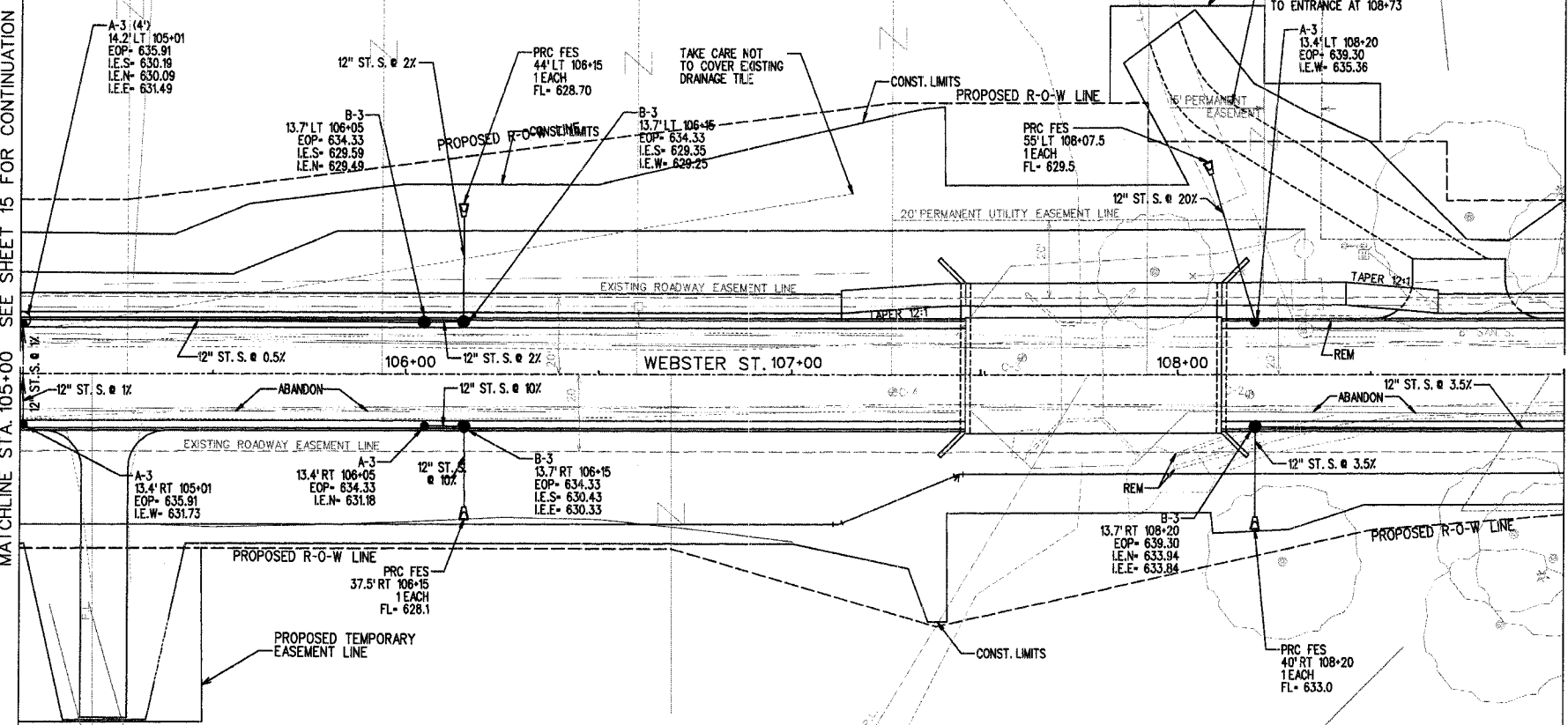

ELLEN B. HEDRICK
 062-04913
 REGISTERED PROFESSIONAL ENGINEER OF ILLINOIS
 ELLEN HEDRICK
 ILLINOIS REGISTERED PROFESSIONAL ENGINEER NUMBER 062-04913
 LICENSE EXPIRES 11-30-07

STORM SEWER
 PLAN AND PROFILE
 SHEET 2 OF 3