

ROUTE NO.	SECTION	COUNTY	TOTAL SHEETS	SHEET NO.
--	05-00154-00-BR	VERMILION	54	17
STA. TO STA.		F.H.W.A. REG. ILLINOIS PROJECT		

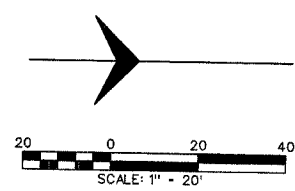

PLAN	DATE
SURVEYED	
PLOTTED	
CHECKED	
NOTE BOOK NO.	
RT. OF WAY CHECKED	

PROFILE	DATE
SURVEYED	
PLOTTED	
CHECKED	
NOTE BOOK NO.	
STRUCTURE NOTATIONS CHD'D	

MATCHLINE STA. 109+00 SEE SHEET 16 FOR CONTINUATION

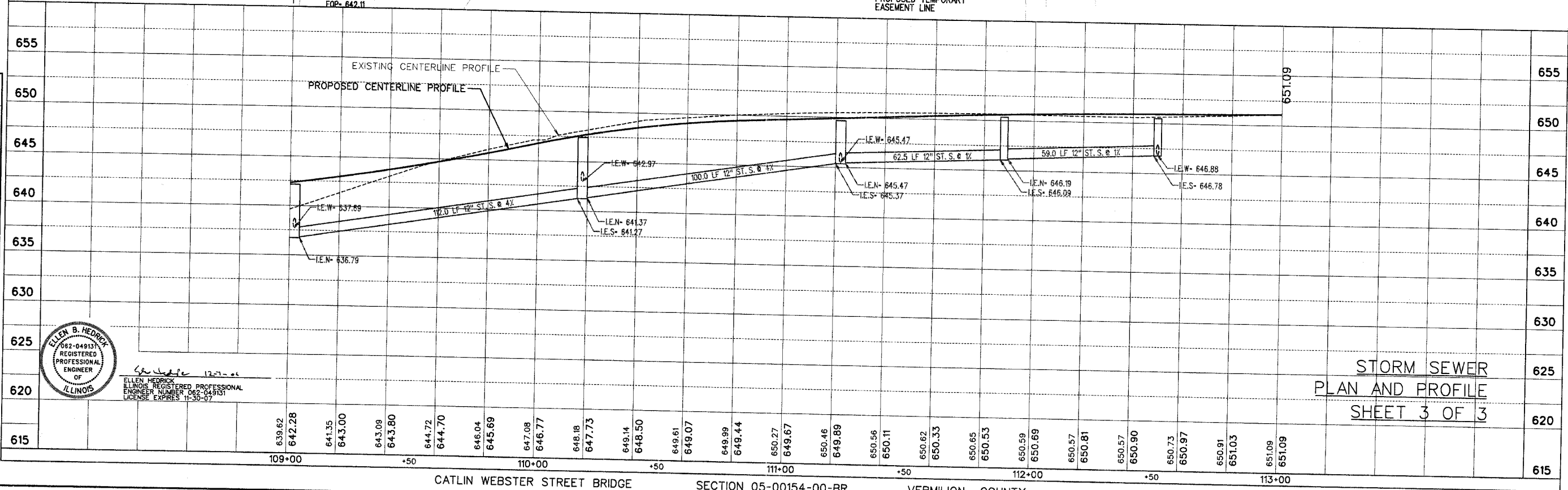
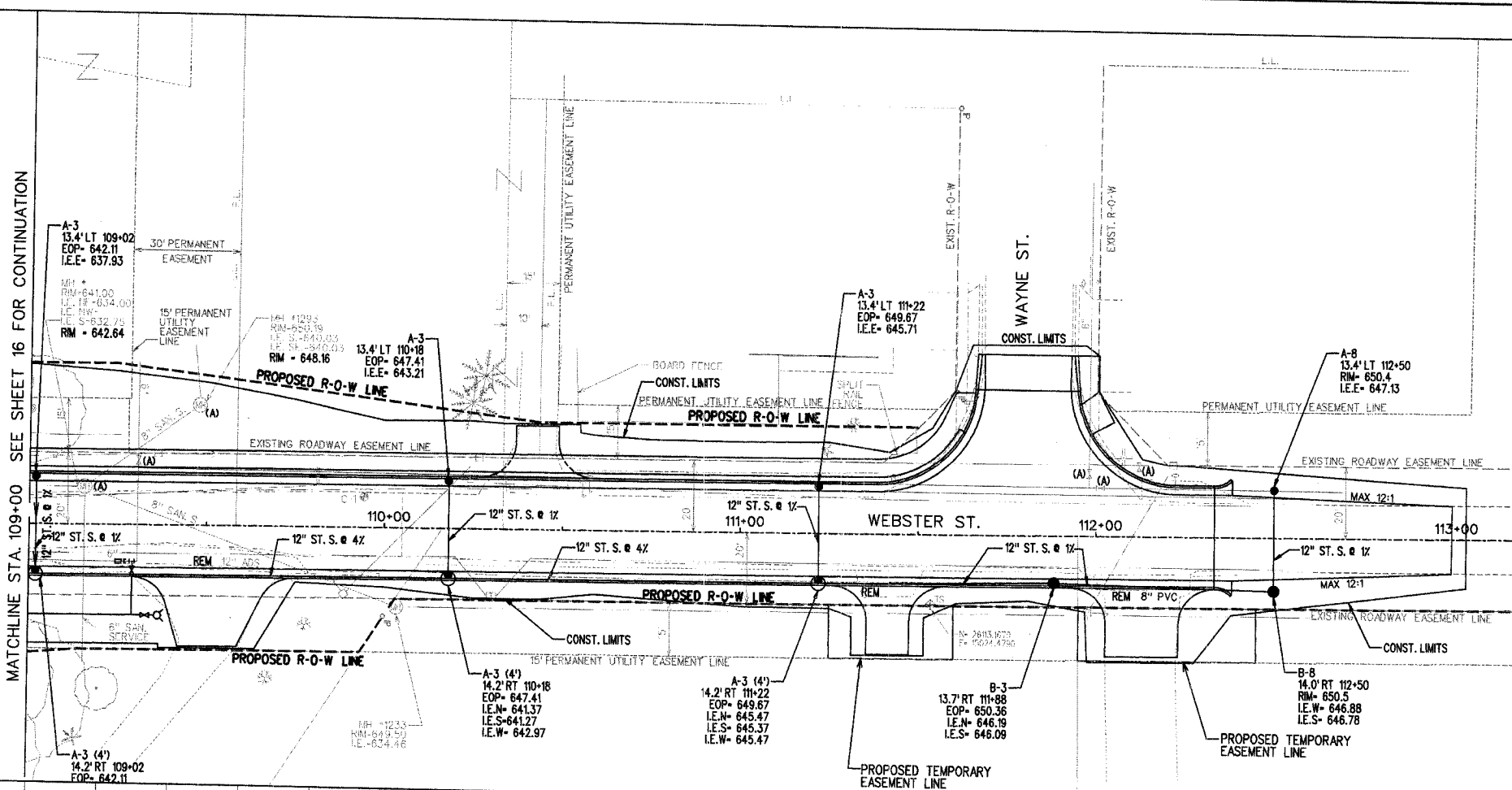

ELLEN B. HEDRICK
ILLINOIS REGISTERED PROFESSIONAL ENGINEER
LICENSE NUMBER 062-04913
LICENSE EXPIRES 11-30-07

STORM SEWER
PLAN AND PROFILE
SHEET 3 OF 3