

ROUTE NO.	SECTION	COUNTY	SHEET NO.	SHEET
FAS 507	*	VERMILION	54	18
"REG. ROAD CONTRACT"		"ILLINOIS" "REG. ROAD PROJECT"		

\* 05-00154-00-BR

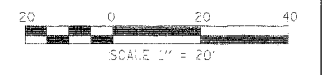

**INTENDED SEQUENCE**

1. Place of the perimeter erosion control barrier prior to the commencement of any work. See Standard 280001.
2. Prepare utilities requiring relocation.
3. Construct Embankment.
4. Remove the existing structure.
5. Construct new substructure.
6. Construct new superstructure.
7. Place and maintain temporary erosion controls.
8. Grade and shape, including the placing aggregate base courses, surface courses, and bituminous layer.
9. Remove and properly clean up temporary erosion controls.
10. Place permanent erosion controls.

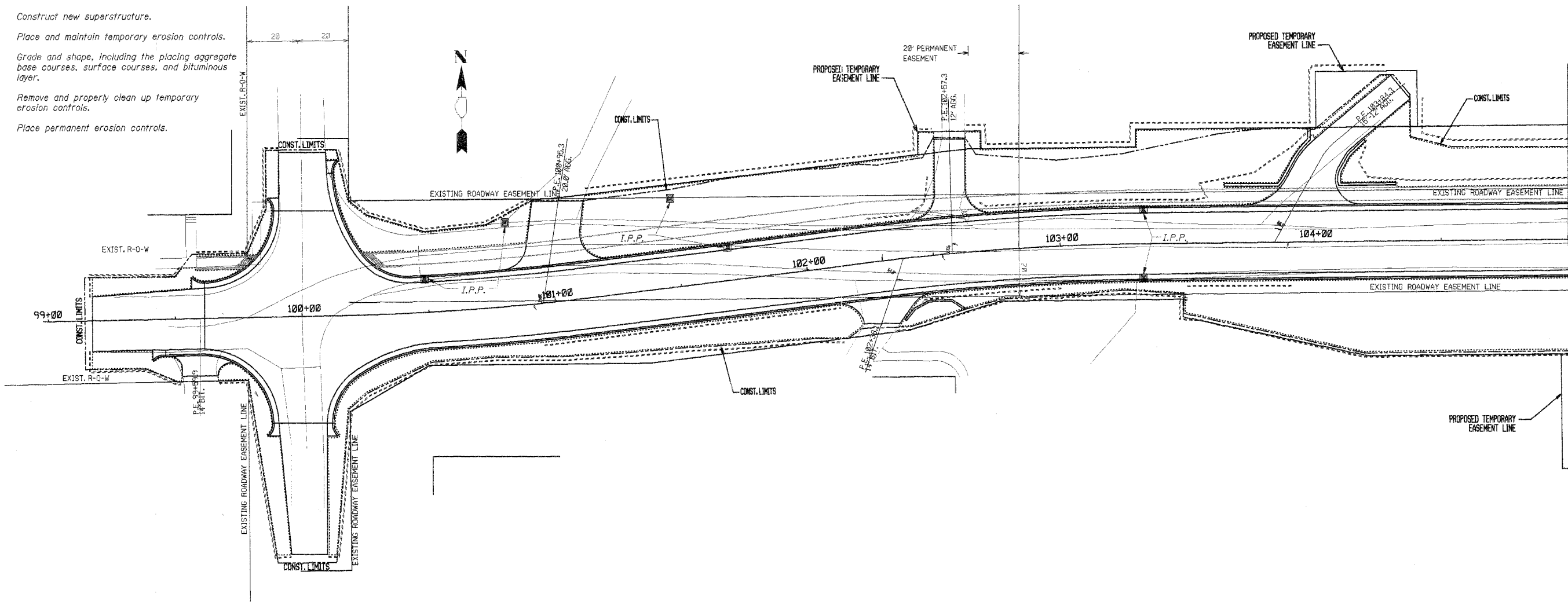

**PERMANENT EROSION CONTROL**

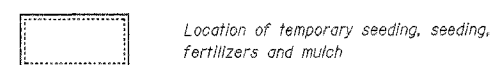

**TEMPORARY EROSION CONTROL**

- Temporary Ditch Check
- Perimeter Erosion Barrier
- I.P.P. Inlet and Pipe Protection

**TEMPORARY EROSION CONTROL  
BILL OF MATERIALS**

ITEM	UNIT	QUANTITY
Seeding, Class 2	Acre	1.1
Nitrogen Fertilizer Nutrient	Pound	99
Phosphorus Fertilizer Nutrient	Pound	99
Potassium Fertilizer Nutrient	Pound	99
Temporary Seeding	Acre	1.1
Mulch, Method 2	Acre	1.1
Temporary Ditch Checks	Each	1
Perimeter Erosion Barrier	Foot	3,620
Inlet And Pipe Protection	Each	23