

FINAL SURVEY  
 DRAWING NO. \_\_\_\_\_  
 DATE \_\_\_\_\_  
 BY \_\_\_\_\_  
 CHECKED \_\_\_\_\_  
 DATE \_\_\_\_\_

ORIGINAL SURVEY  
 DRAWING NO. \_\_\_\_\_  
 DATE \_\_\_\_\_  
 BY \_\_\_\_\_  
 CHECKED \_\_\_\_\_  
 DATE \_\_\_\_\_

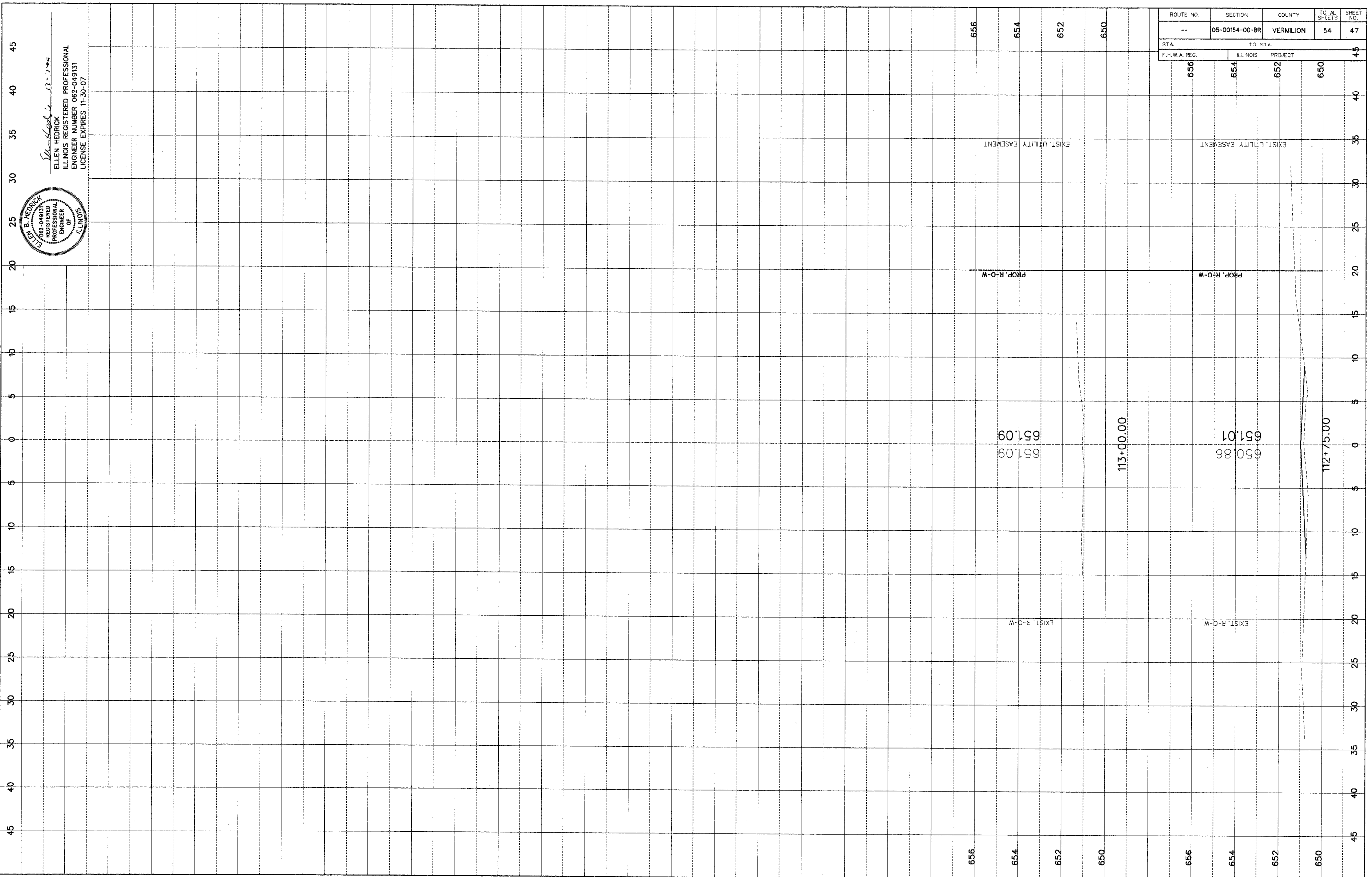

*Ellen Hedrick*  
 ELLEN HEDRICK  
 ILLINOIS REGISTERED PROFESSIONAL  
 ENGINEER NUMBER 062-049131  
 LICENSE EXPIRES 11-30-07

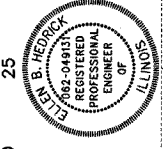

ROUTE NO.	SECTION	COUNTY	TOTAL SHEETS	SHEET NO.
--	05-00154-00-BR	VERMILION	54	47

STA.	TO STA.	F.H.W.A. REC.	ILLINOIS PROJECT
656	650		

...\\05057 Cross Section Sheets.dgn 12/5/2006 5:19:04 PM