

| | | | |
|---------------------|----------------|----------|------------------|
| F.A.S. RTE. | SECTION | COUNTY | TOTAL SHEET NO. |
| 473 | 05-00046-12-RP | McLEAN | 32 |
| STA. 41+00 | TO STA. 47+00 | | 9 |
| FED. ROAD DIST. NO. | | ILLINOIS | FED. AID PROJECT |
| CONTRACT NO. 91370 | | | |

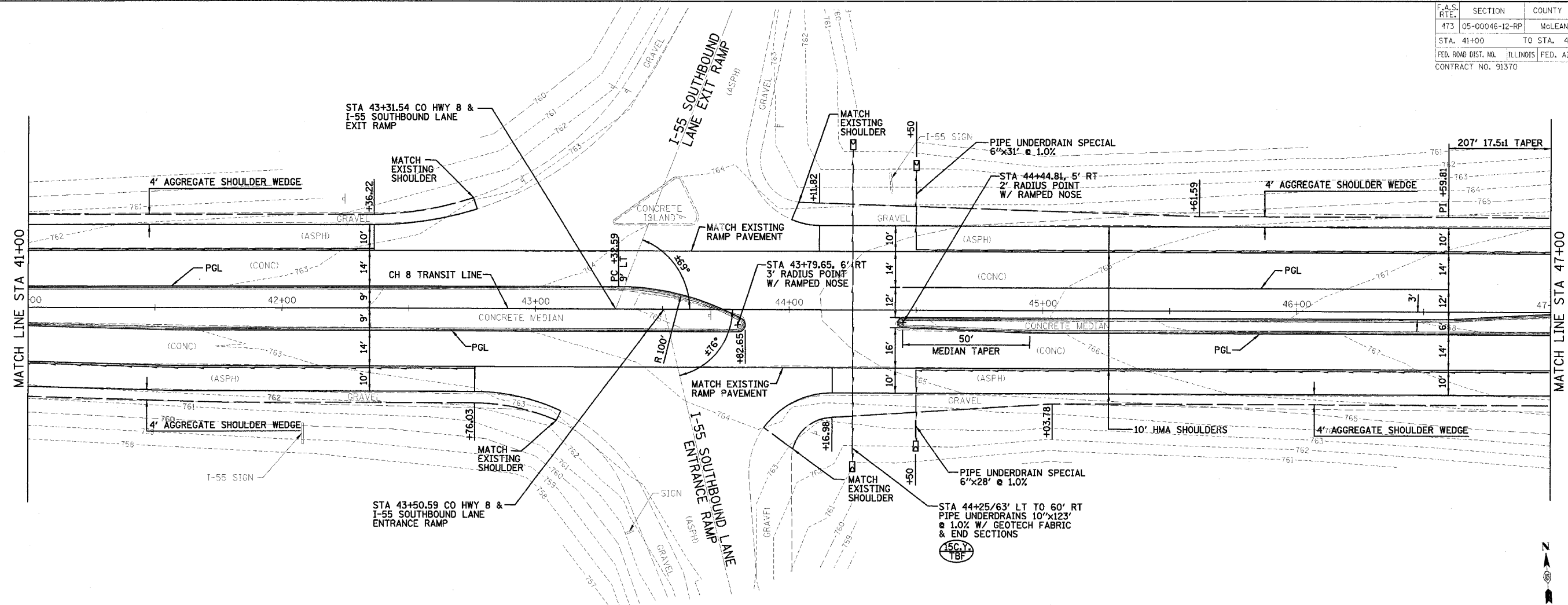

CO HWY 8 LEXINGTON OVERPASS

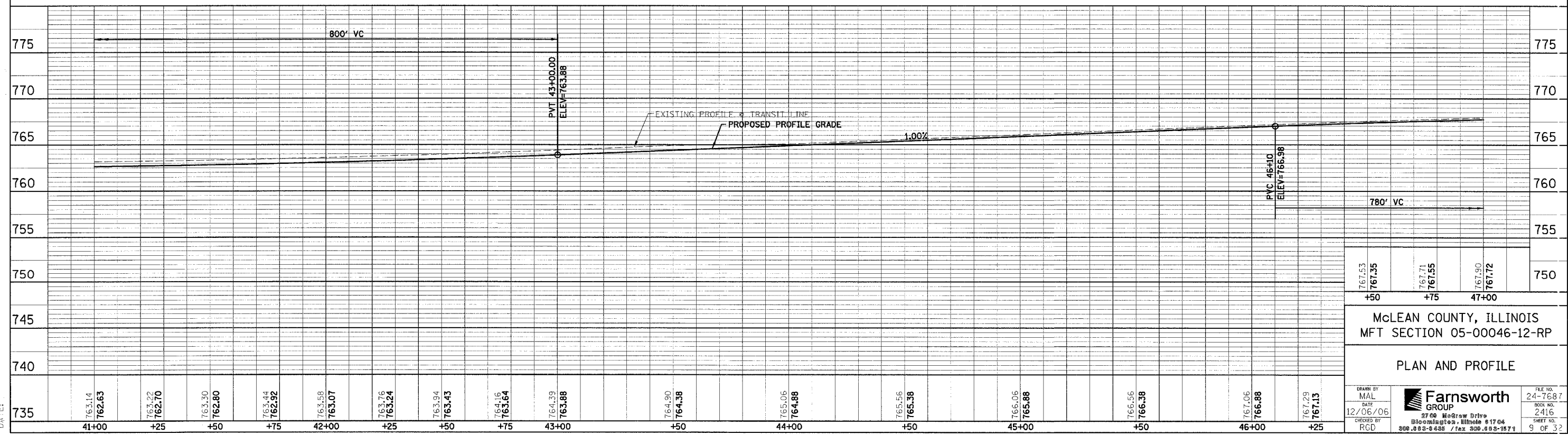

| | | | | | |
|---|------------------|---|--------|----------------------|-------------------|
| 767.53 | 767.35 | 767.71 | 767.55 | 767.90 | 767.72 |
| +50 | +75 | 47+00 | | | |
| McLEAN COUNTY, ILLINOIS MFT SECTION 05-00046-12-RP | | | | | |
| PLAN AND PROFILE | | | | | |
| DRAWN BY MAL | DATE 12/06/06 | Farnsworth GROUP 2700 McGraw Drive Bloomington, Illinois 61704 800.885-6456 / Fax 800.885-1571 | | FILE NO. 24-7687 | BOOK NO. 2.416 |
| CHECKED BY RGD | | | | SHEET NO. 9 OF 32 | |

FILE:
DATE: