

F.A.S. RTE.	SECTION	COUNTY	TOTAL SHEETS	SHEET NO.
473	05-00046-12-RP	McLEAN	32	13
STA.		TO STA.		
FED. ROAD DIST. NO.		ILLINOIS FED. AID PROJECT		
CONTRACT NO. 91370				

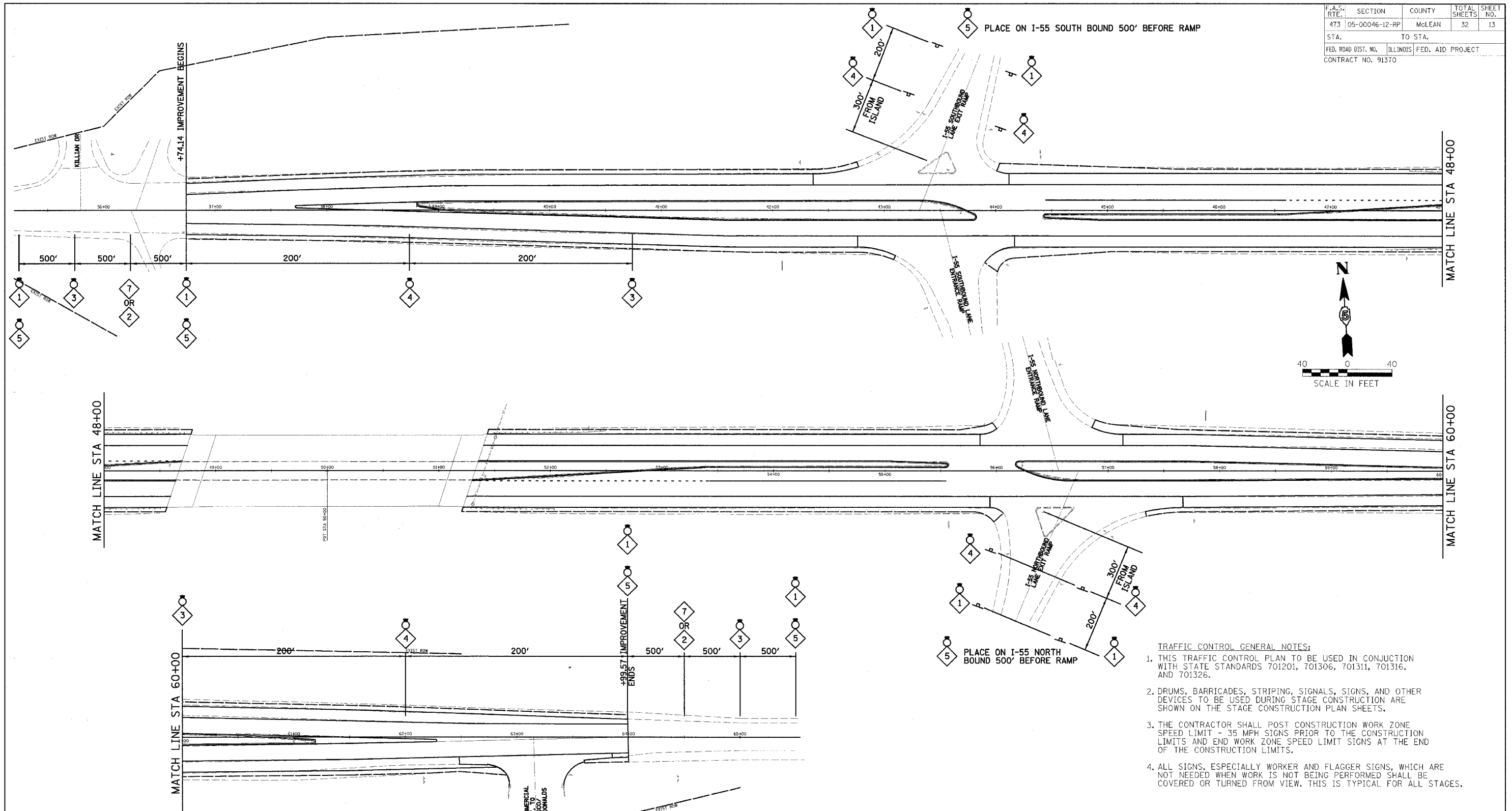

- TRAFFIC CONTROL GENERAL NOTES:**
1. THIS TRAFFIC CONTROL PLAN TO BE USED IN CONJUNCTION WITH STATE STANDARDS 701201, 701306, 701311, 701316, AND 701326.
 2. DRUMS, BARRICADES, STRIPING, SIGNALS, SIGNS, AND OTHER DEVICES TO BE USED DURING STAGE CONSTRUCTION ARE SHOWN ON THE STAGE CONSTRUCTION PLAN SHEETS.
 3. THE CONTRACTOR SHALL POST CONSTRUCTION WORK ZONE SPEED LIMIT - 35 MPH SIGNS PRIOR TO THE CONSTRUCTION LIMITS AND END WORK ZONE SPEED LIMIT SIGNS AT THE END OF THE CONSTRUCTION LIMITS.
 4. ALL SIGNS, ESPECIALLY WORKER AND FLAGGER SIGNS, WHICH ARE NOT NEEDED WHEN WORK IS NOT BEING PERFORMED SHALL BE COVERED OR TURNED FROM VIEW. THIS IS TYPICAL FOR ALL STAGES.

LEGEND

W20 - 1(0)	W21 - 1a(0) OR W21 - 1110(0)	W20 - 4(0) - 48	W3 - 3(0) - 48	W1 - 6(0) - 4824	W20 - 7A(0) - 48 OR W20 - 1110(0) - 48	

48"x48" SIGN WITH BLACK LETTERS ON ORANGE BLACKGROUND

PLACED 200' MIN. AHEAD OF LANE SHIFT OR AS SHOWN ON STAGE CONSTRUCTION PLANS

McLEAN COUNTY, ILLINOIS
MFT SECTION 05-00046-12-RP

TRAFFIC CONTROL PLAN

DRAWN BY MAL	 Farnsworth GROUP 2700 McGraw Drive Bloomington, Illinois 61704 309.898-2435 / fax 309.898-1871	FILE NO. 24-7687
DATE 12/06/06		BOOK NO. 2416
CHECKED BY RGD		SHEET NO. 13 OF 32