

ROUTE NO. F.A.S. 696	SECTION 08-00262 -00-RS	COUNTY CLARK	TOTAL SHEETS 27	SHEET NO. 1
----------------------------	-------------------------------	-----------------	--------------------	----------------

FED. ROAD DIST. NO. ILLINOIS FED. AID PROJECT-  
CONTRACT NO. 95487

# STATE OF ILLINOIS DEPARTMENT OF TRANSPORTATION DIVISION OF HIGHWAYS PLANS FOR PROPOSED SURFACE TRANSPORTATION PROGRAM-RURAL

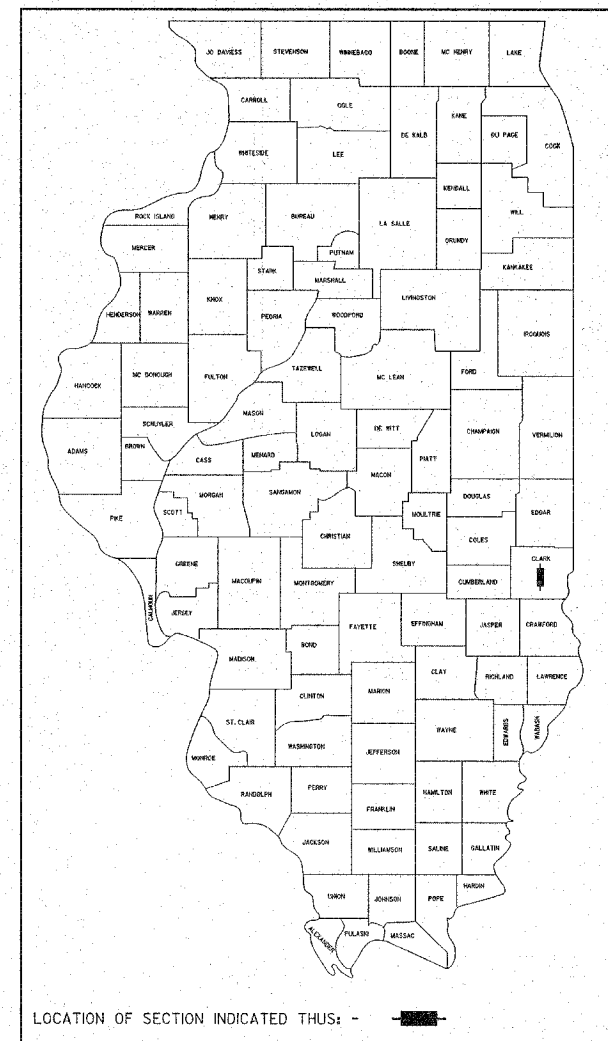

- INDEX OF SHEETS**
1. COVER SHEET
  2. SUMMARY OF QUANTITIES, GENERAL NOTES AND ALIGNMENT TABLE
  3. SCHEDULE OF QUANTITIES
  4. TYPICAL CROSS SECTIONS
  - 5.-26. PLAN AND PROFILE
  27. SPECIAL DETAILS

SEE PROPOSAL BOOKLET FOR HIGHWAY STANDARDS:

- |           |  |
|-----------|--|
| 000001-04 | STANDARDS SYMBOLS, ABBREVIATIONS AND PATTERNS                              |
| 702001-06 | TRAFFIC CONTROL DEVICES  |
| 701306-01 | LANE CLOSURE, 2L, 2W, SLOW MOVING OPERATIONS DAY ONLY, FOR SPEEDS ≥ 45 MPH |
| BLR 24-1  | MAILBOX TURNOUT FOR LOCAL ROADS  |
| 701301-02 | LANE CLOSURE, 2L, 2W, SHORT TIME OPERATIONS                                |

**UTILITIES**

- NORRIS ELECTRIC CO-OP  
ROUTE 130 SOUTH  
NEWTON, ILLINOIS 62448
- MARATHON PIPELINE COMPANY  
P.O. BOX F  
MARTINSVILLE, ILLINOIS 62442
- ILLINOIS CONSOLIDATED TELEPHONE COMPANY  
121 SOUTH 17TH STREET  
MATTOON, ILLINOIS 61938

DESIGN FUNCTIONAL CLASSIFICATION: RURAL MAJOR COLLECTOR  
DESIGN TRAFFIC: 350 ADT  
DESIGN SPEED: 40 M.P.H.

CONTRACT NO. 95487

PLAN 0' = 50'  
PROFILE HORIZ. 0' = 50'  
PROFILE VERT. 0' = 5'  
CROSS SECTIONS 0' = 5'

**F.A.S. 696  
PROJECT RS-696(106)  
SECTION 08-00262-00-RS  
CLARK COUNTY  
C-97-146-06**

R. 13 W., 2nd P.M.

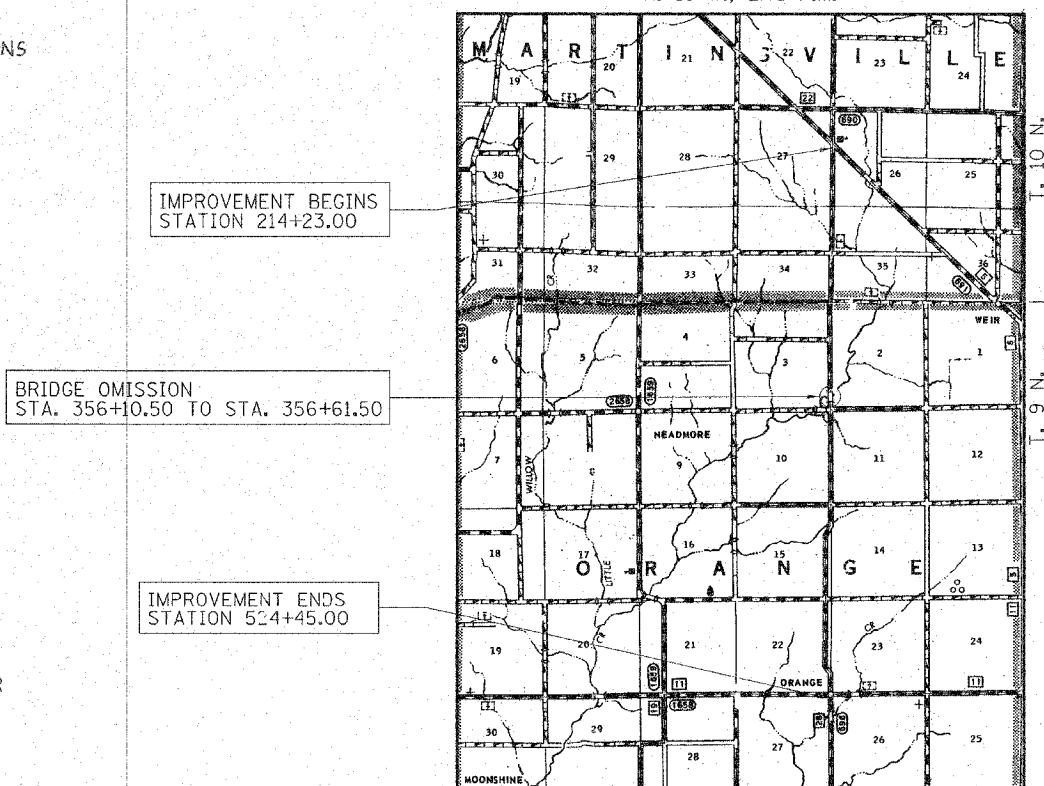

**LAYOUT**

APPROXIMATE SCALE: 0 1 MILE  
TOTAL LENGTH OF SECTION = 31022 FEET = 5.8753 MILES  
NET LENGTH OF SECTION = 30971 FEET = 5.8657 MILES

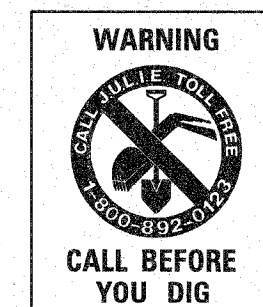

APPROVED	12-13 2006
	<i>Jaquie E. Ward</i> COUNTY ENGINEER
PASSED	1/4 2006
	<i>Maurice Kaehl</i> DISTRICT SEVEN ENGINEER OF LOCAL ROADS & STREETS
Releasing For Bid Based on Limited Review	1/4 2006
	<i>Christie M. Reed</i> DEPUTY DIRECTOR OF HIGHWAYS, REGION FOUR ENGINEER
STATE OF ILLINOIS DEPARTMENT OF TRANSPORTATION	

DATE: 12/12/2006

BY: *Louis F. Stauder*

LICENSE EXPIRES: NOVEMBER 30, 2007

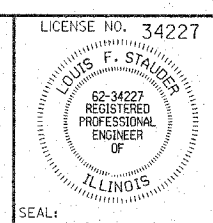

**HAMPTON, LENZINI & RENWICK, INC.**  
CIVIL & STRUCTURAL ENGINEERS

3085 STEVENS ON DRIVE, SUITE 201  
SPRINGFIELD, ILLINOIS 62703  
(217) 546-3400

ELGIN • SPRINGFIELD

PROJECT NUMBER: 03-23-0007-1 DATE: 09/08/06