

W. 1/2, N.W. 1/4, SEC. 2, T.9N., R.13W., 2ND PM.
 WILLIAM HILLS ET. AL.

ROUTE NO.	SECTION	COUNTY	TOTAL SHEETS	SHEET NO.
F.A.S. 696	08-00262 -00-RS	CLARK	27	12
FED. ROAD DIST. NO. 7	ILLINOIS	PROJECT	RS-696(106)	

CONTRACT NO. 95487

BETTY HILLS C/O
 JANICE MASUGA

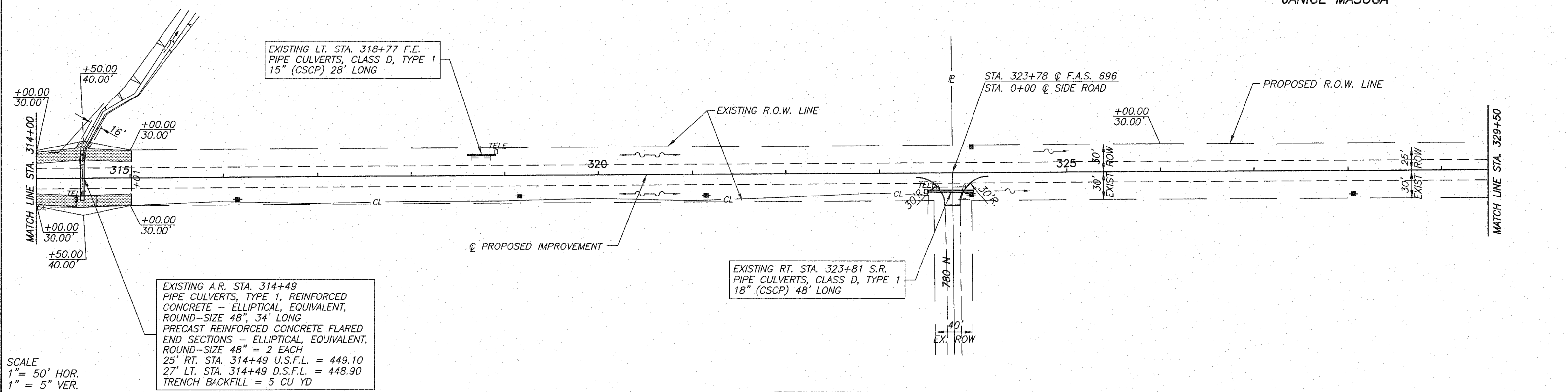

JOAN BENNETT
 E. 1/2, N.E. 1/4, SEC. 3, T.9N., R.13W., 2ND PM.

INDICATES STONE RIPRAP DITCH (EXISTING)

JOAN BENNETT

