

N.W. 1/4, S.W. 1/4, SEC 11, T.9N., R.13W., 2ND PM.
LARRY MACEY

| ROUTE NO. | SECTION | COUNTY | TOTAL SHEETS | SHEET NO. |
|-----------------------|----------------|----------|--------------|-------------|
| F.A.S. 896 | 08-00262-00-RS | CLARK | 27 | 17 |
| FED. ROAD DIST. NO. 7 | | ILLINOIS | PROJECT | RS-896(106) |

CONTRACT NO. 95487

PATRICIA BENNETT

PI STA=404+45.93
Δ = 0°06'32" R
NO CURVE

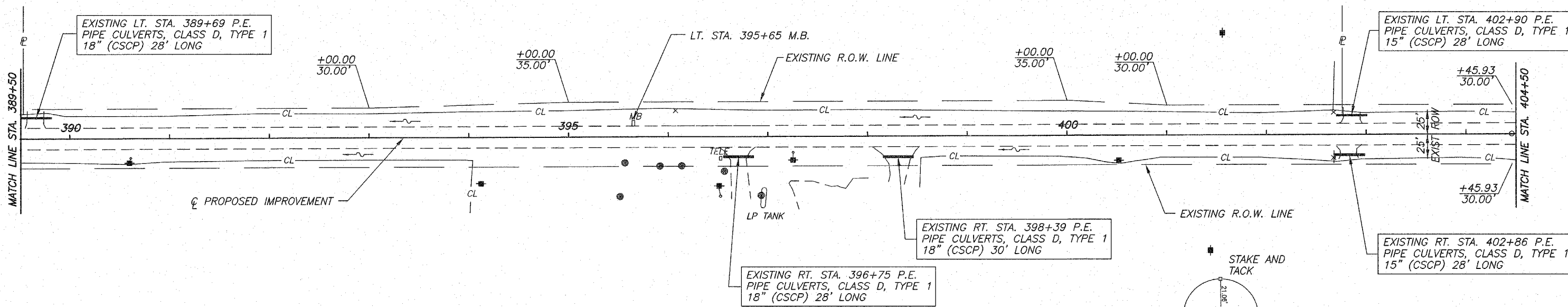

SCALES:
1" = 50' HOR.
1" = 5' VER.

LARRY J. MACEY

E. 1/2, S.E. 1/4, SEC 10, T.9N., R.13W., 2ND PM.

P.I. STA. 404+45.93
IRON PIN (FLUSH)

BM. #27, 2 SPIKE NAILS IN P.P.
27' RT. STA. 400+52
ELEV. 457.50

