

STATE OF ILLINOIS DEPARTMENT OF TRANSPORTATION DIVISION OF HIGHWAYS PLANS FOR PROPOSED HIGHWAY BRIDGE PROGRAM

ROUTE NO.	SECTION	COUNTY	TOTAL SHEETS
T.R. 74	06-19116-00-BR	SHELBY	12
FED. ROAD DIST. NO.		ILLINOIS	FED. AID PROJECT
CONTRACT NO. 95499			

- INDEX OF SHEETS**
- COVER SHEET
 - SUMMARY OF QUANTITIES AND TYPICAL SECTIONS
 - PLAN AND PROFILE
 - 4.-7. STATION CROSS SECTIONS
 - 8.-11 BRIDGE PLANS
 12. BORINGS

- HIGHWAY STANDARDS:**
- 000001-04 STANDARD SYMBOLS, ABBREVIATIONS, AND PATTERNS
 - 280001-03 TEMPORARY EROSION CONTROL SYSTEMS
 - 515001-02 NAME PLATE FOR BRIDGES
 - 635006-02 REFLECTOR AND TERMINAL MARKER PLACEMENT
 - 702001-06 TRAFFIC CONTROL DEVICES
 - BLR 21-6 TYPICAL APPLICATION OF TRAFFIC CONTROL DEVICES FOR CONSTRUCTION ON RURAL LOCAL HIGHWAYS
 - BLR 24-1 MAILBOX TURNOUT FOR LOCAL ROADS

UTILITIES

CONSOLIDATED COMMUNICATIONS
121 SOUTH 17TH STREET
MATTOON, ILLINOIS 61938
217-235-3311

SHELBY ELECTRIC COOPERATIVE
P.O. BOX 560
SHELBYVILLE, ILLINOIS 62565
217-774-3330

DESIGN FUNCTIONAL CLASSIFICATION:
LOCAL ROAD 0-250 ADT
DESIGN TRAFFIC: 150 ADT
DESIGN SPEED: 30 M.P.H.

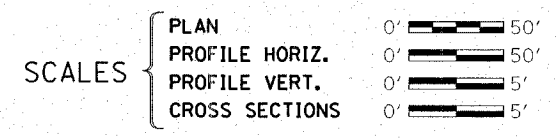

PROJECT BROS-173(147) SECTION 06-19116-00-BR RURAL ROAD DISTRICT SHELBY COUNTY T.R. 74 C-97-033-07

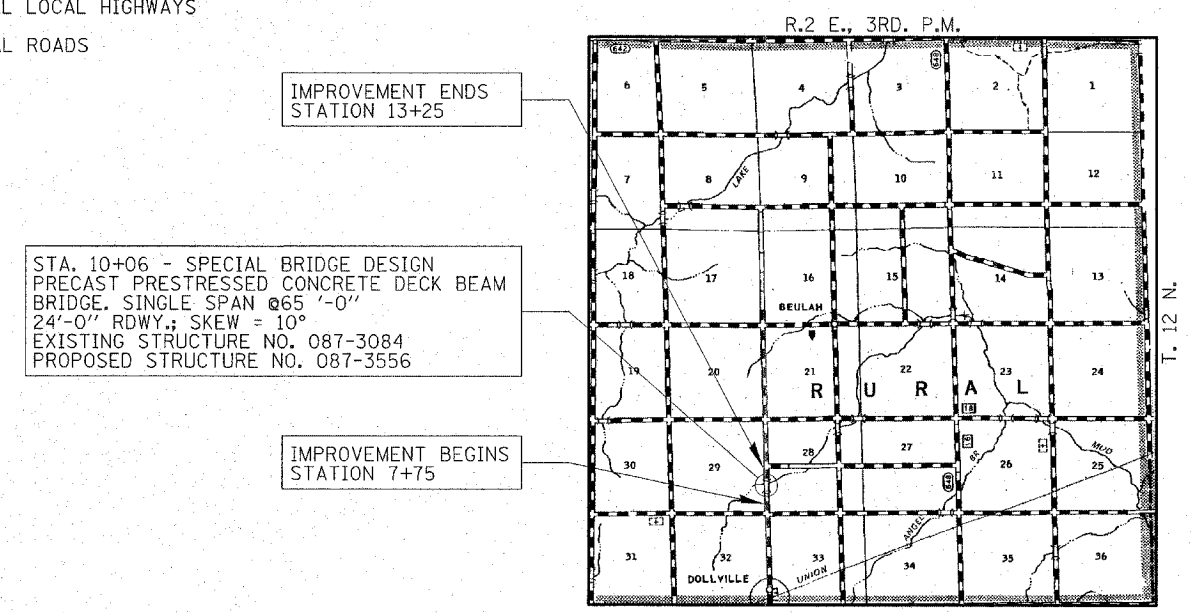
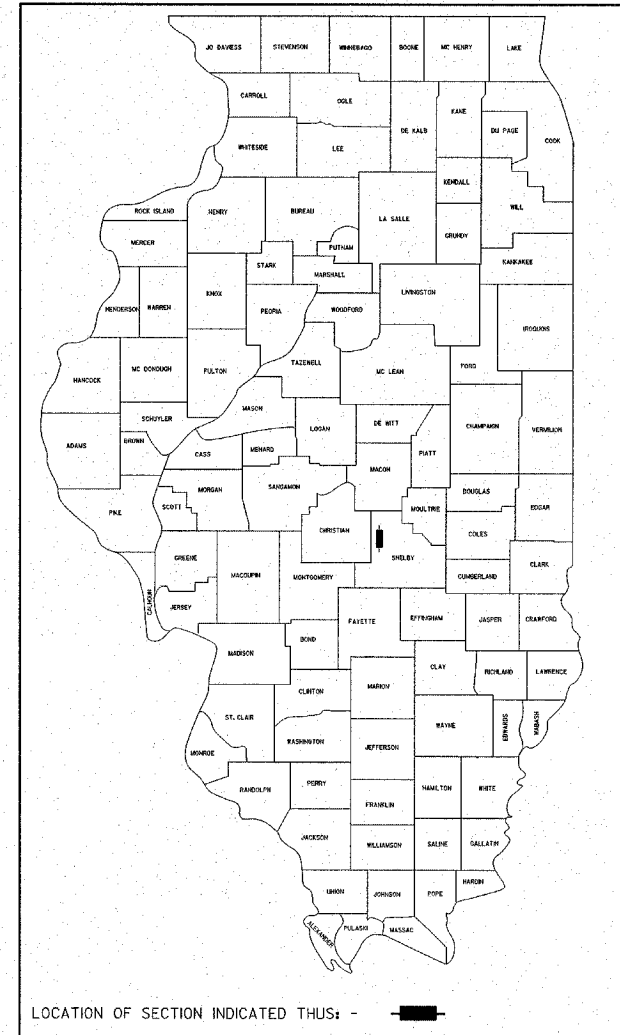

LAYOUT

APPROXIMATE SCALE: 0 1 MILE

NET LENGTH OF SECTION = 550 FEET = 0.104 MILES

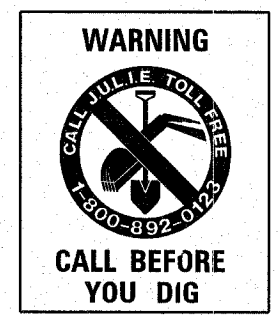

APPROVED *[Signature]* 12-18-06 20 06
SHELBY COUNTY ENGINEER

APPROVED *[Signature]* 12-19-06 20 06
RURAL ROAD DISTRICT COMMISSIONER

PASSED *[Signature]* 1/5 20 07
DISTRICT SEVEN ENGINEER OF LOCAL ROADS & STREETS

Releasing For Bid Based on Limited Review *[Signature]* 1/5 20 07
DEPUTY DIRECTOR OF HIGHWAYS
REGION FOUR ENGINEER
STATE OF ILLINOIS
DEPARTMENT OF TRANSPORTATION

DATE: 12-18-06

BY: *[Signature]*

LICENSE EXPIRES: NOVEMBER 30, 2007

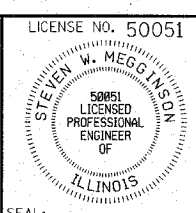

HAMPTON, LENZINI & RENWICK, INC.
CIVIL & STRUCTURAL ENGINEERS

HLR

3085 STEVENSON DRIVE, SUITE 20
SPRINGFIELD, ILLINOIS 62703
(217) 546-3400

ELGIN • SPRINGFIELD

PROJECT NUMBER: 12-87-0017-1 | DATE: 12/18/06