

F.A. RTE.	SECTION	COUNTY	TOTAL SHEETS	SHEET NO.
*	**	WILLIAMSON	917	130A

STA. TO STA.  
 FED. ROAD DIST. NO. ILLINOIS FED. AID PROJECT  
 \* I-57, & OLD IL 13 (FAU 9629)  
 \*\* (X1-6-2)VB-2,(X1-6)HBK-2

# DETOUR PLAN: RAMP FF CLOSED

FOR I-57 STAGE 3

LEGEND	
	PROPOSED SIGN
	EXISTING SIGN
	TRAFFIC FLOW
	CHANGEABLE MESSAGE SIGN
	CLOSED RAMP
	EXISTING SIGN

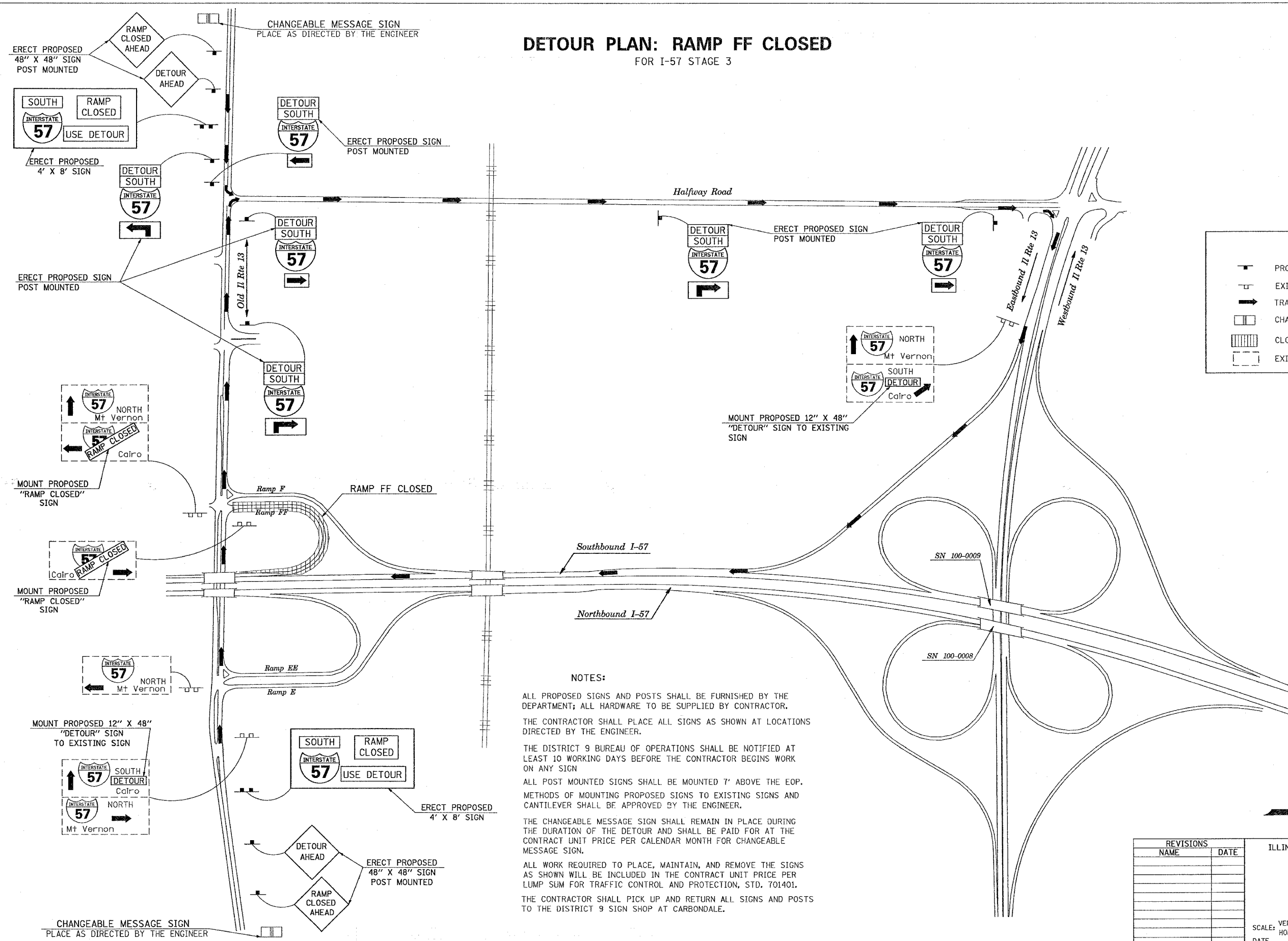

**NOTES:**

ALL PROPOSED SIGNS AND POSTS SHALL BE FURNISHED BY THE DEPARTMENT; ALL HARDWARE TO BE SUPPLIED BY CONTRACTOR.

THE CONTRACTOR SHALL PLACE ALL SIGNS AS SHOWN AT LOCATIONS DIRECTED BY THE ENGINEER.

THE DISTRICT 9 BUREAU OF OPERATIONS SHALL BE NOTIFIED AT LEAST 10 WORKING DAYS BEFORE THE CONTRACTOR BEGINS WORK ON ANY SIGN

ALL POST MOUNTED SIGNS SHALL BE MOUNTED 7' ABOVE THE EOP. METHODS OF MOUNTING PROPOSED SIGNS TO EXISTING SIGNS AND CANTILEVER SHALL BE APPROVED BY THE ENGINEER.

THE CHANGEABLE MESSAGE SIGN SHALL REMAIN IN PLACE DURING THE DURATION OF THE DETOUR AND SHALL BE PAID FOR AT THE CONTRACT UNIT PRICE PER CALENDAR MONTH FOR CHANGEABLE MESSAGE SIGN.

ALL WORK REQUIRED TO PLACE, MAINTAIN, AND REMOVE THE SIGNS AS SHOWN WILL BE INCLUDED IN THE CONTRACT UNIT PRICE PER LUMP SUM FOR TRAFFIC CONTROL AND PROTECTION, STD. 701401.

THE CONTRACTOR SHALL PICK UP AND RETURN ALL SIGNS AND POSTS TO THE DISTRICT 9 SIGN SHOP AT CARBONDALE.



REVISIONS	
NAME	DATE

ILLINOIS DEPARTMENT OF TRANSPORTATION

## DETOUR PLAN

### RAMP FF CLOSED

FOR I-57 STAGE 3

SCALE: VERT. NONE  
 HORIZ. DATE

DRAWN BY CNH  
 CHECKED BY

PLOT DATE = 12/8/2006  
 FILE NAME = c:\p060606\98950\98950.dwg  
 USER = hweidm  
 PLOTTER = HPGL  
 PLOT SCALE = 1/8" = 1'-0"