

F.A. RTE.	SECTION	COUNTY	TOTAL SHEETS	SHEET NO.
**	**	WILLIAMSON	917	250
STA. 1513+50.0000 TO STA. 1513+66.4968				
FED. ROAD DIST. NO. ILLINOIS FED. AID PROJECT				
* I-57, & OLD IL 13 (FAD 9629)				
** (X1-6-2)VB-2,(X1-6)HBK-2				

DATE \_\_\_\_\_  
 BY \_\_\_\_\_  
 SURVEYED \_\_\_\_\_  
 PLOTTED \_\_\_\_\_  
 NOTE BOOK \_\_\_\_\_  
 AREA CHECKED \_\_\_\_\_  
 NO. \_\_\_\_\_

DATE \_\_\_\_\_  
 BY \_\_\_\_\_  
 ORIGINAL SURVEY \_\_\_\_\_  
 PLOTTED \_\_\_\_\_  
 NOTE BOOK \_\_\_\_\_  
 AREA CHECKED \_\_\_\_\_  
 NO. \_\_\_\_\_

DATE 10/25/2006  
 FILE NAME 4902002\0103\1513+50.0000\1513+50.0000.dwg  
 PLOT SCALE 1/8"=1'-0"  
 USER NAME javender

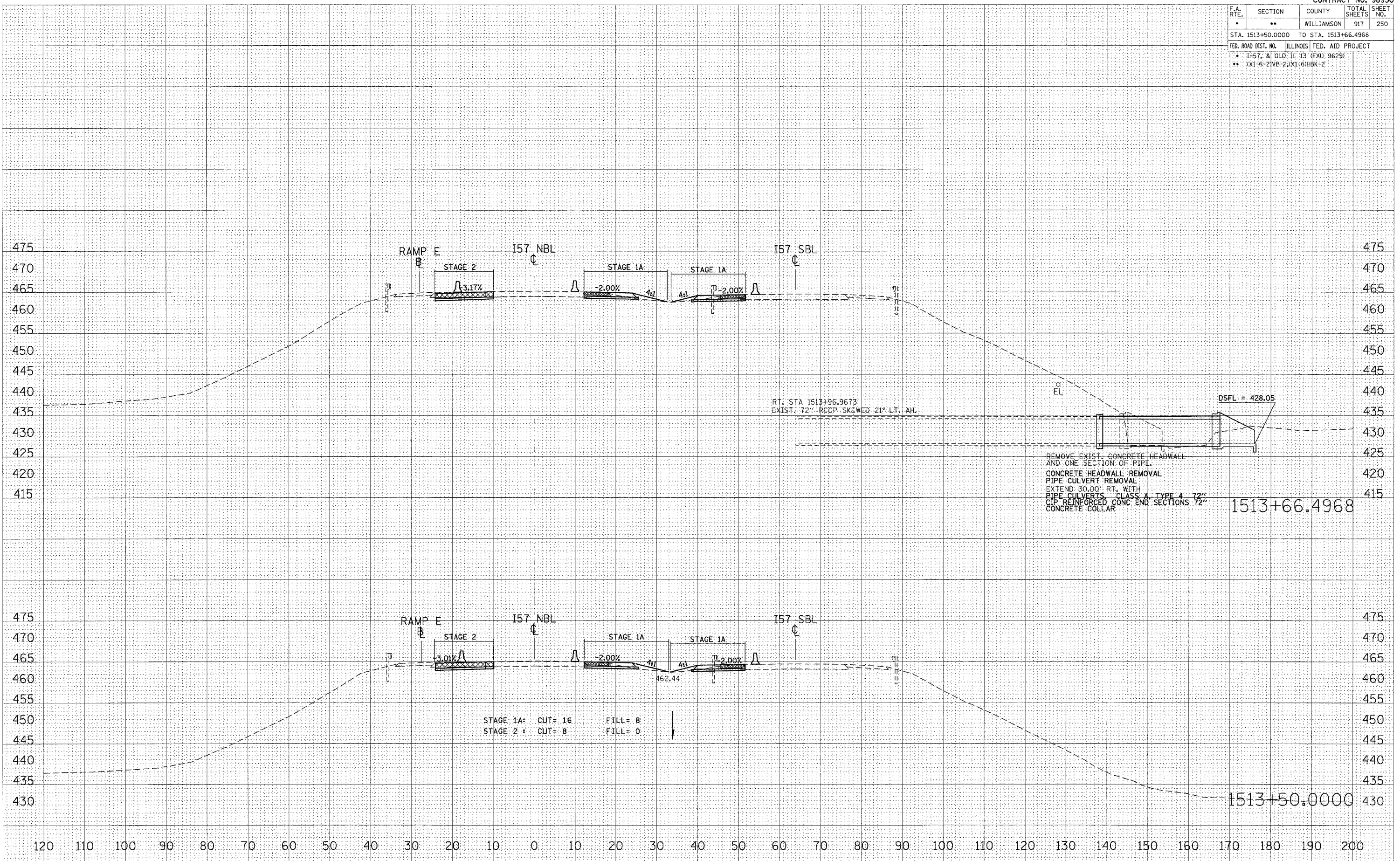

STAGE 1A: CUT= 16 FILL= 8  
 STAGE 2 : CUT= 8 FILL= 0

REMOVE EXIST. CONCRETE HEADWALL AND ONE SECTION OF PIPE.  
 CONCRETE HEADWALL REMOVAL  
 PIPE CULVERT REMOVAL  
 EXTEND 30.00' RT. WITH PIPE CULVERTS CLASS A TYPE 4 72" CIP REINFORCED CONC END SECTIONS 72" CONCRETE COLLAR

STA 1513+50.0000 TO STA 1513+66.4968 I57 NBL STAGES 1, 1A, 2, & 3