

F.A. RTE.	SECTION	COUNTY	TOTAL SHEETS	SHEET NO.
*	**	WILLIAMSON	917	327
STA. TO STA.				
FED. ROAD DIST. NO. ILLINOIS FED. AID PROJECT				
* I-57, & OLD IL 13 (FAU 9629)				
** (X1-6-2)VB-2,(X1-6)HKB-2				

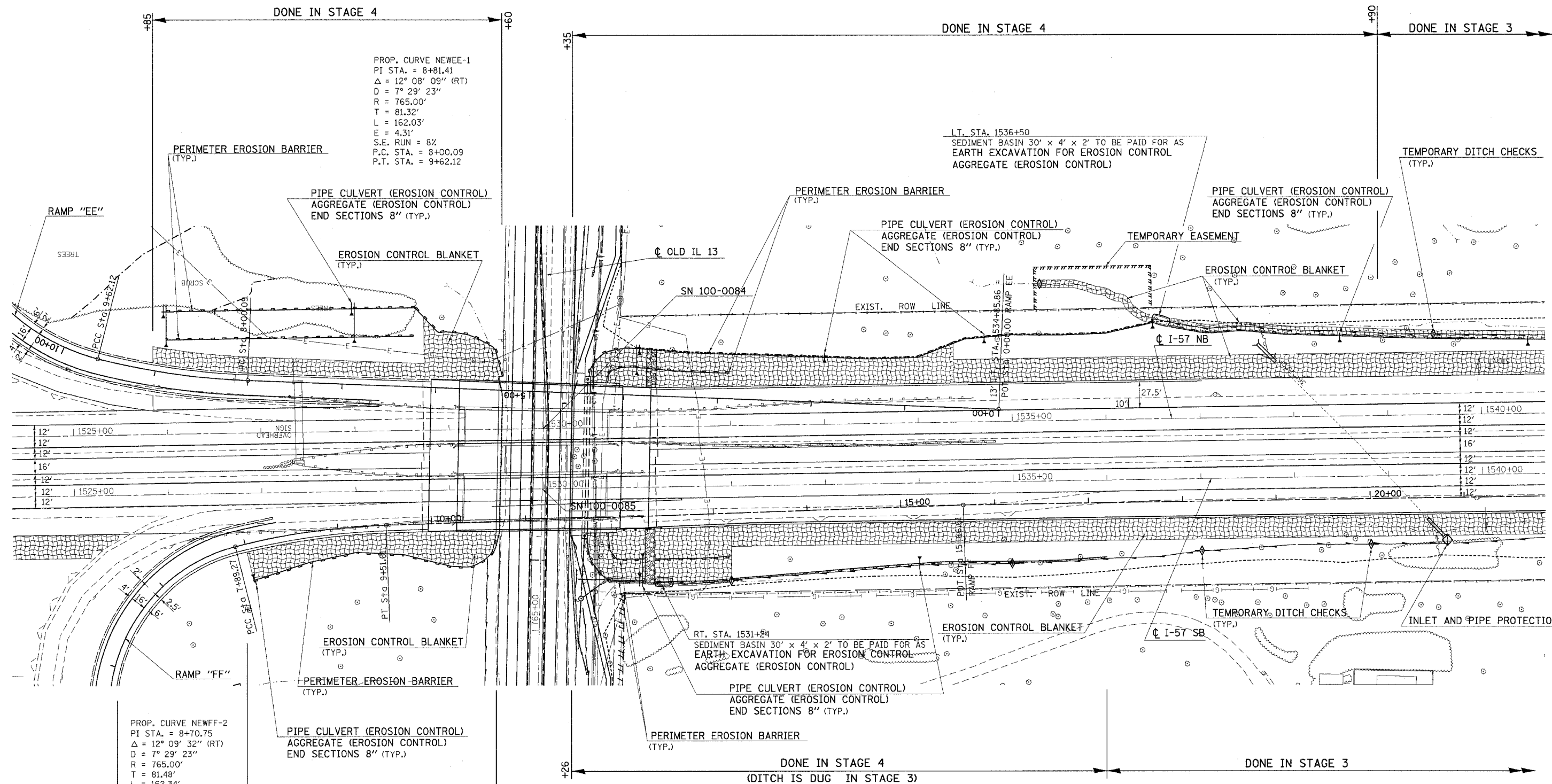
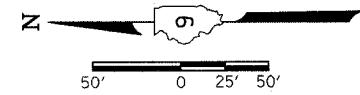

PROP. CURVE NEWEE-1
 PI STA. = 8+81.41
 $\Delta = 12^\circ 08' 09''$ (RT)
 $D = 7^\circ 29' 23''$
 $R = 765.00'$
 $T = 81.32'$
 $L = 162.03'$
 $E = 4.31'$
 $S.E. RUN = 8\%$
 P.C. STA. = 8+00.09
 P.T. STA. = 9+62.12

PROP. CURVE NEWFF-2
 PI STA. = 8+70.75
 $\Delta = 12^\circ 09' 32''$ (RT)
 $D = 7^\circ 29' 23''$
 $R = 765.00'$
 $T = 81.48'$
 $L = 162.34'$
 $E = 4.33'$
 $S.E. RUN = 8\%$
 P.C. STA. = 7+89.27
 P.T. STA. = 9+51.61

RT. STA. 1531+24
 SEDIMENT BASIN 30' x 4' x 2' TO BE PAID FOR AS
 EARTH EXCAVATION FOR EROSION CONTROL
 AGGREGATE (EROSION CONTROL)
 PIPE CULVERT (EROSION CONTROL)
 AGGREGATE (EROSION CONTROL)
 END SECTIONS 8" (TYP.)
 PERIMETER EROSION BARRIER
 (TYP.)

LT. STA. 1536+50
 SEDIMENT BASIN 30' x 4' x 2' TO BE PAID FOR AS
 EARTH EXCAVATION FOR EROSION CONTROL
 AGGREGATE (EROSION CONTROL)

PLOT DATE = 12/18/2006
 FILE NAME = c:\pcc\meta\3922882\vald13\vald13p.dgn
 PLOT SCALE = 50.0000 / 1" = 50'
 USER = MMS, PPT3
 APPAS, PPT3

REVISIONS	
NAME	DATE

ILLINOIS DEPARTMENT OF TRANSPORTATION
TEMPORARY EROSION CONTROL FAI-57 FOR STAGES 1, 2, 3, 4
STA. 1525+00 TO STA. 1540+00
 SHEET 1 OF 2
 SCALE: VERT. 50
 HORIZ. DATE
 DRAWN BY CNH
 CHECKED BY