

F.A. RTE.	SECTION	COUNTY	TOTAL SHEETS	SHEET NO.
*	**	WILLIAMSON	917	341
STA. 1520+00.0000 TO STA. 1520+50.0000				
FED. ROAD DIST. NO. ILLINOIS FED. AID PROJECT				
* I-57 & OLD IL 13 (FAU 9629)				
** (X1-6-2)VB-2,(X1-6)HBK-2				

DATE	
BY	
SURVEYED	
PLOTTED	
NOTE BOOK	
AREAS CHECKED	
NO.	

DATE	
BY	
SURVEYED	
PLOTTED	
NOTE BOOK	
AREAS CHECKED	
NO.	

PLOT DATE = 10/25/2006
 PLOT SCALE = 1/8" = 100'
 USER NAME = lavenderba

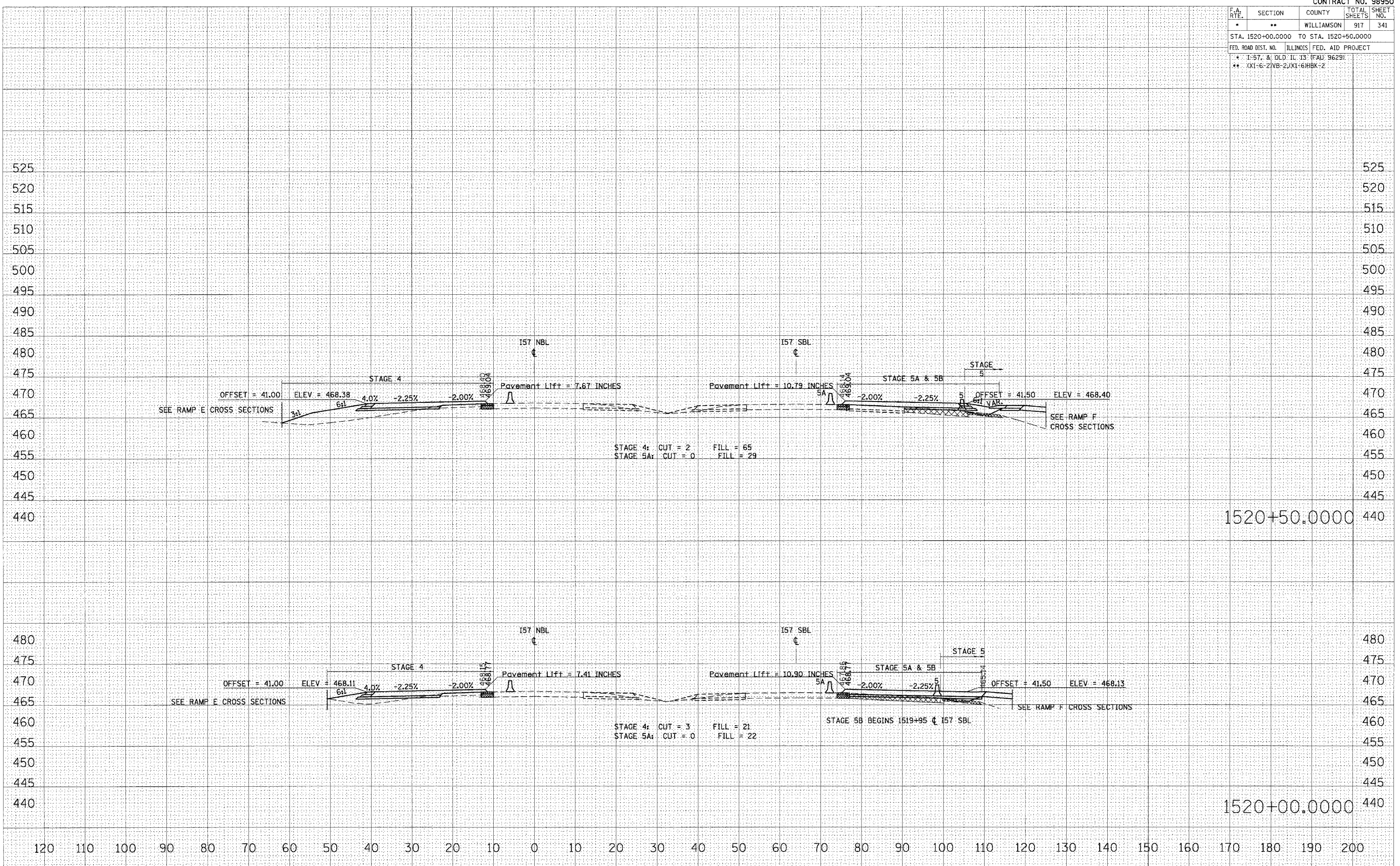

STA 1520+00.0000 TO STA 1520+50.0000 I57 NBL STAGE 4