

F.A. RTE.	SECTION	COUNTY	TOTAL SHEETS	SHEET NO.
•	**	WILLIAMSON	917	480
STA. 5+25.0000 TO STA. 5+75.0000				
FED. ROAD DIST. NO. ILLINOIS FED. AID PROJ. 480				
* 1-57, & OLD. IL. 13 (FAU 9629)				
** XX1-6-21VB-2, XI-6/HBK-2				

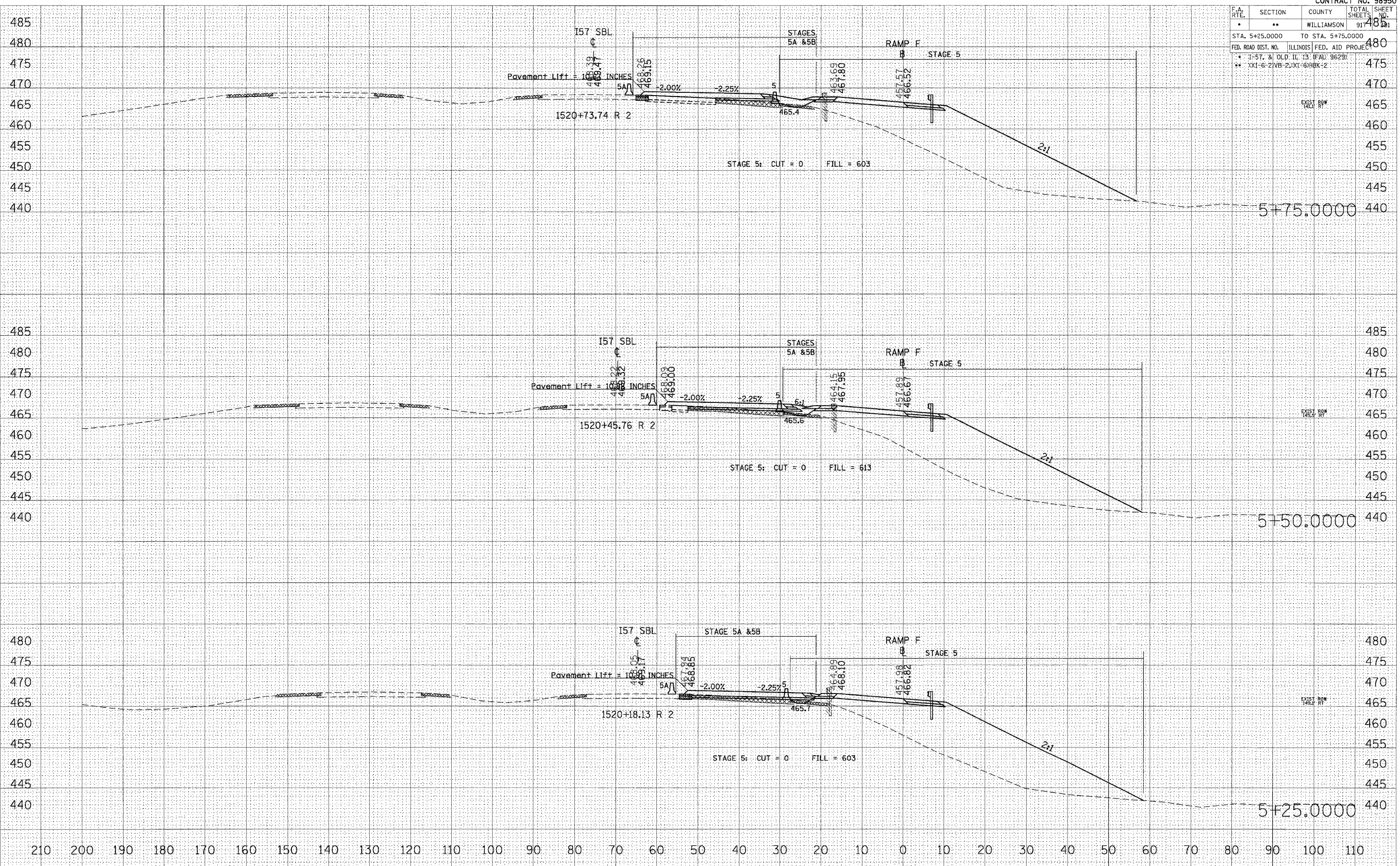

STA 5+25.0000 TO STA 5+75.0000 RAMP F

FINAL SURVEY NOTE BOOK NO. _____

DATE _____

BY _____

NO. _____

AREAS CHECKED _____

ORIGINAL SURVEY NOTE BOOK NO. _____

DATE _____

BY _____

NO. _____

AREAS CHECKED _____

PLOT DATE = 01/25/2006

FILE NAME = s:\projects\98950\sta5+25-75\p1\p1.dwg

PLOT SCALE = 1/8" = 10.0000' / IN.

USER NAME = lavenderba