

F.A. R.T.E.	SECTION	COUNTY	TOTAL SHEETS	SHEET NO.
*	**	WILLIAMSON	917	396
STA. 8+94.0745		TO STA. 9+25.0000		
FED. ROAD DIST. NO.		ILLINOIS	FED. AID PROJECT	
* I-57, & OLD IL 13 (FAU 9629)				
** (X1-6-2)VB-2,(X1-6)HBK-2				

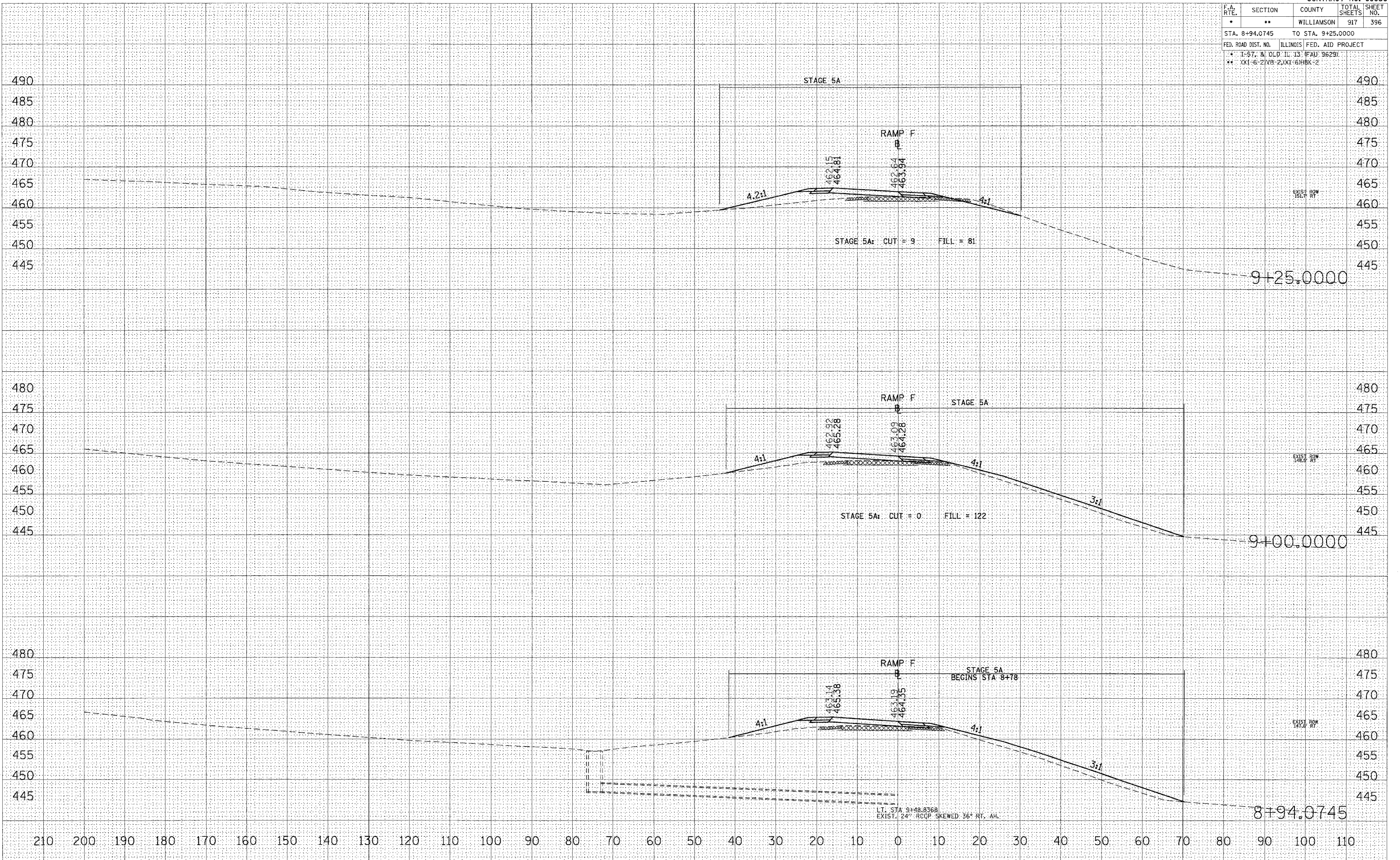

STA 8+94.0745 TO STA 9+25.0000 RAMP F

BY: _____ DATE: _____
 SURVEYED _____
 PLOTTED _____
 CHECKED _____
 AREAS CHECKED _____
 NO. _____

BY: _____ DATE: _____
 SURVEYED _____
 PLOTTED _____
 CHECKED _____
 AREAS CHECKED _____
 NO. _____

ORIGINAL SURVEYED _____
 PLOTTED _____
 CHECKED _____
 AREAS CHECKED _____
 NO. _____
 PLOT DATE = 10/26/2006
 FILE NAME = 10_26_06_10_26_06_10_26_06_10_26_06
 PLOT SCALE = 1/8" = 100'-0"
 USER NAME = jefwchd

LT. STA 9+18.8368
 EXIST. 24" RCQP SKEWED 36° RT. AH.